

BODY HARDWARE AND FITTINGS, TR2, TR3

DOOR HINGES, LATCHES, SIDE CURTAIN MOUNTINGS, TR2, TR3—Continued

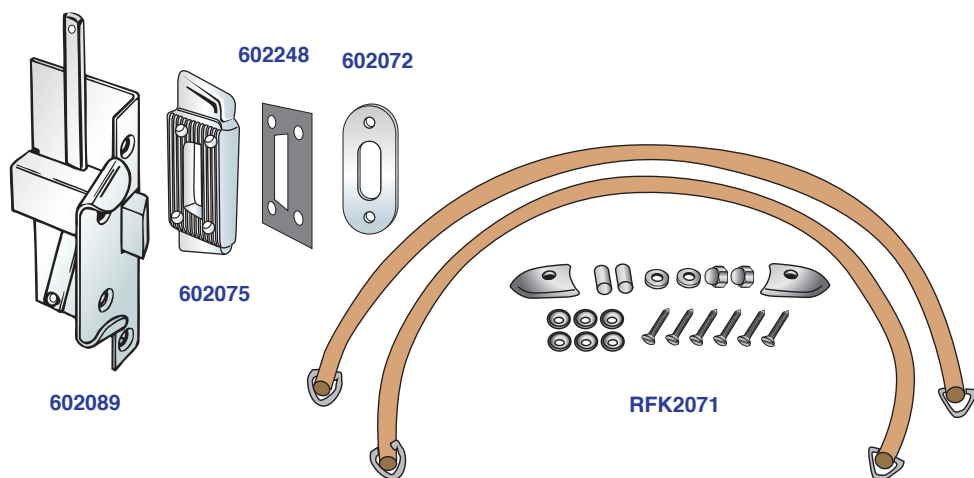

Part No.	Description	No. Off	List Price	Your Price
----------	-------------	---------	------------	------------

DOOR LATCHES, fitted up to comm. no.

TS22013

602089	Door Latch and Dovetail Assembly, LH	1		
602090	Door Latch and Dovetail Assembly, RH	1		
552397	Bolt , door latch levers	2		
552401	Spacer , door latch levers	2		
552396	Nut , dome, door latch levers	2		
500682	Screw , securing door latches to doors	8		
602075	Striker , door latch dovetail	2		
602248	Gasket , shim, door latch striker	A/R		
500166	Screw , securing door latch strikers to rear door post	8		

RFK2071	DOOR-PULL STRAP KIT , includes leather straps with metal end loops to be covered in vinyl or leather to match the car's interior, and attachment hardware, fitted up to comm. no. TS22013	1		
552227	Door-Pull Strap , leather, untrimmed but fitted with metal end loops	2		
602064	Finisher , end, door pull straps	2		
SP89C4/CP	Screw , securing finishers and straps to wooden door rail through trim panel	2		
552401	Spacer , on pivot bolts, door latch lever s	2		
552396	Nut , dome, door lock levers	2		

ITEMS NOT INCLUDED IN KIT LISTED ABOVE

552397	Bolt , door latch levers, not included in kit	2		
602072	Plate , finishing door pull slot in door trim panel	2		
500228	Screw , securing plates to doors	4		

Continued on Next Page

BODY HARDWARE AND FITTINGS, TR2, TR3

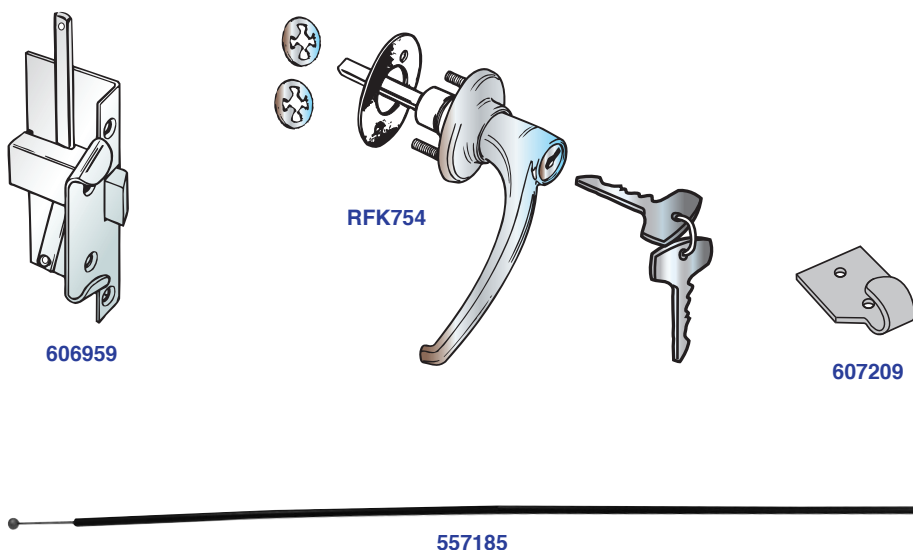
DOOR HINGES, LATCHES, SIDE CURTAIN
MOUNTINGS, TR2, TR3—Continued

Part No.	Description	No.Off	List Price	Your Price
DOOR LATCHES WITH OUTSIDE HANDLES,				
	fitted after comm. no. TS22013			
606959	Door Latch and Dovetail Assembly, LH	1		
606960	Door Latch and Dovetail Assembly, RH	1		
606974	Spring , tension, door latch levers	2		
607500	Link , door latch, LH	1		
607501	Link , door latch, RH	1		
RFK754	OUTSIDE DOOR HANDLE KIT , one pair of handles with matching keys	1		
604991	Handle , door, outside, supplied with lock and keys	2		
554355	Gasket , door handle	2		
	HARDWARE , securing handles to doors			
WP5	Washer , plain	4		
WL205	Washer , lock	4		
HN2005	Nut , hex	4		
650087	Tube , support on door handle shaft	2		
607009	Clip , securing door latch links and support tubes to handle shaft	2		
557185	Cable Assembly , door pull, operating door latches from inside the car	2		
607499	Bolt , securing cable to door latch levers	2		
607209	Bracket , cable guide, riveted inside door trim panels	2		

Continued on Next Page

BODY HARDWARE AND FITTINGS, TR2, TR3

DOOR HINGES, LATCHES, SIDE CURTAIN MOUNTINGS, TR2, TR3—Continued

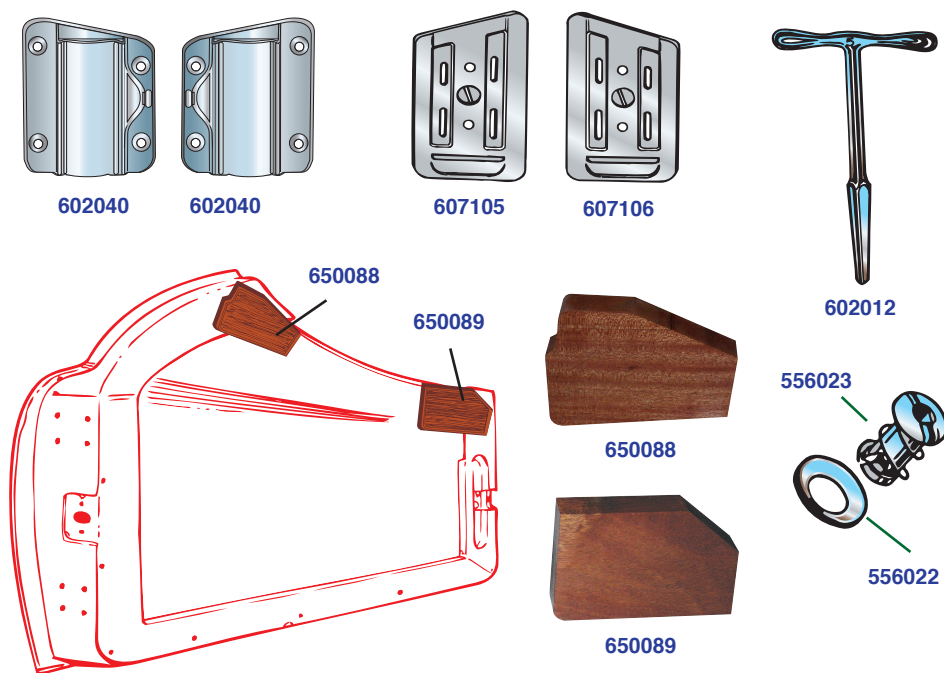

Part No.	Description	No.Off	List Price	Your Price
----------	-------------	--------	------------	------------

SIDE CURTAIN MOUNTING BRACKETS,

fitted up to comm. no. TS28825, “wedge”
mounting side curtains

602041	Bracket , chromed, LH front and RH rear	2		
602040	Bracket , chromed, RH front and LH rear	2		
SP89/E4	Screw , securing brackets to doors	16		

SIDE CURTAIN MOUNTING BRACKETS,

fitted after comm. no. TS28825, for Dzus
type side curtains

607105	Bracket , painted correct colour, LH front and RH rear	2		
607106	Bracket , painted correct colour, RH front and LH rear	2		
SP88/H7	Screw , Securing brackets to doors	16		
650088	Wood Block , side curtain mounting (inside doors), front, fitted after comm. no. TS28825	2		
650089	Wood Block , side curtain mounting (inside doors”, rear, fitted after comm. no. TS28825	2		
556023	Dzus Fastener , with spring, securing side curtains	4		
556022	Washer , retaining Dzus fastener	4		
602012	T-handle , operating Dzus fasteners	1		

BODY HARDWARE AND FITTINGS, TR2, TR3

TRUNK LID HARDWARE AND FITTINGS, TR2, TR3

The early hinges painted in body colour, fitted up to comm. no. TS8636 are not included at this time. TRF's hinges are manufactured with stainless steel pins and rivets to avoid rust staining experienced with original factory hinges...

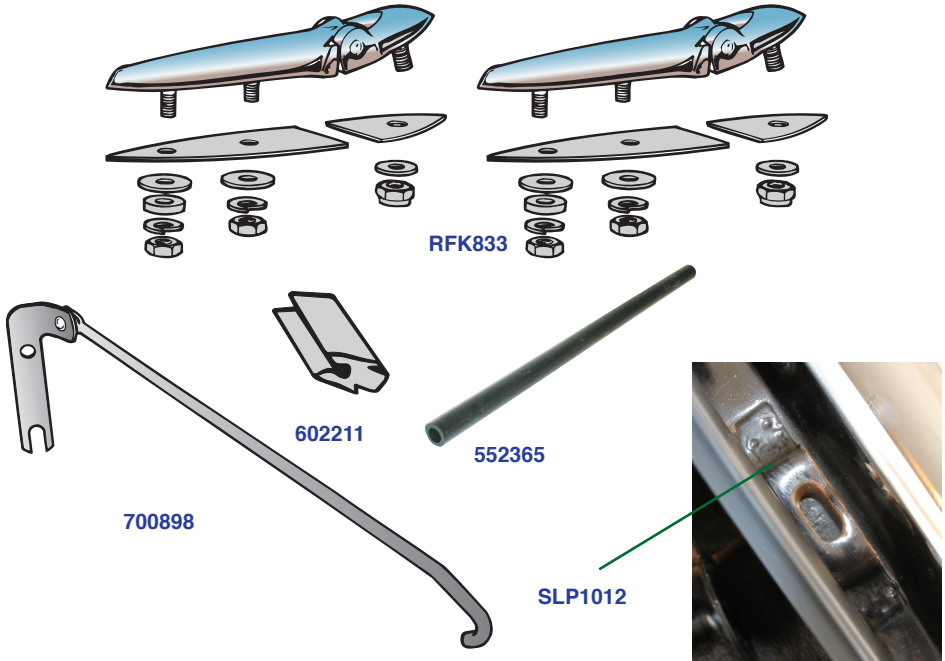

Part No.	Description	No.Off	List Price	Your Price
RFK833	TRUNK LID HINGE KIT , chromed, includes hinges, studs, gaskets, and additional hardware, fitted after comm. no. TS4229	1		
650024	Hinge , with studs, bonnet, chromed, LH	1		
650023	Hinge , with studs, bonnet, chromed, RH	1		
602222	Gasket , long end of hinge	A/R		
602223	Gasket , short end of hinge	A/R		
	HARDWARE , securing hinges to bonnet and to scuttle panel			
HN2007	Nut , securing hinges to bonnet	4		
WE607	Washer , shakeproof, under nuts	4		
HN2008	Nut , securing hinges to scuttle panel	4		
WE608	Washer , shakeproof, under nuts	4		
	TRUNK LID PROP ROD DETAILS			
700898	Prop Rod Assembly , with pivot bracket	1		
602211	Retainer , rubber, prop rod stowage	1		
PC55	Pin , split, securing retainer to trunk lid	1		
SLP1012	Bracket , prop rod engagement, welded to RH gutter	1	NLS	
552365	Tube , drain, located at rear corners of trunk opening	2		

Continued on Next Page

BODY HARDWARE AND FITTINGS, TR2, TR3

TRUNK LID HARDWARE AND FITTINGS, TR2, TR3 —Continued

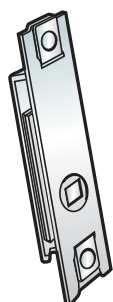

602216



CD22284

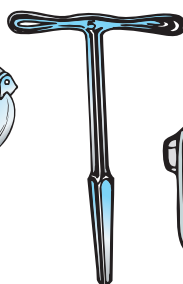

602012

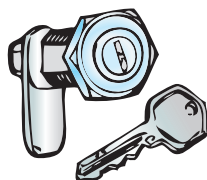

SLP289

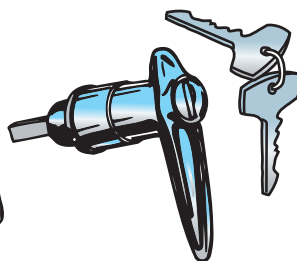

607070

Part No.	Description	No.Off	List Price	Your Price
----------	-------------	--------	------------	------------

TRUNK LID LATCHES, fitted up to comm. no. TS22012

602217	Latch , budget, LH latch	1		
602216	Latch , budget, RH latch	1		
TK4504P	Screw , securing budget locks to trunk lid	4		
CD22284	Escutcheon , chromed, trunk lid latches, with tear-drop cover	2		
SP86CO/CP	Screw , securing escutcheons to trunk lid	4		
602012	Coach Key , operating budget locks	1		
SLP289	Lock , trunk lid, supplied with two keys	1		

TRUNK LID LOCKING HANDLE, fitted after comm. no. TS22012

607070	Locking Handle , supplied with two keys	1		
DC11B	Gasket , locking handle, also supplied with a new handle	1		
602217	Latch , budget, operated by locking handle	1		
559419	Screw , securing locking handle to trunk lid	2		



William Carter's TR3A

BODY HARDWARE AND FITTINGS, TR2, TR3

SPARE WHEEL COMPARTMENT LID AND FITTINGS, TR2, TR3

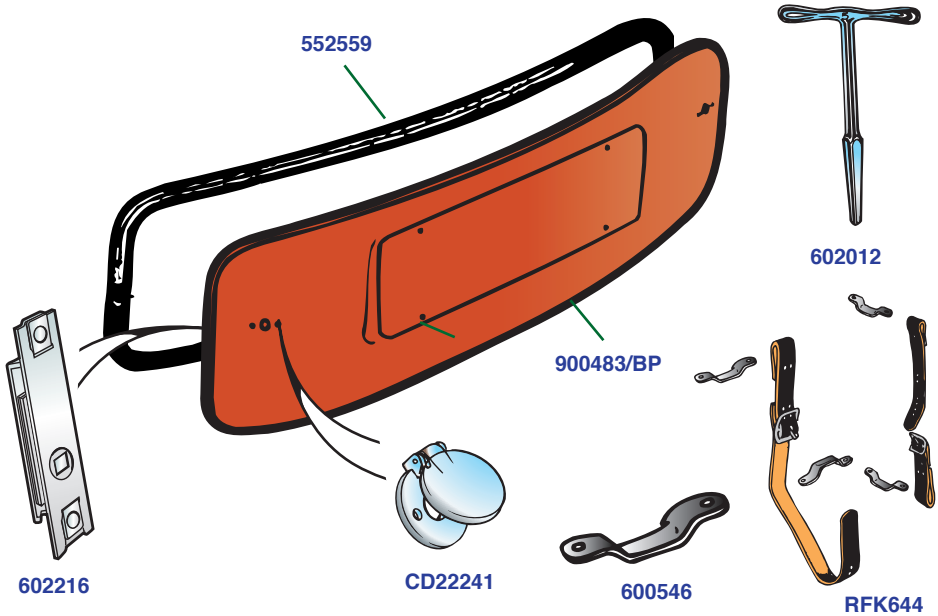

Part No.	Description	No.Off	List Price	Your Price
900483/BP	Spare Tire Lid Assembly	1		
552559	Spare Tire Lid Seal	1		
602216	Latch , budget, spare tire lid, LH	1		
602217	Latch , budget, spare tire lid, RH	1		
TK4504P	Screw , securing latches to spare wheel lid	4		
CD22241	Escutcheon , chromed, spare wheel latches, with round cover	2		
602012	Coach Key , operating budget latches	1		
TOOL AND TIRE STOWAGE STRAPS;				
straps as original with correct buckles, along with mounting hardware				
RFK643	TOOL AND TIRE STRAP KIT , fitted up to comm. no. TS60000	1		
RFK644	TOOL AND TIRE STRAP KIT , fitted after comm. no. TS60000	1		
600546	Staple , anchoring tool and tire straps	4		
HARDWARE , securing staples to body shell, quantities may vary from what we list				
PT504	Screw	8		
WN705	Washer , shakeproof	8		
HN2005	Nut , hex	8		

[ask ARR to change hardware quantities in the two kits above. I am varying from the parts catalogue to account for contingencies]

BODY HARDWARE AND FITTINGS, TR2, TR3

WINDSCREEN HARDWARE AND FITTINGS, INTERIOR MIRRORS, TR2, TR3

The listings in the factory spare parts catalogue appear to be complicated, but it boils down to chrome plated brass frame and stanchions or polished aluminium frame and stanchions. Chrome plated stanchions and frame were specified for fitting with Dzus fasteners up to comm. no. TS60000, and either chrome stanchions and frames or polished aluminium frames with “bolt” attachments were fitted alternatively after TS60000, but our experience tells us that the chrome plated components are more common. Rubber windscreen seals are listed on page 140.

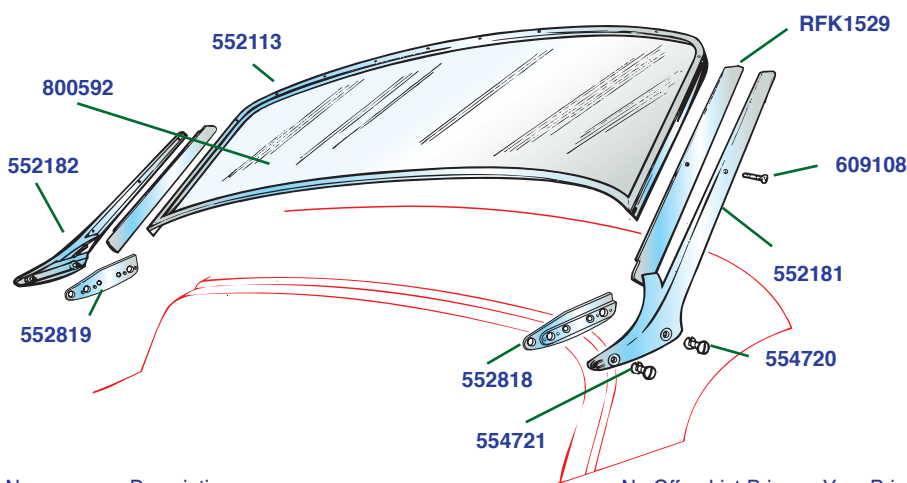

Part No.	Description	No.Off	List Price	Your Price
WINDSCREEN GLASS —TRF packs windcreens in wooden boxes for safe shipping				
800592/CL	Glass , windscreen, clear	1		
800592/TI	Glass , windscreen, tinted	1		
WINDSCREEN , chrome plated, Dzus attachments, fitted up to comm. no. TS60000				
552113	Frame Assembly , chrome plated	1		
552181	Stanchion , chromed, LH	1		
552182	Stanchion , chromed, RH	1		
WINDSCREEN , chrome plated, “bolt” attachments, fitted after comm. no. TS60000				
552113	Frame Assembly , chrome plated	1		
804511	Stanchion , chromed, LH	1		
804512	Stanchion , chromed, bolt	1		
WINDSCREEN , polished aluminium, “bolt” attachments, fitted after comm. no. TS60000 as an alternative to previous				
560670	Frame Assembly , polished aluminium	1		
560671	Stanchion , aluminium, LH	1		
560672	Stanchion , aluminium, RH	1		

Continued on Next Page

BODY HARDWARE AND FITTINGS, TR2, TR3

**WINDSCREEN HARDWARE AND FITTINGS, INTERIOR
MIRRORS, TR2, TR3—Continued**

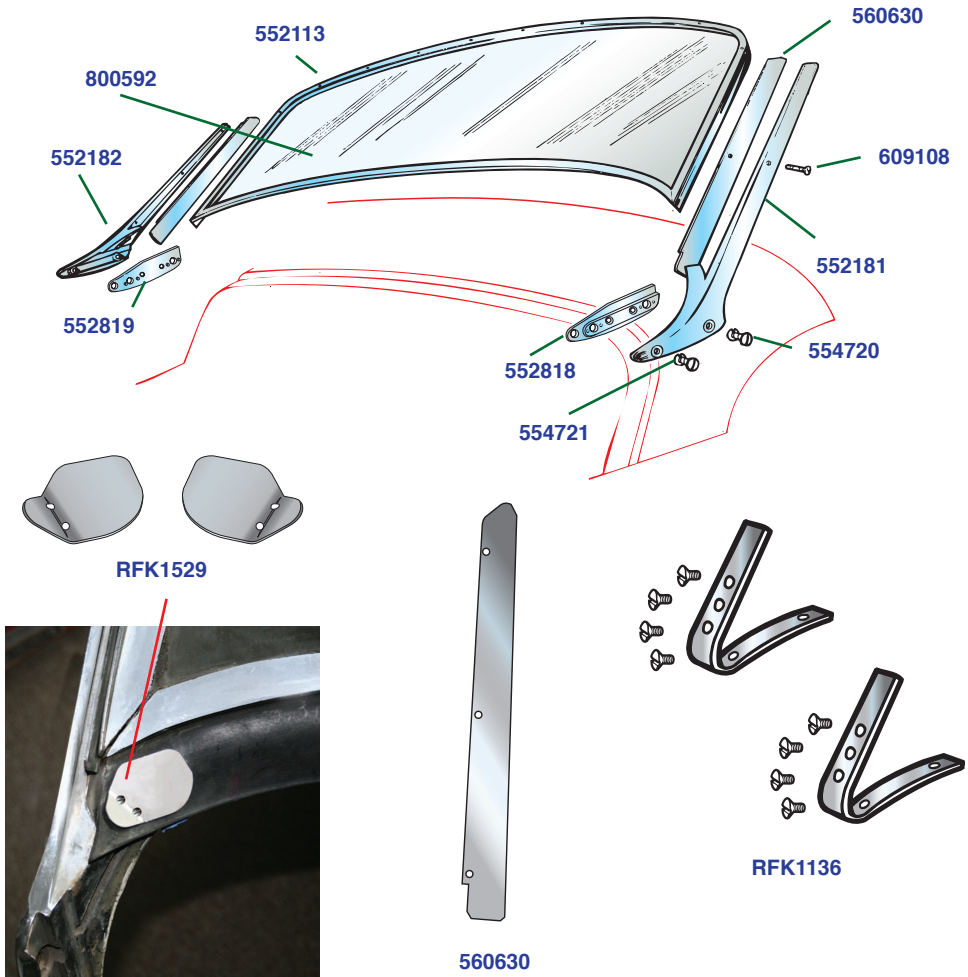

Part No.	Description	No.Off	List Price	Your Price
FITTINGS TO WINDSCREEN FRAME				
RFK1136	Corner Bracket Kit , including one pair of brackets for securing the bottom rail of the windscreen to the upper part, supplied with screws	1		
560630	Plate , chrome plated (Tenon Plates), fitted between windscreen frame and stanchions, providing abutments for the side curtains CHROMED SCREWS , securing stanchions and tenon plates to windscreen frame	2		
CD31441	Screw , slotted head, shorter	4		
552662	Screw , slotted head, longer	2		
RFK1529	Plate Kit , anchoring lower windscreen seal to stanchions, one pair of plates and attachment screws	1		

Continued on Next Page

BODY HARDWARE AND FITTINGS, TR2, TR3

WINDSCREEN HARDWARE AND FITTINGS, INTERIOR MIRRORS, TR2, TR3—Continued

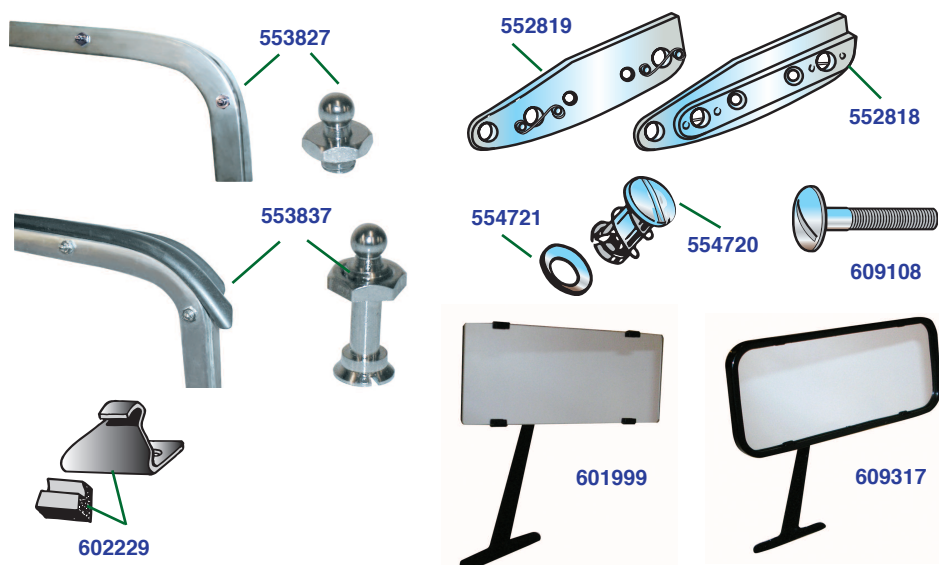

Part No.	Description	No.Off	List Price	Your Price
----------	-------------	--------	------------	------------

TENAX FASTENER PEGS, for securing convertible top

551866	Peg , “Baby” Tenax Fastener, as fitted up to comm. no. TS5513	10		
553827	Peg , Tenax Fasteners, fitted to chrome plated windscreen frames, after comm. no. TS60000	10		
553837	Peg , Tenax Fasteners, fitted to polished aluminium windscreen frames, after comm. no. TS60000	10		

DZUS FASTENERS, securing windscreen to body, fitted up to comm. no. TS60000

552818	Plate Assembly , stanchion attachment, LH	1		
552819	Plate Assembly , stanchion attachment, RH	1		
TK4708P	Screw , securing plates to scuttle	6		
554720	Dzus Fastener , with spring, securing windscreen to stanchion plates	4		
554721	Washer , retaining Dzus fastener	4		

CHROMED BOLTS, securing windscreen to body, fitted after comm. no. TS60000

609108	Bolt , chromed, slotted head	4		
--------	-------------------------------------	---	--	--

WINDSCREEN CENTER SUPPORT AND INTERIOR MIRRORS

602229	SUPPORT BRACKET , with buffer, fitted under interior mirror	1		
602246	Buffer , rubber, fitted in bracket	1		
601999	Interior Mirror , earlier type, without plastic edge bead	1		
609317	Interior Mirror , later type, with plastic edge bead	1		

BODY HARDWARE AND FITTINGS, TR2, TR3

CONVERTIBLE TOP FRAME AND FITTINGS, TR2, TR3

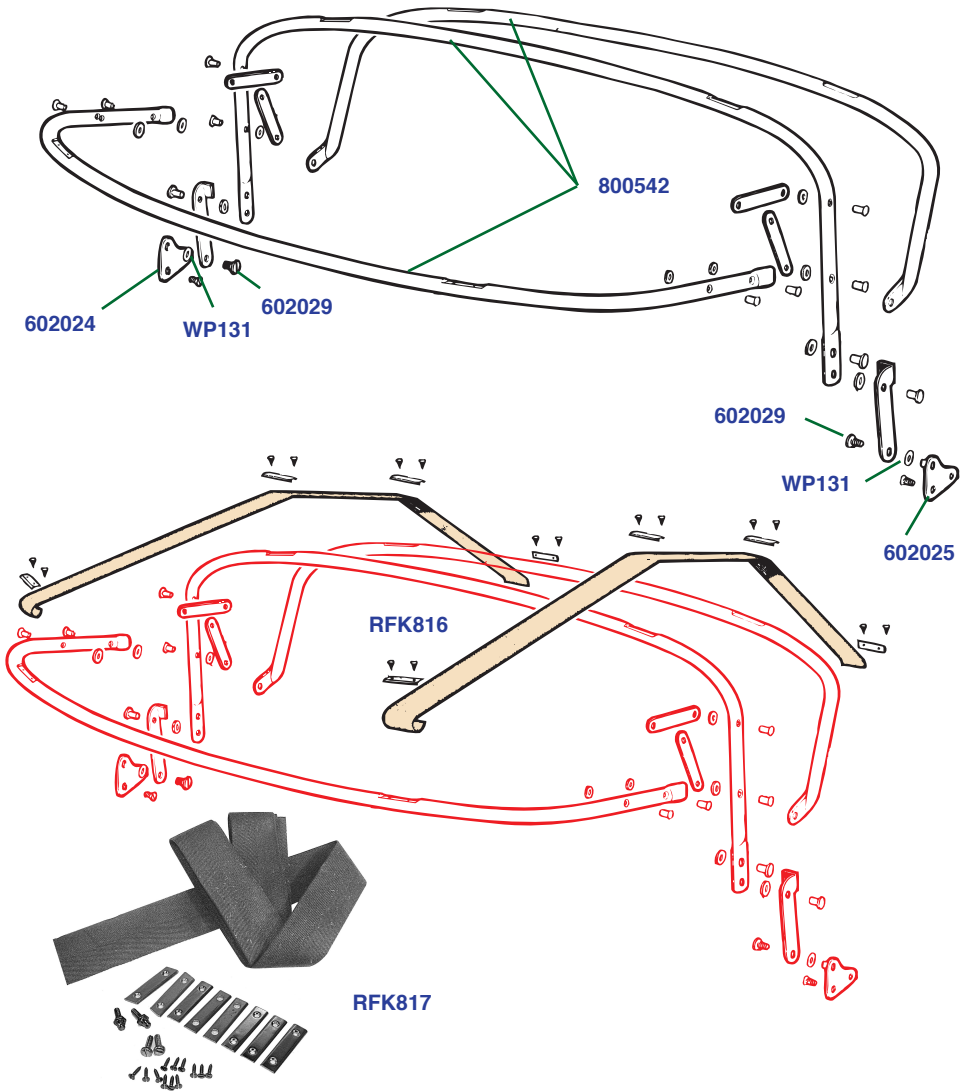

Part No.	Description	No.Off	List Price	Your Price
800542	Frame Assembly , soft top; does not include pivot brackets	1		
602024	Pivot Bracket , LH, bolts to body	1		
602025	Pivot Bracket , RH, bolts to body	1		
602029	Screw , slotted head, frame to pivot brackets	2		
WP131	Washer , plain, on screws	2		
	WEBBING KITS , include webbings, attachment plates, and screws			
RFK817	Webbing Kit , black webbings	1		
RFK816	Webbing Kit , natural fabric colour webbings, dye these in interior colours if you like	1		

Continued on Next Page

BODY HARDWARE AND FITTINGS, TR2, TR3

CONVERTIBLE TOP FRAME AND FITTINGS, TR2, TR3 — Continued

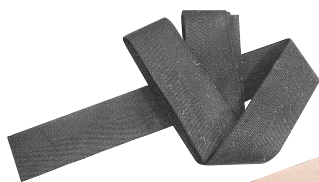

551864/BLK

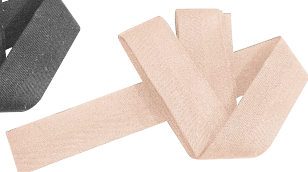

551864/TAN

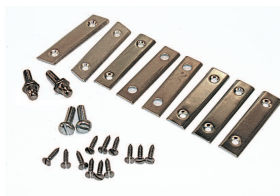

RFK350



552670

Part No.	Description	No.Off	List Price	Your Price
	WEBBINGS , no hardware			
551864/BLK	Webbing , black	1		
551864/TAN	Webbing , natural fabric colour, dye to match interior if you like	1		
RFK350	HARDWARE KIT , webbings	1		
602031	Plate , webbing, front stick, LH	1		
602032	Plate , webbing, front stick, RH	1		
602030	Plate , webbing, main and rear sticks	4		
YA163	Screw , securing plates to sticks	6		
602033	Plate , webbing to rear deck	2		
PT505	Screw , securing plates and webbings to rear deck	2		
552670	Stud , lift-the-dot, securing plates and webbings to rear deck	2		



BODY HARDWARE AND FITTINGS, TR2, TR3

HARD TOP MOUNTING HARDWARE AND FITTINGS, TR2, TR3

Rubber seals for the hard top are listed in the chapter on Rubber Body Seals and Gaskets. The mounting kit listed is usually available. Other components are listed for reference. Most part numbers are taken from the late Spare Parts Catalogue. It is worth referring to the information supplied in the workshop manual, although some part numbers vary there, but there are some useful drawings and photos.

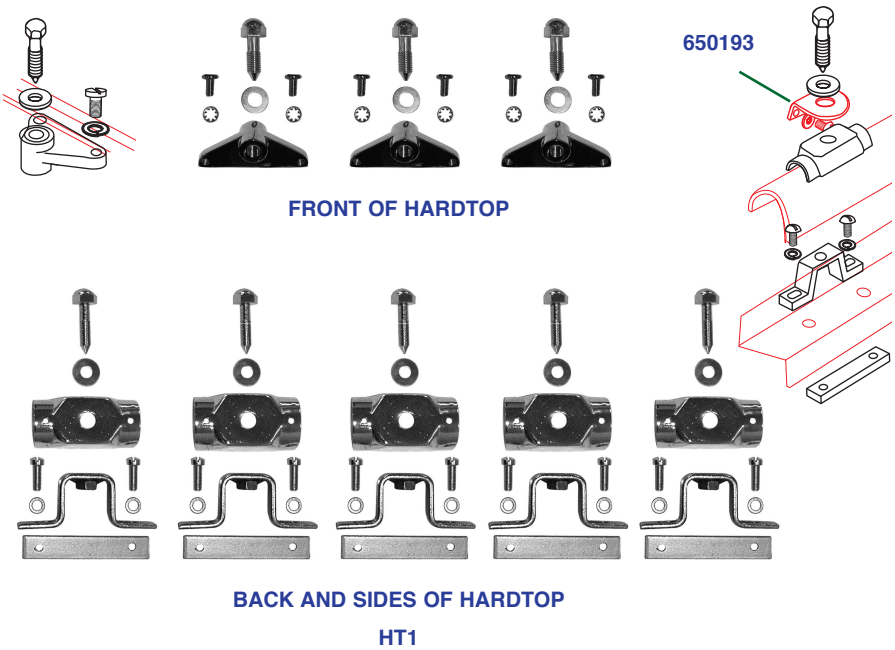

Part No.	Description	No.Off	List Price	Your Price
HT1	MOUNTING KIT , hard top	1		
	MOUNTINGS , hard top to windscreen frame			
603189	Bracket , chromed	3		
501434	Screw , securing brackets to windscreen frame	6		
602295	Screw , chromed, securing hard top to brackets	3		
602380	Washer , chromed, on screws	3		
	MOUNTINGS , rear of cockpit			
602236	Bracket , fitted under cockpit cappings	5		
602299	Plate , tapping, securing brackets	5		
TR6503	Screw , securing brackets to tapping plates	10		
602938	Plate , protection, chromed, side cappings	2		
602939	Plate , protection, chromed, rear cappings	3		
500488	Screw , securing protection plates to cockpit cappings	10		
602327	Screw , chromed, hard top to brackets	5		
602943	Washer , on screws	5		

Continued on Next Page

BODY HARDWARE AND FITTINGS, TR2, TR3

HARD TOP MOUNTING HARDWARE AND FITTINGS, TR2, TR3—Continued



**553132 BACK
LIGHT**



RFK2077 WINDOW AND SEAL KIT

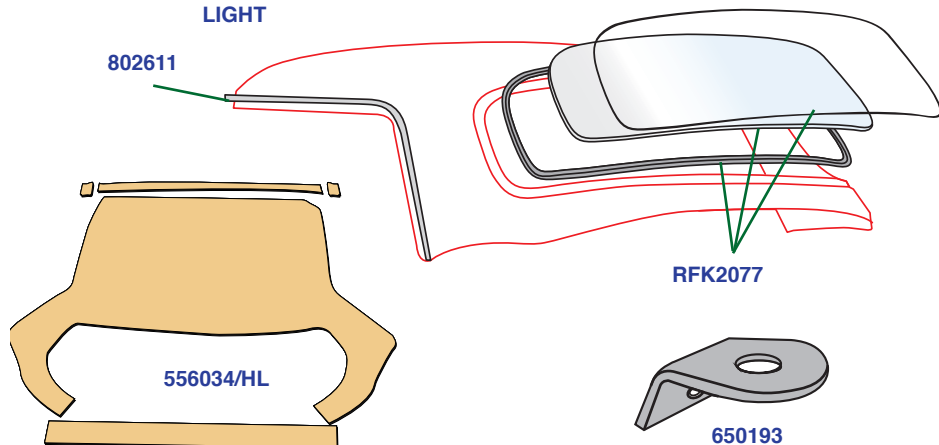

Part No.	Description	No. Off	List Price	Your Price
	BRACKETS , mounted on rear of hard top to waist stiffeners—Not included in kit			
650193	Bracket , side stiffener	2		
650194	Bracket , rear stiffener, center	1		
650195	Bracket , rear stiffener, sides	2		
PT702	Screw , set, securing brackets to stiffeners	5		
WN707	Washer , shakeproof, on set screws	5		
	DRIP CHANNELS			
802611	Drip Channel , LH	1		
802612	Drip Channel , RH	1		
YA344	Screw , securing drip channels to hard top	24		
556034/HL	Headliner , fawn wool material from England as original, comes with extra material for covering and packing the listing rail	1		
RFK2077	HARD TOP REAR WINDOW AND SEAL KIT , TR2, TR3 models; includes window, seal, and filler strip	1		
553132	Back Light , aka Rear Window	1		

BODY HARDWARE AND FITTINGS, TR2, TR3

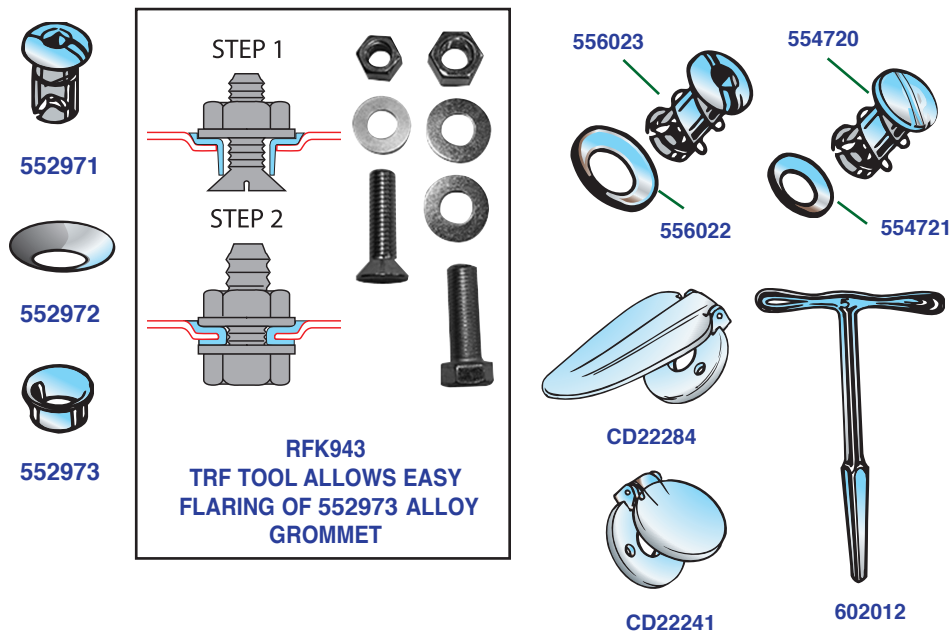
DZUS FASTENERS, CHROMED ESCUTCHEONS
—QUICK-REFERENCE LISTING, TR2, TR3

Part No.	Description	No. Off	List Price	Your Price
BONNET FASTENERS				
552971	Dzus Fastener , bonnet	2		
552972	Washer , retaining Dzus fastener	2		
552973	Grommet (Eyelet) , reinforcing piercings in bonnet for fasteners	2		
RFK943	Simple Tool , for flaring Dzus grommet, includes instructions	1		
SIDE CURTAIN FASTENERS				
556023	Dzus Fastener , side curtains, fitted after comm. no. TS28874	4		
556022	Washer , retaining side curtain fasteners	4		
WINDSCREEN FASTENERS				
554720	Dzus Fastener , with slotted head, fitted up to comm. no. TS60000, includes spring	4		
554721	Washer , retaining windscreen fasteners	4		
CHROMED ESCUTCHEONS , fitted to budget latches on trunk lid and spare wheel lid				
CD22284	Escutcheon , chromed, covering latches on trunk lid, teardrop shaped cover	2		
CD22241	Escutcheon , chromed, covering latches on spare wheel lid; round cover	2		
COACH KEY				
602012	Tool , operating Dzus fasteners and budget locks	1		

BODY HARDWARE AND FITTINGS, TR2, TR3

NUT AND BOLT KITS FOR MOUNTING BODY SHEET METAL, TR2, TR3

TRF offers nut and bolt kits to make it easier to order hardware components, as kits may contain many part numbers. All of our hardware kits are assembled in house, and they generally include genuine English hardware, including pointed bolts and washers of original diameters and thicknesses.

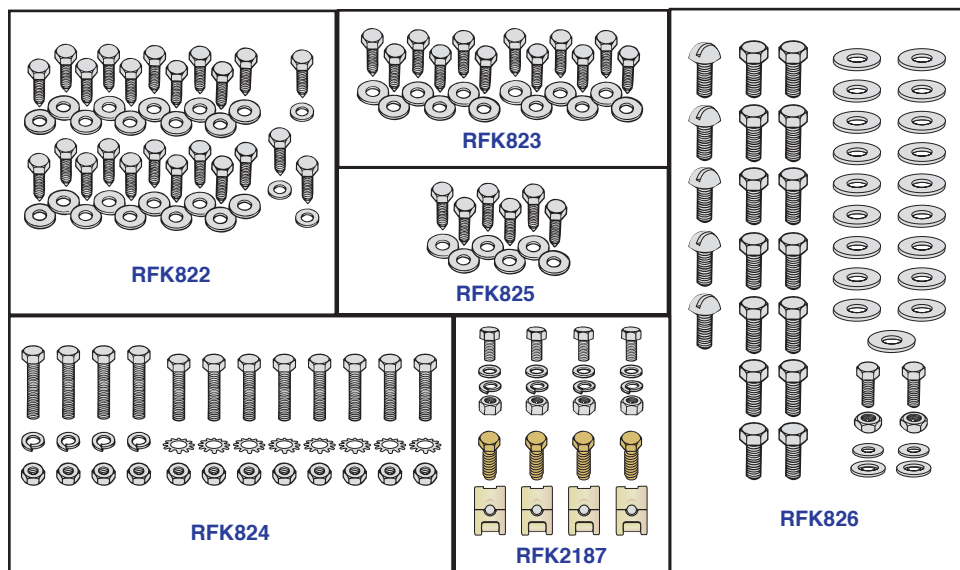

Part No.	Description	No. Off	List Price	Your Price
----------	-------------	---------	------------	------------

HARDWARE KITS FOR MOUNTING BODY SHEET METAL

RFK822	Hardware Kit , mounting front fenders; contains 48 pieces of hardware	2
RFK823	Hardware Kit , securing front apron to front fenders; contains 24 pieces of hardware	1
RFK2187	Hardware Kit , securing lower platform panel inside front apron to inner front fenders; includes two styles of fasteners, either of which may have been used, instruction sheet, TR3A, TR3B only	1
RFK824	Hardware Kit , securing top of front apron to tie-bar fitted between inner fenders; contains 36 pieces of hardware	1
RFK825	Hardware Kit , securing front fender splash plates to bulkhead; contains 12 pieces of hardware	2
RFK826	Hardware Kit , securing rear fenders; contains 46 pieces of correct hardware; including washers for mushroom head screws in trunk gutters, included, although our experience is that they were not always used	2

BODY HARDWARE AND FITTINGS, TR2, TR3

NUT AND BOLT KITS FOR MOUNTING BODY SHEET METAL, TR2, TR3

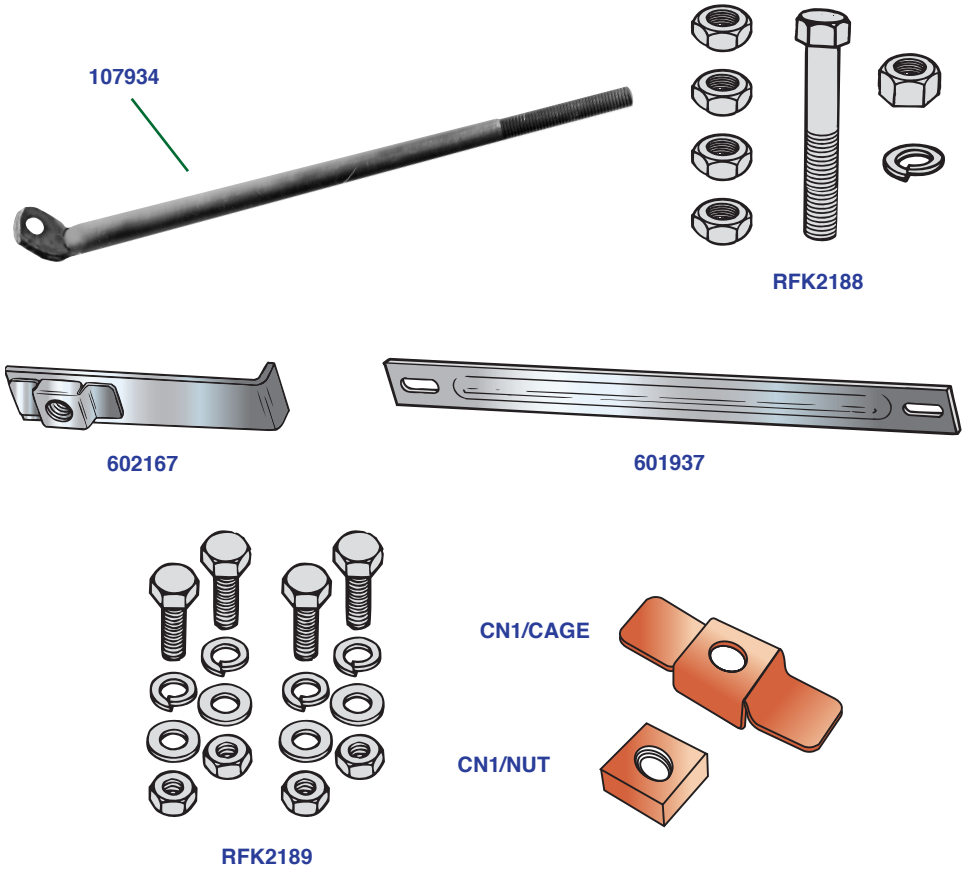

Part No.	Description	No.Off	List Price	Your Price
MISCELLANEOUS FITTINGS				
107934	Stay , supporting front valance from chassis frame to crank guide bracket,	2		
RFK2188	Hardware Kit , securing stays listed above	1		
602167	Clamp Plate , securing rear fenders, rear upper mounting point; includes captive nut	2		
601937	Stay , supporting rear fenders to chassis just behind rear wheels	2		
RFK2189	Hardware Kit , securing support stays to rear fenders and to chassis; contains 16 pieces of hardware	1		
CN1/CAGE	Cage , for captive nut, welded to various body panels	A/R		
CN2/CAGE	Cage , for captive nut, wider cage, welded to rear fenders, upper mountings	10		

FRONT AND REAR BUMPERS, TR2, TR3

TRF stocks a full range of chromed bumper components and related hardware and fittings. We are listing everything you might need in this section. Note that TRF stocks very high quality front bumper bars made in USA. These fit and appear as original.

FRONT BUMPERS, TR2, TR3, 1954-57

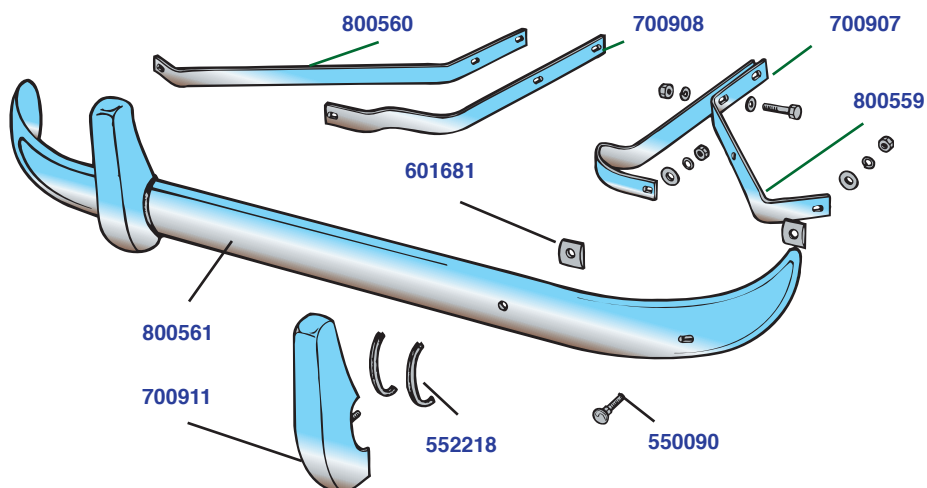

Part No.	Description	No.Off	List Price	Your Price
FRONT BUMPERS, TR2, TR3, up to comm. no. TS22012, 1954-57				
800561	Front Bumper Bar , chrome plated	1		
700911	Over-rider , front bumper, chrome plated	2		
552218	Plastic Moulding , between over-riders and bumper bar	4		
SUPPORT BRACKETS , front bumper				
700907	Bracket , inner, LH	1		
800559	Bracket , outer, LH	1		
700908	Bracket , inner, RH	1		
800560	Bracket , outer, RH	1		
RFK1137	HARDWARE KIT , securing bumper bar and over-riders to support brackets	1		
550090	Bolt , bumper, securing bumper bar and over-riders to inner brackets	2		
550090	Bolt , bumper, securing bumper bar to outer brackets	2		
WP8	Washer , plain on bolts	4		
WQ309	Washer , lock on bolts	4		
HN2009	Nut , hex	4		
601681	Spacer , between brackets and bumper bar	4		
RFK1138	HARDWARE KIT , securing bumper support brackets to chassis frame	1		
HB931	Bolt	4		
WM79	Washer , plain	4		
HN2009	Nut , hex	4		
WL209	Washer , lock	4		

FRONT AND REAR BUMPERS, TR2, TR3

FRONT BUMPER, TR3A, TR3B, 1958-62

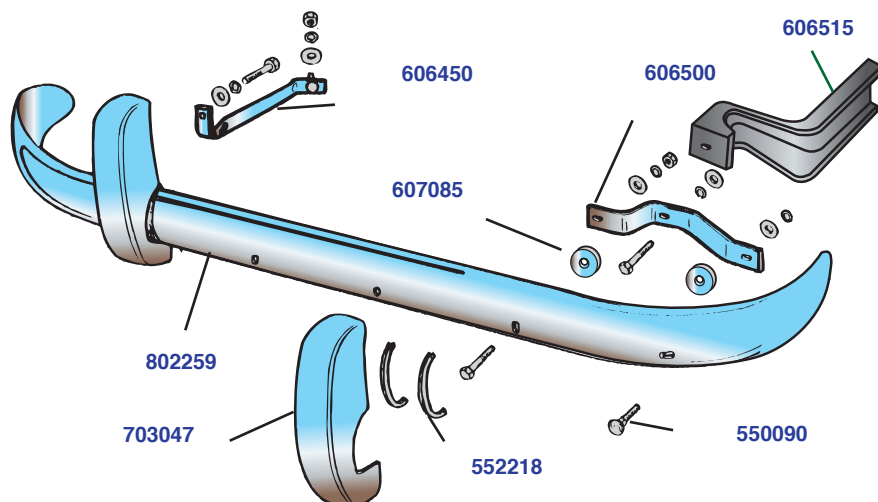

Part No.	Description	No.Off	List Price	Your Price
FRONT BUMPERS, TR3A, TR3B, after comm. no. TS22012, 1958-62				
802259	Front Bumper Bar , chrome plated	1		
703047	Over-rider , front bumper, chrome plated	2		
552218	Plastic Moulding , plastic moulding between over-riders and bumper bar	4		
606500	Support Bracket , between bumper bar and front apron	2		
607085	Spacer , spherical, between bumper bar and support brackets	4		
RFK1139	HARDWARE KIT , securing bumper bar and over-riders to support brackets	1		
HB912	Bolt	2		
550090	Bolt , bumper, chrome plated	2		
WP130	Washer , plain, on bolts	4		
WQ309	Washer , lock, on bolts	4		
HN2009	Nut , hex	4		
RFK1140	SUPPORT TUBE KIT , front over-riders	1		
606449	Tube , over-rider support, chromed, LH	1		
606450	Tube , over-rider support, chromed, RH	1		
	HARDWARE , securing support tubes and radiator air deflector to inner front fenders			
WP139	Washer , plain	2		
WL208	Washer , lock	2		
HN2008	Nut , hex	2		
	HARDWARE , securing support tubes to over-riders			
HU908	Screw , set	2		
WP9	Washer , plain	2		
WQ309	Washer , lock	2		

FRONT AND REAR BUMPERS, TR2, TR3

FRONT BUMPERS, TR3A, TR3B, 1958-62—Continued

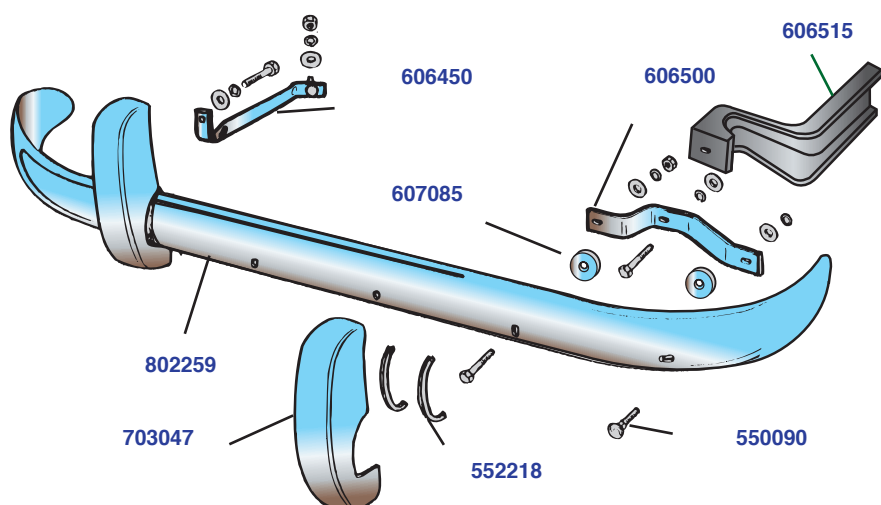

Part No.	Description	No. Off	List Price	Your Price
MAIN SUPPORT BRACKETS , chassis				
	frame to back of front apron			
606515	Support Bracket , LH	1		
606516	Support Bracket , RH	1		
118444	Bracket , stiffening, support bracket to steering box mounting	1		
118445	Tube , distance, stiffening bracket	1		
HARDWARE , securing main support				
	brackets to chassis frame			
HB937	Bolt , support bracket, distance tune, and stiffening bracket to chassis frame	1		
HB926	Bolt , support brackets to chassis frame	3		
WM75	Washer , plain, on bolts	4		
WL209	Washer , lock, on bolts	4		
HN2009	Nut , hex, securing bolts	4		
RFK1141	HARDWARE , securing front bumper assembly to main support brackets (through lower front apron into nuts welded to main support brackets)	1		
HB910	Bolt	2		
WP9	Washer , plain, on bolts	2		
WQ309	Washer , lock	2		

FRONT AND REAR BUMPERS, TR2, TR3

REAR BUMPER DETAILS, TR2, TR3

Triumph kept things simple at the back of the car. The components listed here fit all TR2, TR3, TR3A, TR3B—John Swauger in an earlier version of this catalogue, circa 2015.

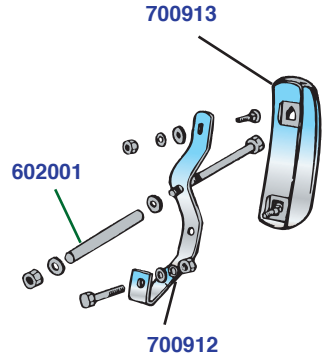
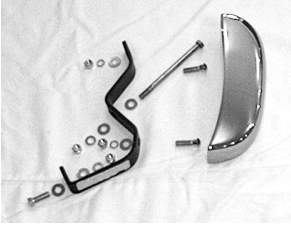

Part No.	Description	No. Off	List Price	Your Price
700912	Support Bracket , rear bumper over-riders	2		
602001	Tube , distance, supporting brackets through holes in rear apron to chassis frame	2		
RFK1143	HARDWARE KIT , securing support brackets and distance tubes to chassis frame through rear apron	1		
HB942	Bolt , securing support brackets and distance tubes to chassis frames	2		
HU907	Screw , set, securing support brackets to chassis frame, lower attachment	2		
WP9	Washer , plain, on bolts and screws	8		
WL209	Washer , lock, on bolts and screws	4		
HN2009	Nut , hex, securing bolts and screws	4		
700913	Rear Bumper Over-rider , chrome plated	2		
RFK1142	HARDWARE KIT , securing over-riders to support springs	1		
550090	Bumper Bolt	4		
WP9	Washer , plain	4		
WL209	Washer , lock	4		
HN2009	Nut , hex	4		

RADIATOR GRILLES AND OTHER SHINY PARTS, TR2, TR3

RADIATOR GRILLES, TR2, TR3

Three different grilles, actually four counting the two TR2 versions, were fitted to the TR2 and TR3 models. Options are available to replace all of these, and most of the fittings and related parts are also available.

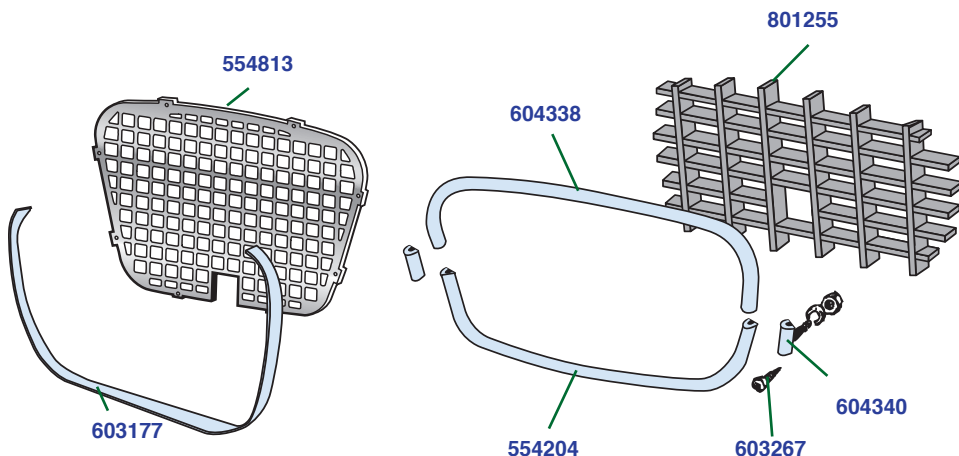

Part No.	Description	No.Off	List Price	Your Price
RADIATOR GRILLE DETAILS, TR2				
	models, fitted up to comm. no. TS8636			
800534	Grille , die-cast version	1		
554813	Grille , sheet metal version; alternative to previous	1		
	HARDWARE , securing grille to front apron			
YH6508	Screw	8		
FU2585	Nut , fix, securing screws	8		
603177	Reveal Moulding , fitted to lower half of grille opening in front apron, fitted to later TR2 models	1		
	HARDWARE , securing reveal moulding			
603267	Stud , fixing reveal moulding	5		
603179	Clip , securing reveal moulding	8		
WQ305	Washer , lock	11		
HN2005	Nut , hex	11		
RADIATOR GRILLE DETAILS, TR3 models,				
	fitted from comm. no. TS8637 up to TS22013			
801255	Grille , egg-crate style	1		
YA444	Screw , securing grille to front apron	4		
RFK951	REVEAL MOULDING KIT , fitted around grille opening	1		
554204	Reveal Moulding , lower half	1		
604338	Reveal Moulding , upper half	1		
604340	Piece , cover, joint in mouldings	2		
603267	Stud , fixing reveal mouldings	9		

RADIATOR GRILLES AND OTHER SHINY PARTS, TR2, TR3—Continued

RADIATOR GRILLES, TR3A, TR3B

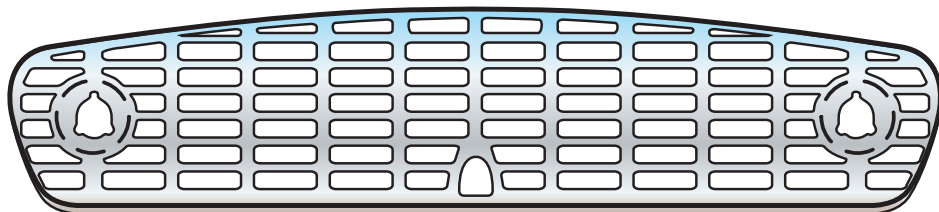

802174

Part No.	Description	No.Off	List Price	Your Price
RADIATOR GRILLE DETAILS, TR3A, TR2B				
	models, fitted after comm. no. TS22013			
802174	Grille , wide type, better pressing with bright anodized finish	1		
RFK958	HARDWARE KIT , securing wide grille	1		
YZ3364	Screw	8		
FU2543/9	Nut , spire	4		
FN2043	Nut , fix	4		
803440	Air Deflector , radiator, fibreboard (to be painted in body colour)	1		
	HARDWARE , securing radiator air deflector “floor panel” inside front apron			
YA404	Screw	6		
505306	Washer , plain	6		



TR3A Fitted with Original Lucas PL700 Tripod
Headlamps and the 802174 Grille

RADIATOR GRILLES AND OTHER SHINY PARTS, TR2, TR3—Continued

FENDER PIPING AND WING BEAD—TR2, TR3

All TR2s were fitted with plastic piping between the fenders and the body. Originally, this was manufactured in body colours and sold by the foot. This product has generally been unavailable, and we are listing it at this time for information only. With the current level of interest in TR2s, perhaps someone will think of a way to manufacture it, at least in one colour that could be painted in any colour. TR3, TR3A, and TR3B models were fitted with stainless steel bead strips secured in position with metal tabs fitted into the slot on the backside of the bead strips. Although sources have threatened to discontinue the stainless steel beads, so far we are able to supply it as needed.

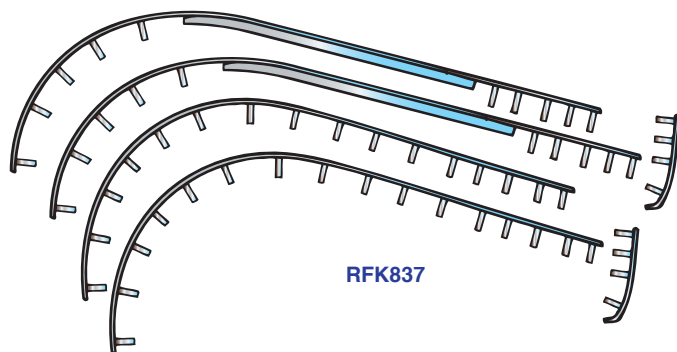

Part No.	Description	No. Off	List Price	Your Price
----------	-------------	---------	------------	------------

ORIGINAL TR2 PART NUMBERS,

piping was sold by the foot

700947	Fender Piping , plastic, neutral colour for painting, reproduction	A/R
700947/BLK	Fender Piping , plastic, black	A/R
700947/OY	Fender Piping , plastic, olive yellow	A/R
700947/GN	Fender Piping , plastic, green	A/R
700947/RED	Fender Piping , plastic, red	A/R
700947/GER	Fender Piping , plastic, geranium	A/R
700947/WHI	Fender Piping , plastic, white	A/R

LENGTHS OF PIPING REQUIRED

Rear Fender , front portion, 68-1/2 inches	2
Rear Fender , rear portion, 10-1/8 inches	2
Front Fender to Scuttle , 9-5/16 inches	2
Front Fender to Front Apron , 27-1/2 inches	2

STAINLESS STEEL FENDER BEADS, fitted
to TR3, TR3A, TR3B, after comm. no. TS8636

RFK837	FENDER BEAD KIT ; includes six pieces, pre-bent to shape, with tabs installed	1
553924	Fender Bead Assembly , front fenders	2
553925	Fender Bead Assembly , rear fenders, long portion	2
554172	Fender Bead Assembly , rear fenders, short portion	2
553926	Fixing Tab , fender bead; for repairs	A/R

RADIATOR GRILLES AND OTHER SHINY PARTS, TR2, TR3—Continued

REAR FENDER STONE GUARDS, TR2, TR3

Except for the first few TR2s, the same rear fender stone guards were used on all TR2, TR3, TR3A, and TR3B models. Original components disappeared just about the time The Roadster Factory was founded in 1978. Since that time, the reproduction parts available have been improved again and again, but they still leave something to be desired. In the past, we had a better source for a few years, but eventually, it dried up without a trace. The available stone guards require some work to make them fit to a high standard, but as can be seen at any car show, many enthusiasts are able to manage this task...



Part No.	Description	No. Off	List Price	Your Price
RFK188	STONE GUARD KIT , TR2, TR3, TR3A, TR3B	1		
800539	Stone Guard , large, rear fender, LH	1		
800540	Stone Guard , large, rear fender, RH	1		
601992	Stone Guard , small, "foot," LH	1		
601993	Stone Guard , small, "foot," RH	1		
HARDWARE SPECIFIED BY FACTORY				
SPARE PARTS CATALOGUE				
YA124	Screw , stone guard attachment	2		
YA183	Screw , stone guard attachment	2		

RADIATOR GRILLES AND OTHER SHINY PARTS, TR2, TR3—Continued

THRESHOLD FINISHERS, TR2, TR3

The factory spare parts catalogue names these as “Sill Edge Finishers.” They are not Threshold Plates by the common definition. TRF sells especially nice versions which are made in USA. The spare parts catalogue specifies pop rivets for securing the finishers to the sills, but I have also seen standard trim screws, and I will list these as well. These parts make a nice finishing touch to a newly-installed carpet set or interior.

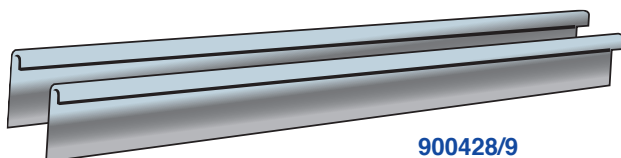

900428/9

Part No.	Description	No.Off	List Price	Your Price
900428/9	Sill Trim Kit , all TR2, TR3, TR3A, TR3B; includes one pair of polished aluminium finishers	1		
552522	Rivet , pop, securing trim finishers	4		
YA165/CP	Trim Screw , securing trim finishers; alternative to previous	4		

HEADLAMP CHROMED RIMS, TR2, TR3

Three different headlamps were fitted to U.S. TR2 and TR3 models, including TR3A and TR3B. The one used in 1958 has an interesting rim which utilizes a clamp and screw at the bottom of the rim to secure it to the lamp. It is interesting but it is not available. TRF had a small stock of originals back in the early 1980s, but nothing has appeared since that time. The TR2 and TR3 rim, fitted from 1954-57, which is retained by one screw is readily available and quite inexpensive. The wide chromed rim used on USA models after 1958 has been manufactured to a high standard, but it is more expensive...



LU54520650



LU552913

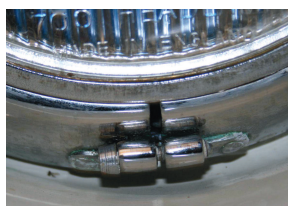

CLOSE-UP VIEW OF
CLAMPING SCREW ON
LU552913



LU54520443

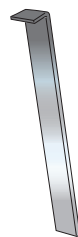

118971

Part No.	Description	No.Off	List Price	Your Price
LU54520650	Rim , headlamp, chromed, comes with fixing screw, TR2, TR3, 1954-57	2		
LU552913	Rim , headlamp, chromed, split type with clamp and screw, fitted to 1958 USA models	2		
LU54521913	Rim , headlamp, chromed, wide snap-on type, fitted to USA models from 1959 to 1963	2		
118971	Tool , headlamp removal, use with snap-on rims, 1959-62	1		

RADIATOR GRILLES AND OTHER SHINY PARTS,
TR2, TR3—Continued

LUCAS STYLE FENDER MIRRORS, TR2, TR3

The Lucas-style mirrors listed here are only one version of the accessory mirrors manufactured by Lucas, Tex, and others back when the cars were in production. This style has passed the test of time, however, and it is still readily available. They are rather painful to adjust, either taking two people or requiring the driver to get in and out of the car until he or she gets them right. Obviously, these were made by Lucas originally, but today, they are made by a different manufacturer. The name “Lucas” no longer appears on the plate behind the mirror, but we have found that we made be able to get plates with the correct branding for the purist. TRF has manufactured the rubber gasket as a replacement part, as our customers have requested it. Note that convex lenses give a wider view, and some drivers like it on the RH aide to aid in parking.

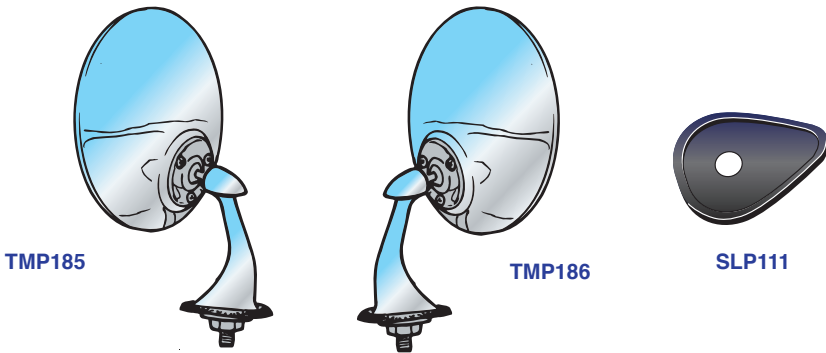

Part No.	Description	No.Off	List Price	Your Price
FENDER MIRRORS , reproductions of Lucas originals; require a hole through the fender for installation				
TMP185	Fender Mirror , LH, flat lens	1		
TMP186	Fender Mirror , RH, flat lens	1		
TMP187	Fender Mirror , LH, convex lens	1		
TMP188	Fender Mirror , RH, convex lens	1		
SLP111	Gasket , replacement, fender mirror; comes with new mirrors	A/R		
REP453	Back Plate , replacement, includes Lucas name as on original mirrors	A/R		

BADGES, LETTER SETS, AND NAMEPLATES, DATA PLATES, AND LABELS, TR2, TR3

FRONT APRON BADGES

As TRF is run by serious TR2 and TR3 enthusiasts, including our late founder, Charles Runyan and John Swauger, retired, who've done frame-ups on several cars, or perhaps I should say several frame-ups on the same cars. At any rate, TRF knows how these cars should be, and we have now had all of the badges, letters, and nameplates manufactured for us with the exception of the hub cap badges. Our front apron medallions are made by hand at an original supplier to Triumph in the old jewelry quarter of Birmingham. These badges are works of art. Our chromed letters and rear nameplate are made in Taiwan by our friend of more than twenty years. When he was commissioned to make them, he was shown original parts and parts made by others. We told him that there was no point in making them if they weren't better than the others. He has always started with what we want and worked as hard as necessary to accomplish just that. Charles always used to say that he wouldn't sell you parts that he wouldn't use himself, and the parts listed in this section were used on his car...



601890



604272



CNP141



606422



608377

Part No.	Description	No. Off	List Price	Sale Price
----------	-------------	---------	------------	------------

FRONT APRON BADGES

601890	Badge , red and black, TR2	1		
604272	Badge , red and black, TR3, up to comm. TS22013	1		
CNP141	Badge , blue, black, and white, TR3, TR3A; exact applications unknown	1		
606422	Badge , red and black, early TR3A, up to comm. no. TS41877	1		
608377	Badge , blue and white, TR3A, TR3B, after comm. no. 41877	1		
FP1005	Fix Nut , securing badges	2		

BADGES, LETTER SETS, AND NAMEPLATES, DATA PLATES, AND LABELS, TR2, TR3—Continued

LETTER SETS, NAMEPLATE, HUB CAP BADGES, AND WHEEL NUTS

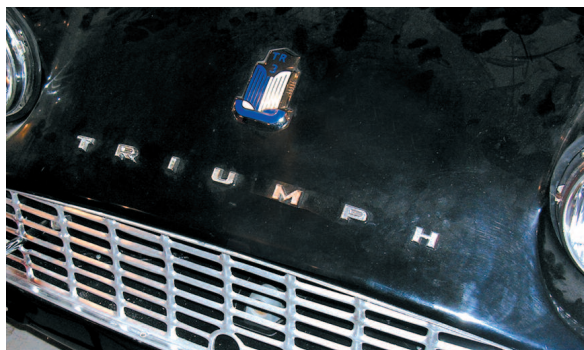

TRIUMPH

703036-42



TRIUMPH

605556

TRIUMPH

703862-8



113256



201870



109586

Part No.	Description	No. Off	List Price	Sale Price
FRONT APRON LETTER SETS, TR3A, TR3B				
703036-42	Letter Set , ribbed letters, TR3A, TR3B, after comm. no. TS22013	1		
703862-8	Letter Set , smooth letters, used on some TR3B	1		
FP1012/9	Fix Nut , securing badges	14		
REAR APRON NAMEPLATES, TR3A, TR3B				
605556	Nameplate , TRIUMPH, rear apron	1		
FP1012/9	Fix Nut , securing nameplate	3		
HUB CAPS, BADGES, AND WHEEL NUTS				
201870	Hub Cap , chromed, as original	4		
113256	Badge , later painted type	4		
HN2005	Nut , securing hub cap badge	4		
WL205	Washer , lock	4		
109586	Wheel Nut , securing road wheels	16		

BADGES, LETTER SETS, AND NAMEPLATES, DATA PLATES, AND LABELS, TR2, TR3—Continued

COMMISSION NUMBER PLATES

“It is important to know the commission number and model year of your car...”

All TR2, TR3 and TR3A cars had commission numbers that were prefixed “TS”, and it is important to know your exact commission number so you can order the correct parts for your car. TS60000 is a number where a lot of things changed on TR3A, but there are other important change points. TS4002 was the first TR2 made with sills and TS22014 was the first TR3A.

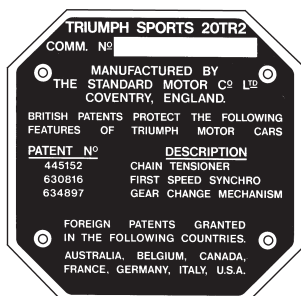

CNP20

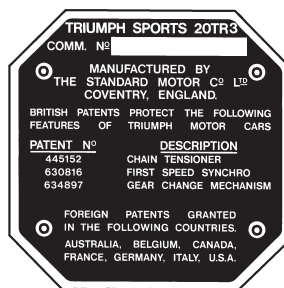

CNP31

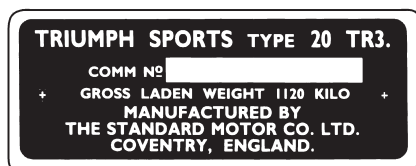

CNP32

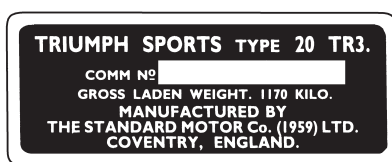

CNP33

Part No.	Description	No. Off	List Price	Your Price
CNP20	Commission Number Plate, TR2	1		
CNP31	Commission Number Plate, TR3, 1956-57	1		
CNP32	Commission Number Plate, early TR3A	1		
CNP33	Commission Number Plate, later TR3A, TR3B	1		

TRACING YOUR CAR'S HISTORY

“Useful Information to Have if You Are Restoring Your Car to Original, Interesting to Know Even if You Aren’t...”

You can order a birth certificate for your TR2 or TR3 (or most other British cars) through the British Motor Museum. To do this you must know the commission number of your car. The easiest way to order a birth certificate is to go to their web site at <https://www.britishmotormuseum.co.uk/archive/heritage-certificates> to order heritage certificates. Payment can be made by credit card. All available information about your car will be provided. Typical information includes build date, exterior colour, interior specification, body numbers (in some cases), final delivery destination, and options. Please note that only available data can be provided.

BADGES, LETTER SETS, AND NAMEPLATES, DATA PLATES, AND LABELS, TR2, TR3—Continued

LABELS

“Freshen Up the Look of Your Engine Compartment with New Engine and Air Cleaner Labels”



CHARLES RUNYAN'S TR3 SHOWING THE AIR CLEANERS AND ACL30 DECALS.

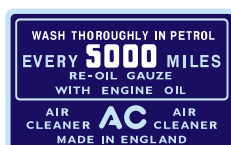

ACL30



CNP202



CNP203



CNP209



CNP1564



CNP201

RFP209



ACL20



CNP217

Part No.	Description	No. Off	List Price	Your Price
CNP201	Label , valve cover, TR2	1		
	OIL FILLER CAP DECALS , study the illustrations above to chose the correct decal for your application			
CNP202	Decal , oil filler cap, white on black	1		
CNP209	Decal , oil filler cap, red	1		
CNP217	Decal , oil filler cap, white on black	1		
CNP203	Label , hydraulic reservoir, TR3, TR3A, TR3B after comm. no. TS13045, cars with Girling brakes	1		
ACL20	Label Set , air cleaners, round, TR2, early TR3; one pair	1		
ACL30	Air Cleaner Decal Kit , includes three Water Decals (an extra one in case you mess up)	1		
CNP1564	Label , Lucas battery sticker, red on gold; can be used on any battery	1		
RFP209	Oversea Visitor Label , as supplied with cars picked up in person at the factory; static cling type	1		