

BODY SHEET METAL COMPONENTS

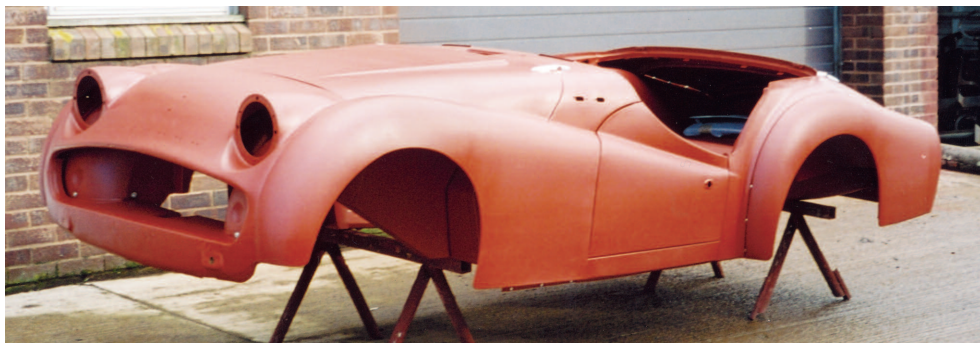

This “chapter” has been in development for many months. We attempt in the following sections to show clearly how the TR2 and TR3 body shells are assembled from components, and we bring products together from a number of sources to provide a fairly complete service, although this goal has not yet been completely realized. We would like to enable customers to resurrect virtually any car from a barn or a field. The parts cars of the past may be turned into the concours winners and daily drivers of the future.

Several levels of components have been available. When TRF started business in 1978, a number of repro panels were available at fairly reasonable prices. Things like floors, inner and outer sills, trunk floors, rear quarters, etc. All of these panels were fairly flat, and they were manufactured by a now-defunct company on inexpensive tooling using a “rubber press.” Attempts were also made to produce fenders and aprons using some tools that had been produced earlier in California to make fenders sold by J.C. Whitney. These tools were problematic, and eventually, they were lost. Other attempts were made in the early 1980s in England to produce rear fenders and other panels, and these were used to save many cars there, but they were unacceptable in the U.S. market since they required a high level of skill to fit to a car. In the U.S., used panels were the preferred choice for outer body panels as long as they lasted, and some used parts remain available today.

Making body shells for sports cars is a cottage industry in England, and companies exist which make body panels by hand from flat sheet metal using the skills handed down from their fathers and grandfathers. The photo above shows a complete body shell produced in this fashion by North Devon Metal Products. TRF will continue to supply low volume components produced by hand. These are usually produced for specific orders, and lead time is a factor.

Over the past couple of years a European source has begun to produce a new range of popular inner and outer panels with the goal of reaching the standard of original Triumph parts or better. We are listing these among the parts in the following sections. Generally, we add the suffix “BP” to the part numbers of these components. We are also including a page of photos of these better panels at the end of this chapter, on page 138. All of them come well-packaged and presented in high-quality primer. Generally we will try to maintain stocks of these, and they are supplied fairly quickly even when we run out.

Parts illustrations and descriptions included in this chapter attempt to provide an understanding of original details of specific components as they were developed for the TR2, TR3, TR3A, and TR3B range of cars. This presentation is limited by the confines of a parts catalogue. A book could be written on this subject, but in the space we have here, we have tried to aid enthusiasts to avoid mixing model variations on one car, a problem which has reared its ugly head many times in the past.

We hope you find these listings to be useful in restoring or improving examples of the TR2, TR3, TR3A, and TR3B range of cars.

BODY SHEET METAL COMPONENTS

BODY MOUNTING KITS

“Packaged in Subkits for Easy Identification”

TRF's first real catalogue written and printed in Spring 1979 listed the same body mounting components you will find here. Replacing body pads is an essential part of any complete restoration and it provides a solid feel to the car you can't have without replacing old pads and hardware. Body pads are also useful in aligning body panels when the body is being installed on the chassis frame after a major rebuild. Increasing or decreasing pads in various locations will adjust door gaps and other problems. TRF body mounting kit as listed below includes all components required to mount the body to the chassis frame as it came from the factory

Continued On Next Page

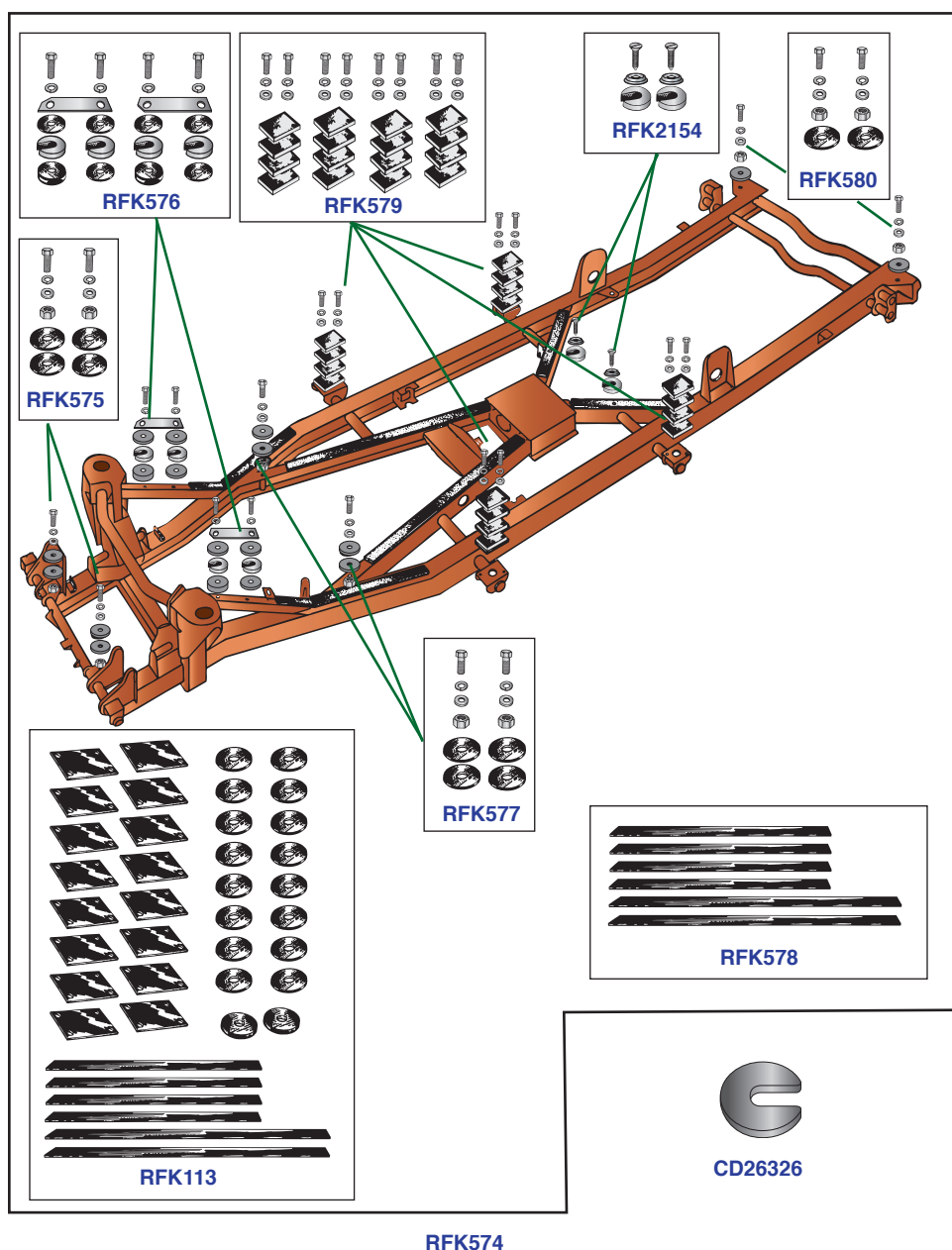

BODY SHEET METAL COMPONENTS

BODY MOUNTING KITS—Continued

Part No.	Description	No. Off	List Price	Your Price
RFK574	BODY MOUNTING KIT , complete; includes all sub-kits indented below	1		
RFK575	Front Sub-Kit , mounting front inner fenders to brackets on chassis frame	1		
RFK578	Protection Strip Sub-Kit , includes six rubber strips cemented to chassis frame front and rear X-members and side braces	1		
RFK576	Side-Brace Sub-Kit , mounting inner front fenders to suspension braces; includes thin, thick, and alloy mounting pads, reinforcing plates, set screws, and lock washers	1		
RFK577	Front Cruciform Sub-Kit , mounting fronts of main floor panels to chassis frame front X-member; includes thin pads, bolts, and washers	1		
RFK2154	Rear Cruciform Sub-Kit , mounting rears of main floor panels to chassis frame rear X-member; includes alloy pads, special washers, and screws with countersunk heads	1		
RFK579	Sill-Mounting Sub-Kit ; fitted between outrigger brackets on chassis frame and brackets welded to insides of outer sill assemblies; includes square pads, bolts, and washers	1		
RFK580	Rear Sub-Kit , mounting brackets at rear of body to chassis frame, includes thin round pads, set screws, washers, and nuts	1		
RFK113	BODY PAD AND STRIP KIT , includes a complete set of rubber pads and strips, but no hardware, includes extra pads for shimming	1		
601994	Pad , rubber, thin round, body mounting	A/R		
608836	Pad , rubber, thick round, body mounting	A/R		
611732	Pad , rubber square, body mounting	A/R		
601995/1	Protection Strip , 18-inches	A/R		
601995/2	Protection Strip , 18-inches	A/R		
CD26326	Pad , alloy, slotted, not included in kit	A/R		

BODY SHEET METAL COMPONENTS

CENTER BODY STRUCTURE, TR2, TR3

Late main floor panels supplied may be a teeny bit longer than on earlier versions, as the toe board flanges turn rearward under the floors on earlier models and they turn forward over the floors on models after comm. no. TS60000. Trim only after taking careful measurements. TRF inner sills are made to match original dimensions, including pressings to locate door posts. They retain sheet metal of the original gauge and other specifications which more than justify their slightly higher price. Very early TR2 models, known as “long doors” did not have the outer sills

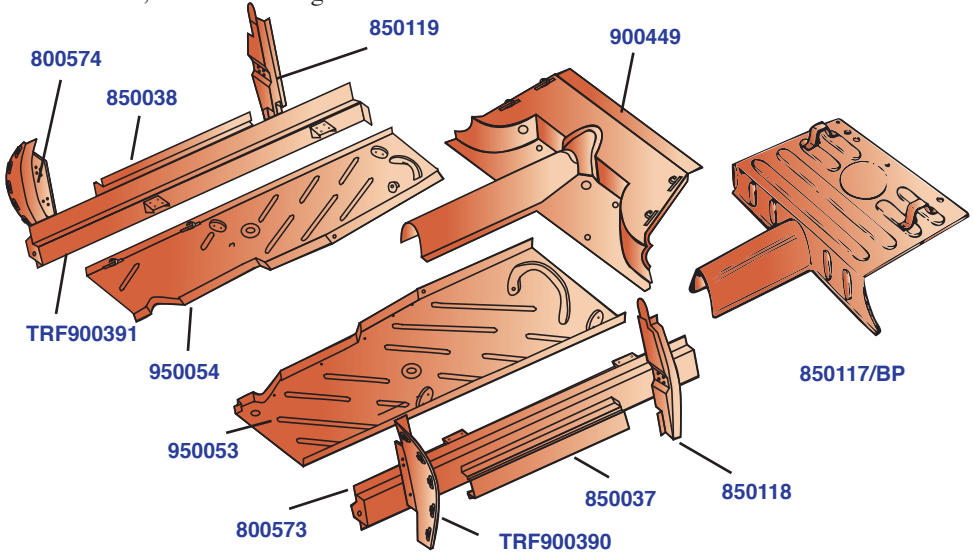

Part No.	Description	No.Off	List Price	Your Price
SILLS (ROCKER PANELS)				
TRF900390	Sill , inner, LH; read above	1		
TRF900391	Sill , inner, RH; read above	1		
850037	Sill , outer (Rocker Panel), LH	1		
850038	Sill , outer (Rocker Panel), RH	1		
FLOOR PANELS				
950053	Main Floor Panel , LH	1		
950054	Main Floor Panel , RH	1		
900449	Rear Floor Assembly , with drive shaft tunnel, fitted up to comm. no. TS60000	1		
850117/BP	Rear Floor Assembly , with drive shaft tunnel, fitted after comm. no. TS60000	1		
FRONT AND REAR DOOR POSTS				
800573	Door Post , front (aka “A” Post), LH	1		
800574	Door Post , front (aka “A” Post), RH	1		
REP459	Bracket , pivot, door check strap, included with door post, also supplied for repairs	2		
850118	Door Post , rear (aka “B” Post), LH, fitted after comm. no. TS60000; use for all replacements	1		
850119	Door Post , rear (aka “B” Post), RH, fitted after comm. no. TS60000; use for all replacements	1		

BODY SHEET METAL COMPONENTS

BODY SHELL—BULKHEAD AND SCUTTLE REPAIR

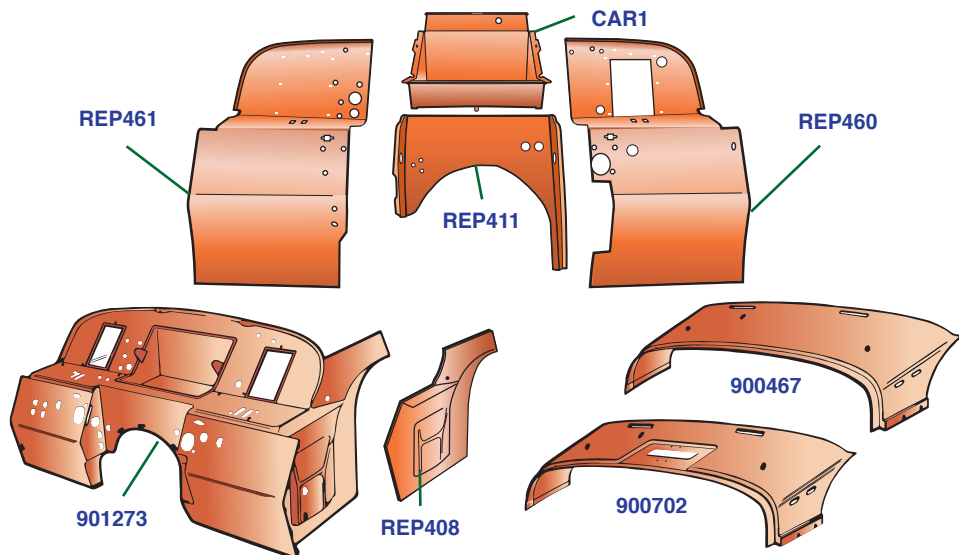

Part No.	Description	No. Off	List Price	Your Price
----------	-------------	---------	------------	------------

BULKHEADS

900444	Bulkhead Assembly , 1954-57, up to comm. no. TS22529, fits both LHS and RHS	1		
901273	Bulkhead Assembly , 1958-59, from comm. no. TS22530 up to TS60000, fits both LHS and RHS	1		
950013	Bulkhead Assembly , fitted after comm. no. TS60000, LHS only	1		
950014	Bulkhead Assembly , fitted after comm. no. TS60000, RHS only	1		

BULKHEAD COMPONENTS

REP410	Bulkhead Front Section , LH side, fitted up to comm. no. TS60000	1		
REP460	Bulkhead Front Section , LH side, fitted after comm. no. TS60000, LHS models	1		
REP411	Bulkhead Front Center Section , lower	1		
CAR1	Battery Box Assembly , with all brackets, holes, etc., as original	1		
REP412	Bulkhead Front Section , RH side, fitted up to comm. no. TS60000	1		
REP461	Bulkhead Front Section , RH side, fitted after comm. no. TS60000, LHS models	1		
REP408	End Panel, bulkhead , LH	1		
REP409	End Panel, bulkhead , RH	1		

SCUTTLE PANELS (Bulkhead Tops)

900467	Scuttle Panel , no vent lid, TR2 up to comm. no. TS6156; takes wood rim	1		
900702	Scuttle Panel , with aperture for vent lid, TR2, TR3, TR3A; takes wood rim	1		
REP415	Repair Panel , scuttle, latest models not having wooden rim	1		

BODY SHEET METAL COMPONENTS

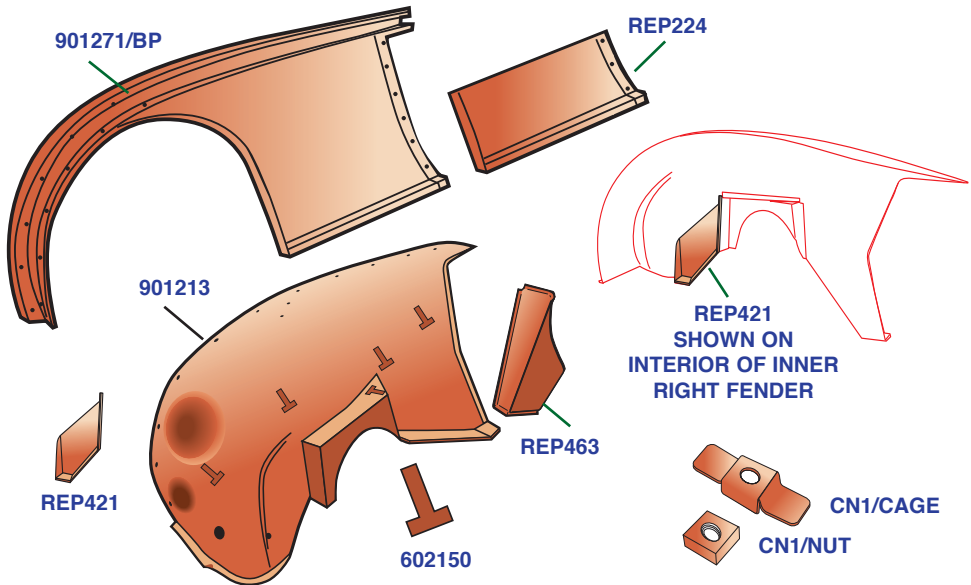
BODY SHELL—FRONT FENDERS (WINGS),
INNER AND OUTER

Part No.	Description	No.Off	List Price	Your Price
----------	-------------	--------	------------	------------

INNER FRONT FENDERS

900690	Fender , inner front, LH, TR2, TR3, 1954-57	1		
900691	Fender , inner front, RH, TR2, TR3, 1954-57	1		
901212	Fender , inner front, LH, TR3A, TR3B	1		
901213	Fender , inner front, RH, TR3A, TR3B	1		

MISCELLANEOUS DETAILS, inner front
fenders

REP462	Bracing Member , LH	1		
REP463	Bracing Member , RH	1		
REP420	Mounting Bracket , to chassis, LH	1		
REP421	Mounting Bracket , to chassis, RH	1		
602150	Clip , wiring harness, welded to panels	A/R		Suggest 603559
CN1/CAGE	Cage , for captive nuts	A/R		
CN1/NUT	Nut , in cage	A/R		

FRONT FENDERS (WINGS)

901270/BP	Fender , steel, front, LH	1		
901270/AL	Fender , aluminium, front, LH	1		
REP224	Repair Section , steel, front fender, LH	1		
901271/BP	Fender , steel, front, RH	1		
901271/AL	Fender , aluminium, front, RH	1		
REP225	Repair Section , steel, front fender, RH	1		
RFK822	Hardware Kit , mounting front fenders; includes 23 pointed screws and 23 plain washers	2		
CN1/CAGE	Cage , for captive nuts	A/R		
CN1/NUT	Nut , in cage	A/R		

BODY SHEET METAL COMPONENTS

BODY SHELL—FRONT APRONS, TR2, TR3

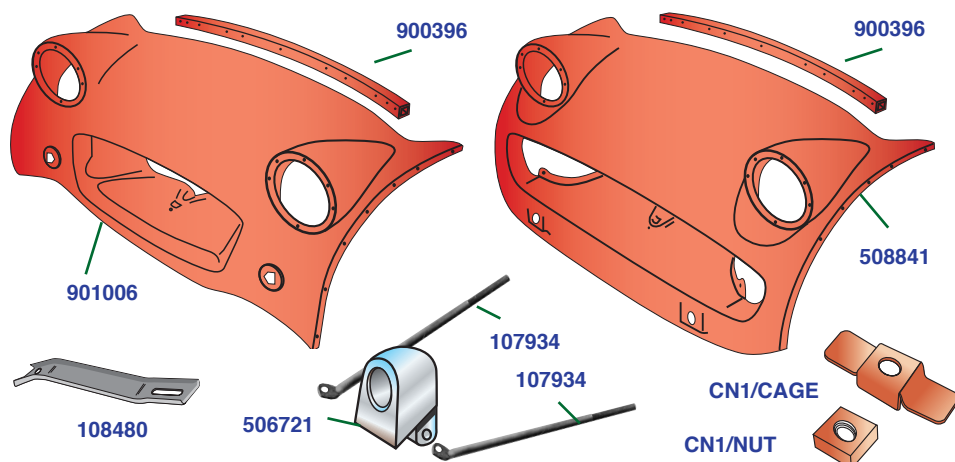

Part No.	Description	No.Off	List Price	Your Price
900458	Front Apron Assembly , TR2, up to comm. no. TS8636	1		
901006	Front Apron Assembly , narrow grille, TR3, from comm. no. TS8637 up to TS22013	1		
508841	Front Apron Assembly , wide grille, TR3A, TR3B, after comm. no. TS22013	1		
900396	Tie-member , between inner finders	1		
RFK824	Hardware Kit , securing front apron to tie member and tie-member to brackets on inner fenders, bolts, washers, nuts, 36 pieces	1		
108480	Stay , front apron to chassis frame, fitted from comm. no. TS1 up to TS?	1		
RFK2186	Hardware Kit , securing stay to front apron and to chassis frame, includes two set screws, washers, and nuts, 8 pieces	1		
RFK823	Hardware Kit , securing front apron to outer fenders, includes 12 pointed bolts and 12 plain washers	1		
CN1/CAGE	Cage , for captive nuts	A/R		
CN1/NUT	Nut , in cage	A/R		
RFK2187	Hardware Kit , securing lower platform panel inside front apron to inner front fenders; includes two styles of fasteners, either of which may have been used, instruction sheet, TR3A, TR3B only	1		
506721	Bracket , hand crank guide; chromed on earlier cars, body colour, or possibly self finish on later cars	1		
JN2108	Jam Nut , securing guide bracket to apron	2		
WL207	Washer , lock, securing jam nuts	2		
107934	Stay , supporting hand crank guide from cross-tube on chassis frame	2		
RFK2188	Hardware Kit , securing stays to hand crank guide and to chassis frame; includes bolt, lock washer, and nuts, 7 pieces	1		

BODY SHEET METAL COMPONENTS

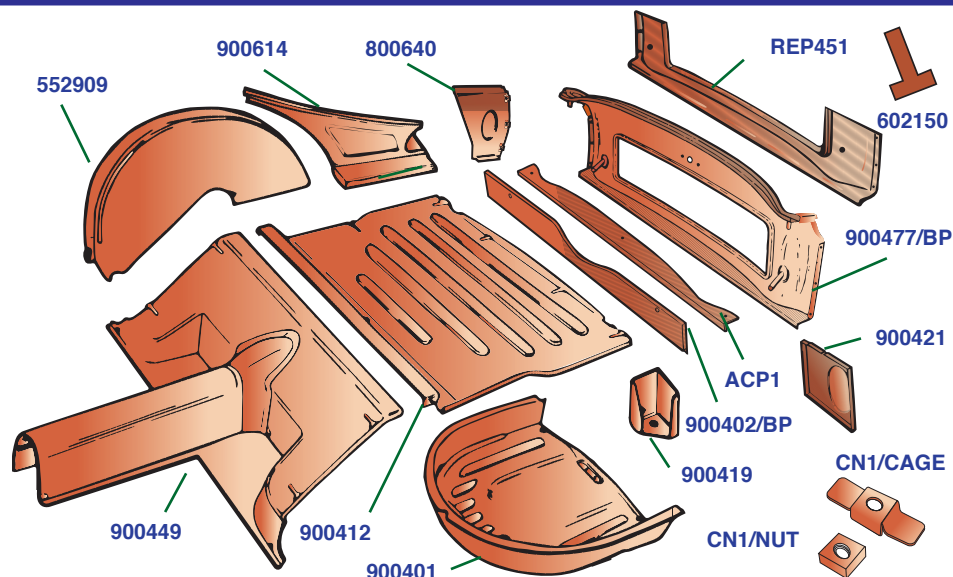
BODY SHELL—REAR BODY SECTION, TR2, TR3,
1954-59

Part No.	Description	No. Off	List Price	Your Price
----------	-------------	---------	------------	------------

REAR BODY DETAILS, from comm. no.

TS1 up to TS60000

900449	Rear Floor Assembly , with drive shaft tunnel	1		
900412	Trunk Floor Assembly	1		
552908	Wheel Arch, LH	1		
900615	Trunk Side , with trunk floor section, LH	1		
552909	Wheel Arch, RH	1		
900614	Trunk Side , with trunk floor section, RH	1		
900401	Container , spare wheel	1		
900477/BP	REAR APRON , outer panel, fitted up to comm. no. TS16473 on some cars and later on others	1		
901299/BP	REAR APRON , outer panel, with separate signal lamp pressings, fitted to some cars for U.S. market after comm. no. TS16473 all cars by TS18913	1		
ACP1	Repair Panel , rear apron bottom flange	1		
REP451	Repair Panel , rear apron bottom section, bottom flange and half way up spare tire opening	1		
900402/BP	Rail , back bottom	1		
900421	Panel , closing, rear apron, front, LH	1		
900422	Panel , closing, rear apron front, RH	1		
800639	Panel , closing, rear apron, side, LH	1		
800640	Panel , closing, rear apron, side, RH	1		
900419	Bracket , body mounting, LH	1		
900420	Bracket , body mounting, RH	1		
CN1/CAGE	Cage , for captive nuts	A/R		
CN1/NUT	Nut , in cage	A/R		
602150	Clip , wiring harness, welded to panels	A/R		Suggest 603559

BODY SHEET METAL COMPONENTS

BODY SHELL—REAR BODY SECTION, TR3A, TR3B, 1959-62

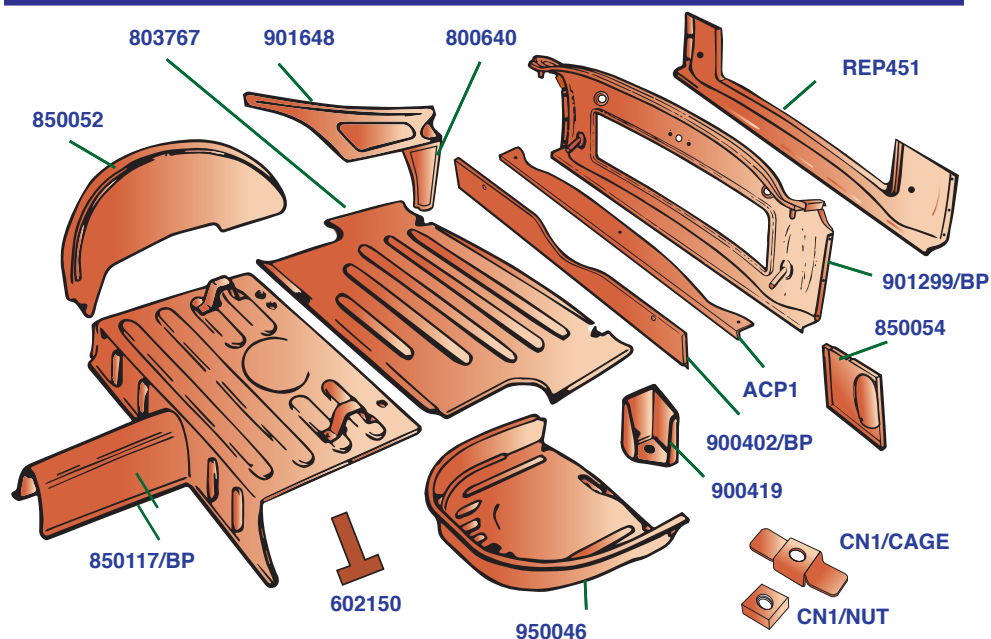

Part No.	Description	No.Off	List Price	Your Price
----------	-------------	--------	------------	------------

REAR BODY DETAILS, after comm.

no. TS60000

850117/BP	Rear Floor Assembly , with drive shaft tunnel	1		
803767	Trunk Floor Assembly	1		
850051	Wheel Arch , LH	1		
901647	TRUNK SIDE , LH; includes lower portion to bottom of rear apron	1		
800639	Repair Section , closing panel, rear apron, LH	1		
850052	Wheel Arch , RH	1		
901648	TRUNK SIDE , RH; includes lower portion to bottom of rear apron	1		
800640	Repair Section , closing panel, rear apron, RH	1		
950046	Container , spare wheel	1		
901299/BP	REAR APRON , outer panel, with separate signal lamp pressings	1		
ACP1	Repair Panel , rear apron bottom flange	1		
REP451	Repair Panel , rear apron bottom section	1		
900402/BP	Rail , back bottom	1		
850054	Panel , closing, rear apron, front, LH	1		Use 900421
850055	Panel , closing, rear apron, front, RH	1		Use 900422
900419	Bracket , body mounting, LH	1		
900420	Bracket , body mounting, RH	1		
CN1/CAGE	Cage , for captive nuts	A/R		
CN1/NUT	Nut , in cage	A/R		
602150	Clip , wiring harness, welded to panels	A/R		Suggest 603559

BODY SHEET METAL COMPONENTS

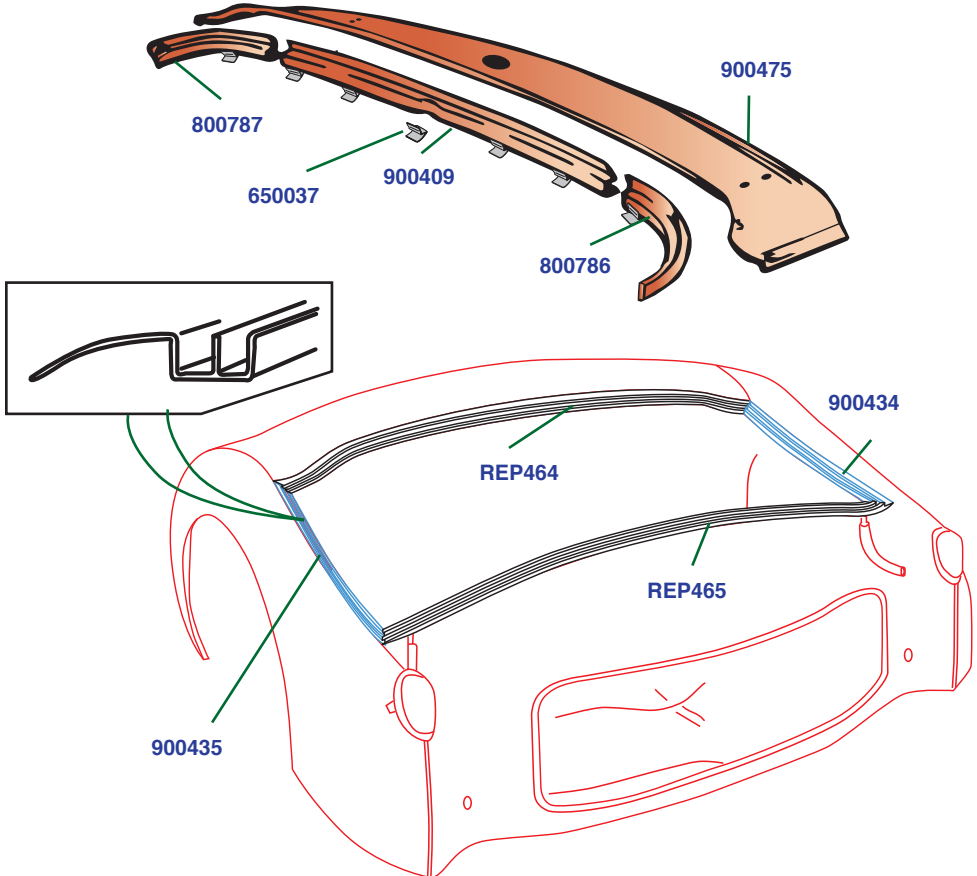
BODY SHELL—TONNEAU SADDLE AND DRIP CHANNELS, TR2, TR3, TR3A MODELS, UP TO COMM. NO. TS60000

Part No.	Description	No.Off	List Price	Your Price
900475	Tonneau Saddle Panel , fitted up to comm. no. TS60000	1		
TONNEAU RAIL DETAILS , up to comm. no. TS60000				
800786	Tonneau Rail , side section, LH	1		
800787	Tonneau Rail , side section, RH	1		
900409	Tonneau Rail , center section	1		
650037	Clip , spring, securing rear bulkhead trim panel; clips welded to tonneau rail; one clip may be loose for riveting to bulkhead board; this may vary with specific models (602379)	7		
DRIP CHANNEL DETAILS , fitted up to comm. no. TS60000				
REP464	Repair Section , drip channel, rear edge of tonneau saddle	1		
900435	Drip Channel , trunk side, LH	1		
900434	Drip Channel , trunk side, RH	1		
REP465	Repair Section , drip channel, front edge of rear apron	1		

BODY SHEET METAL COMPONENTS

BODY SHELL—TONNEAU SADDLE AND DRIP CHANNELS, TR3A, TR3B MODELS, AFTER COMM. NO. TS60000

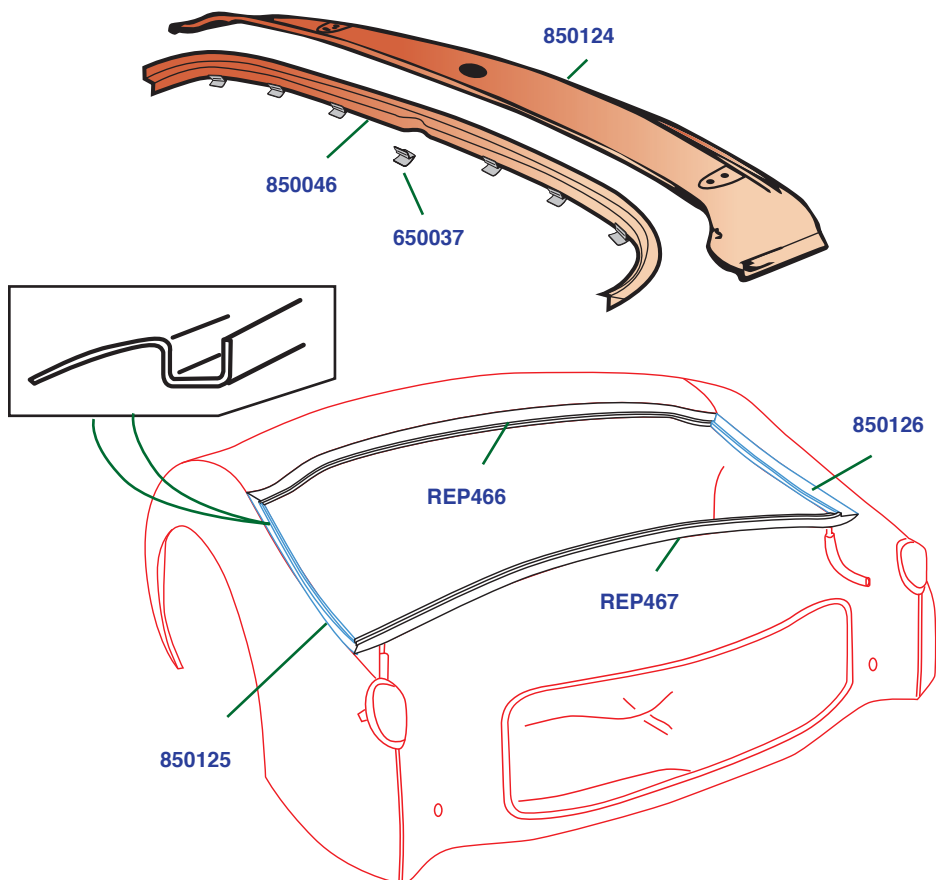

Part No.	Description	No. Off	List Price	Your Price
850124	Tonneau Saddle Panel , fitted after comm. no. TS60000	1		
	TONNEAU RAIL DETAILS , after comm. no. TS60000			
850046	TONNEAU RAIL ASSEMBLY	1		
650037	Clip , spring, securing interior rear bulkhead trim panel; six clips welded to tonneau rail, and one clip riveted to bulkhead board and secured to tonneau rail with a screw	7		
	DRIP CHANNEL DETAILS , fitted after comm. no. TS60000			
REP466	Repair Section , drip channel, rear edge of tonneau saddle	1		
850125	Drip Channel , LH	1		
850126	Drip Channel , RH	1		
REP467	Repair Section , drip channel, front edge of rear apron	1		

BODY SHEET METAL COMPONENTS

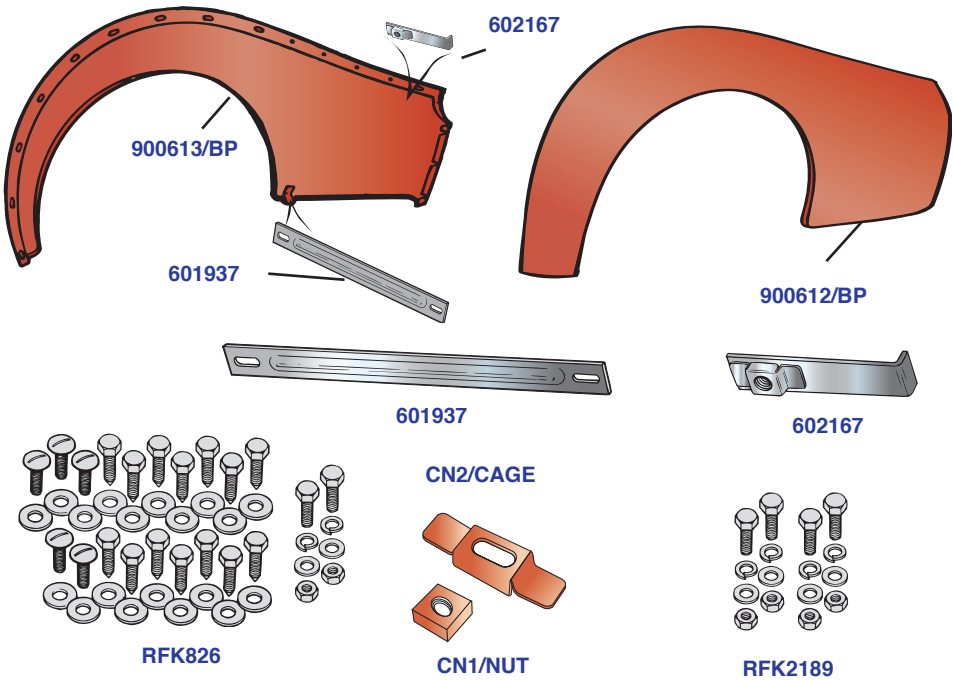
BODY SHELL—REAR WINGS (FENDERS), REAR
QUARTER PANELS, TR2, TR3

Part No.	Description	No. Off	List Price	Your Price
REAR FENDERS (WINGS); excellent quality, manufactured on new tooling				
900612/BP	Rear Fender , steel replica, LH	1		
900612/AL	Rear Fender , light weight alloy, LH	1		
900613/BP	Rear Fender , steel replica, RH	1		
900613/AL	Rear Fender , light weight alloy, RH	1		
HARDWARE , mounting rear fenders				
RFK826	HARDWARE KIT , mounting rear fenders, including hardware for support stays (forty-six pieces)	2		
552433	Bolt , slotted mushroom head	10		
HU706P	Screw , set, hex head	28		
WM57	Washer , body	38		
HU705	Screw , set, hex head, securing stays	4		
WP23	Washer , plain, on screws	4		
WL207	Washer , lock, on screws	4		
HN2007	Nut , hex, on screws	4		
602167	Plate , clamping, not included in kit	2		
CN2/CAGE	Cage , nut, welded to fenders	5		
CN1/NUT	Nut , in cage	5		
601937	Stay , supporting fenders to chassis	2		
RFK2189	Hardware Kit , securing support stays (sixteen pieces)	1		

Continued on Next Page

BODY SHEET METAL COMPONENTS

BODY SHELL—REAR WINGS (FENDERS), REAR QUARTER PANELS, TR2, TR3—Continued

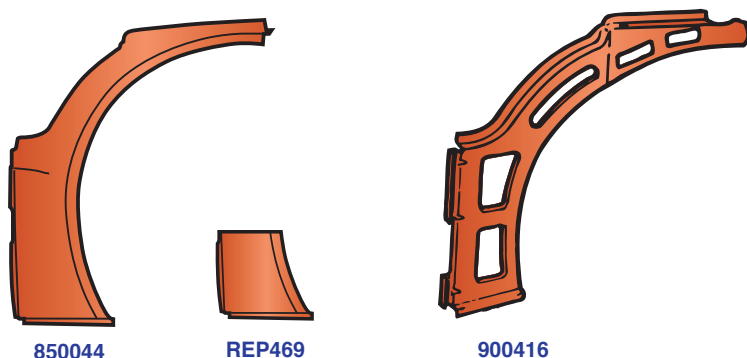

Part No.	Description	No.Off	List Price	Your Price
OUTER REAR QUARTER PANELS;				
	excellent quality, manufactured on new tooling			
850043	Panel , quarter, outer, LH, steel	1		
REP468	Repair Panel , rear quarter panel, lower portion, LH	1		
850044	Panel , quarter, outer, RH, steel	1		
REP469	Repair Panel , rear quarter panel, lower portion, RH	1		
INNER REAR QUARTER PANELS				
900415	Panel , quarter lining, LH, fitted up to comm. no. TS60000	1		
950035	Panel , quarter lining, LH, fitted after comm. no. TS60000	1		
900416	Panel , quarter lining, RH, fitted up to comm. no. TS60000	1		
950036	Panel , quarter lining, RH, fitted after comm. no. TS60000	1		

BODY SHEET METAL COMPONENTS

BONNETS, DOORS, TRUNK LIDS, TR2, TR3B

These listings are rather complicated in some respects, as the spare parts catalogue indicates certain nominal change points, but in actual practice on the assembly line, changes may have overlapped with existing practice so that cars with lower commission numbers may have included the change while cars after the change point may have had the earlier fitment. Also, changes may have happened to a part without actually changing the part number. An example seems to be the early TR2 bonnet in aluminium which carried the same part number as the steel version fitted later.

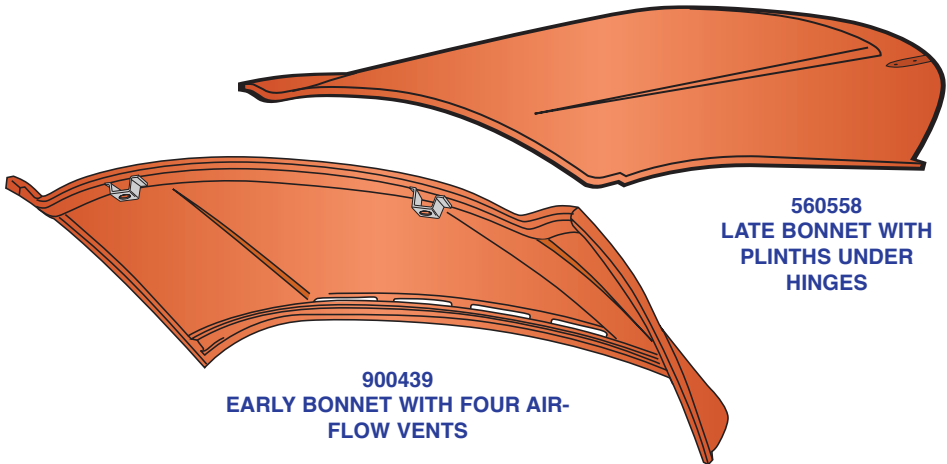

Part No.	Description	No.Off	List Price	Your Price
BONNETS —Mr. Piggott identifies seven bonnet variations, but there are only four Triumph part numbers in the spare parts catalogue				
900439	Bonnet Assembly , utilizing twin cable-operated latches, fitted from comm. no. TS1 up to TS4228, material was aluminium up to around TS580 and steel thereafter, included four air-flow slots on ridge across rear	1		
900666	Bonnet Assembly , latches utilizing Dzus fasteners, fitted from comm. TS4229 up to TS6157, material is steel, included four air-flow slots on ridge across rear; some may have been fitted with two rivets at rear edge	1		
900705	Bonnet Assembly , Dzus latching, fitted from comm. no. TS6158 up to TS22530, material is steel, included only two air-flow slots on ridge across rear, rear edge included a flange	1		
901272	Bonnet Assembly , Dzus latching, fitted from comm. no. TS22531 up to TS60000, material is steel, two air-flow slots, flange removed from rear edge	1		
560558	Bonnet Assembly , Dzus latching, fitted after comm. no. TS60000, material is steel, two air-flow slots, “plinth” pressings added under hinges to match corresponding plinths on the body	1		

Continued on Next Page

BODY SHEET METAL COMPONENTS

BONNETS, DOORS, TRUNK LIDS, TR2, TR3B

—Continued

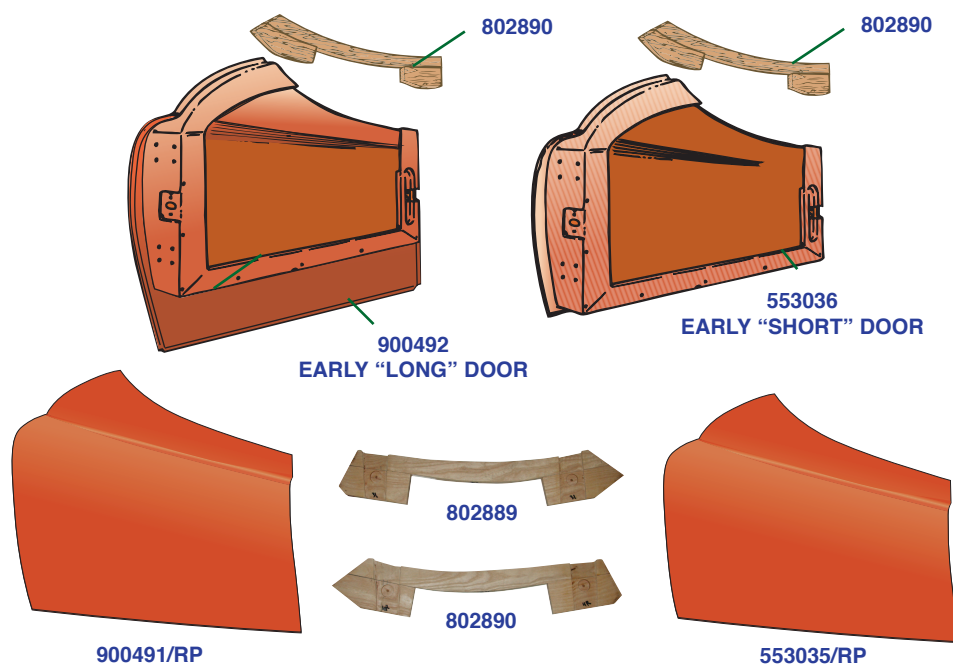

Part No.	Description	No. Off	List Price	Your Price
----------	-------------	---------	------------	------------

DOORS—Full length doors were fitted to the earliest TR2 models, but shortened after comm. no. TS4001 to allow easier parking on streets with kerbs; earlier doors did not have outside handles, later ones did; brass hinges were fitted earlier and steel ones to the latest models; door skins may be used to repair many doors with rust repair or other damage

DOORS, long-door type, fitted from comm. no. TS1 up to TS4001, no outside door handles, use brass hinges

900491	DOOR ASSEMBLY, LH	1		
900491/RP	Repair Panel , door skin, LH	1		
802889	Door Top Rail , LH door, wooden part; includes side curtain mounting blocks	1		
900492	DOOR ASSEMBLY, RH	1		
900492/RP	Repair Panel , door skin, RH	1		
802890	Door Top Rail , RH door, wooden part; includes side curtain mounting blocks	1		

DOORS, short-door type, fitted from comm. no. TS4002 up to TS22014, no outside door handles, use brass hinges

553035	DOOR ASSEMBLY, LH	1		
553035/RP	Repair Panel , door skin, LH	1		
802889	Door Top Rail , LH door, wooden part; includes side curtain mounting blocks	1		
553036	DOOR ASSEMBLY, RH	1		
553036/RP	Repair Panel , door skin, RH	1		
802890	Door Top Rail , RH door, wooden part; includes side curtain mounting blocks	1		

Continued on Next Page

BODY SHEET METAL COMPONENTS

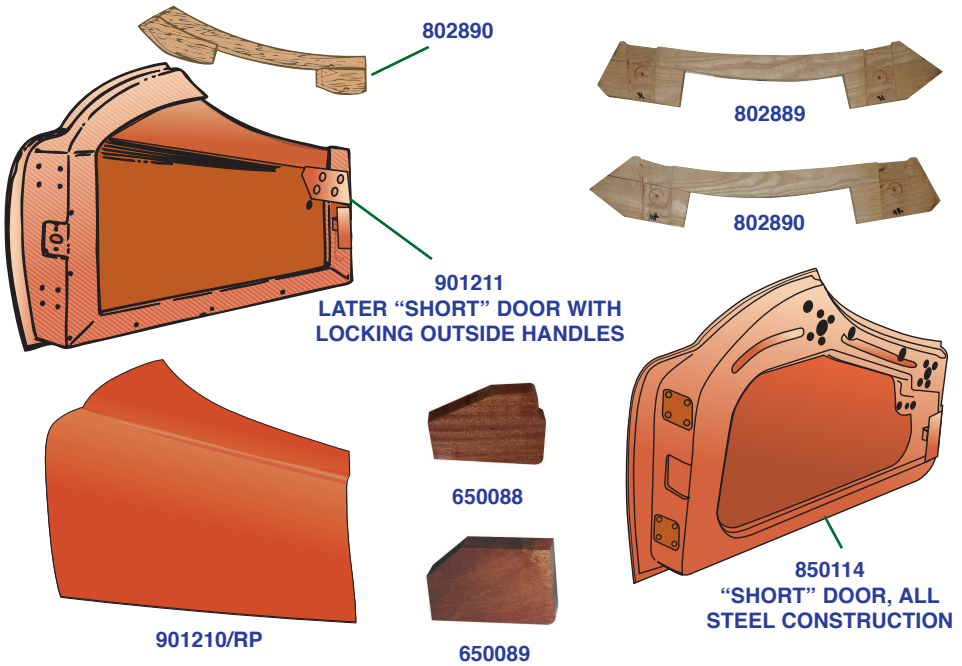
BONNETS, DOORS, TRUNK LIDS, TR2, TR3B
—Continued

Part No.	Description	No.Off	List Price	Your Price
----------	-------------	--------	------------	------------

DOORS—Continued

DOORS, short-door type, fitted from comm. no. TS22014 up to TS60000, locking outside handles fitted, brass hinges were used with these doors up to body no. EB54335

901210	DOOR ASSEMBLY, LH	1		
901210/RP	Repair Panel , door skin, LH	1		
802889	Door Top Rail , LH door, wooden part; includes side curtain mounting blocks	1		
901211	DOOR ASSEMBLY, RH	1		
901211/RP	Repair Panel , door skin, RH	1		
802890	Door Top Rail , RH door, wooden part; includes side curtain mounting blocks	1		

DOORS, short-door type, fitted after comm. no. TS60000, locking outside handles fitted, steel hinges were used with these doors; doors were all-steel construction without wood top rail; wood mounting blocks for side curtains remained, rounded, rather than right-angled lower rear corner on inside frames

850113	DOOR ASSEMBLY, LH	1		
850114	DOOR ASSEMBLY, RH	1		
901210/RP	Repair Panel , LH	1		
901211/RP	Repair Panel , RH	1		
650088	Block , wood, side curtain mount, front	2		
650089	Block , wood, side curtain mount, rear	2		

Continued on Next Page

BODY SHEET METAL COMPONENTS

BONNETS, DOORS, TRUNK LIDS, TR2, TR3B —Continued

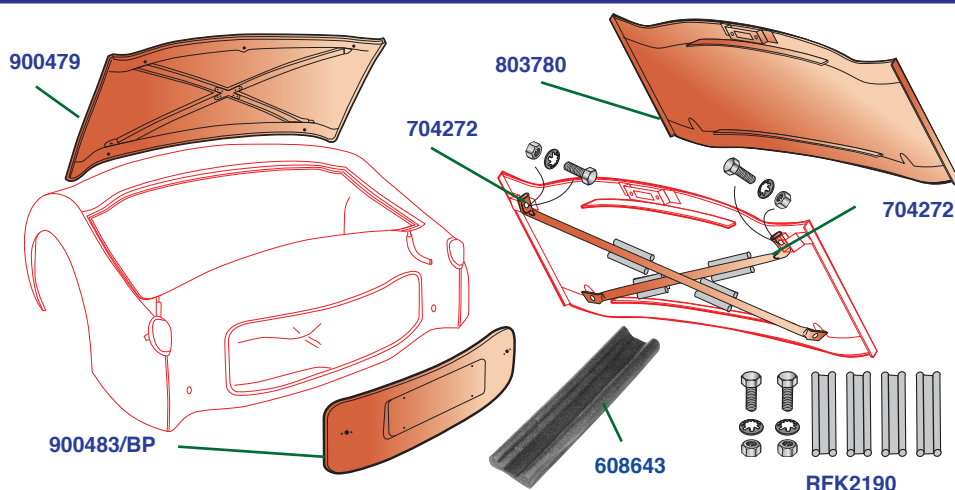

Part No.	Description	No. Off	List Price	Your Price
----------	-------------	---------	------------	------------

TRUNK LIDS; aka “Boot Lids,”—Earlier trunk lids were assemblies with the reinforcements welded to the skins; a simpler design appeared at comm. no. TS60000, with bolted tubes taking the place of the welded reinforcements

900479	Trunk Lid Assembly, fitted from comm. no. TS1 up to TS22014 (TS23920); this type is secured with budget locks covered with flip-up escutcheons and operated with the T-handle Coach Key; a central surface-mounted key lock is also fitted for security	1		
--------	--	---	--	--

802637	Trunk Lid Assembly, fitted from comm. no. TS22014 (TS23920) up to TS60000; budget locks and key lock deleted in favour of a locking handle assembly	1		
--------	--	---	--	--

TRUNK LID ASSEMBLY, fitted after comm. no. TS60000

803780	Trunk Lid Skin Assembly, with hinge plinth pressing	1		
--------	--	---	--	--

704272	Tube, reinforcement, LH	1		
--------	--------------------------------	---	--	--

704272	Tube, reinforcement, RH	1		
--------	--------------------------------	---	--	--

RFK2190	FITTING KIT, securing tubes to angles welded to rear of trunk lid skin (front mountings are to trunk hinge studs); ten pieces including rubber packings	1		
---------	--	---	--	--

HU705	Screw, set, hex head	2		
-------	-----------------------------	---	--	--

WE607	Washer, shakeproof	2		
-------	---------------------------	---	--	--

HN2007	Nut, hex	2		
--------	-----------------	---	--	--

608643	Packing, rubber, anti-rattle, cemented to trunk lid skin	4		
--------	---	---	--	--

SPARE WHEEL (TIRE) LIDS; these were manufactured in aluminium up to about comm. no. TS580, and in steel thereafter, apparently under the same part number

900483/BP	Spare Wheel Lid Assembly, steel replica	1		
-----------	--	---	--	--

BODY SHEET METAL COMPONENTS

NEW RANGE OF INNER AND OUTER PANELS

Over the past couple of years a European source has begun to produce a new range of popular inner and outer panels with the goal of reaching the standard of original Triumph parts or better. We have listed these among the other listings in the sections of this chapter. Generally, we add the suffix “BP” to the part numbers of these components. We have included photos of these better panels on this page. All of them come well-packaged and presented in high-quality primer. Generally we will try to maintain stocks of these, and they are supplied fairly quickly even when we run out.



900412
EARLY TRUNK FLOOR
PAGE 128



803767
LATE TRUNK FLOOR
PAGE 129



900615
TRUNK SIDE
PAGE 128



901270/BP
FRONT FENDER
PAGE 126



900612/BP
REAR FENDER
PAGE 132



REP224
FRONT FENDER
REPAIR PANEL
PAGE 126



850043
REAR
QUARTER
PANEL
PAGE 133



850044
REAR APRON, TR2
PAGE 128



900477/BP
REAR APRON, TR3A, TR3B
PAGE 129