

CLUTCH

FLYWHEEL RING GEARS, TR2, TR3

Early ring gears were a press fit on the flywheel, but later ones were secured by bolts and lock plates. The factory catalogue does not give a change point, but I assume it was at TS50000 when the starter was also updated.

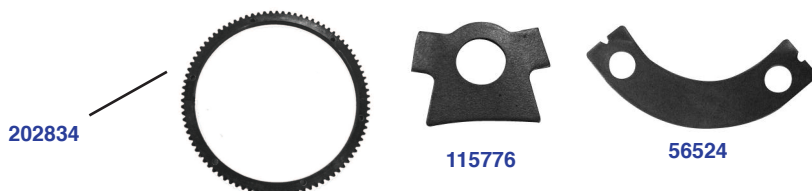

Part No.	Description	No.Off	List Price	Your Price
201454	Ring Gear , press-fit type, TR2, TR3, TR3A, up to comm. no. TS50000	1		
202834	Ring Gear , bolt-on type, TR3A, TR3B, after comm. no. TS50000 HARDWARE , securing late ring gear to flywheel	1		
112653	Bolt	6		
115776	Plate , locking bolts	6		
RFK1856	HARDWARE , securing flywheel to crankshaft	1		
DP608	Dowel , locating flywheel	1		
102065	Screw , set, original for TR2, TR3	4		
56524	Plate , locking set screws	2		
138527	Screw , set, TR4A type; does not use locking plates; not included in kit	4		

LOWER BELL HOUSING COVER, TR2, TR3

This is the plate mounted on the lower portion of the bell housing to protect the clutch from water and road debris. Considering the amount of oil that usually leaks into this area, it is unlikely that it is rusted, but it may be missing as the result of lazy workmanship after previous repairs. New plates are available in stainless steel.

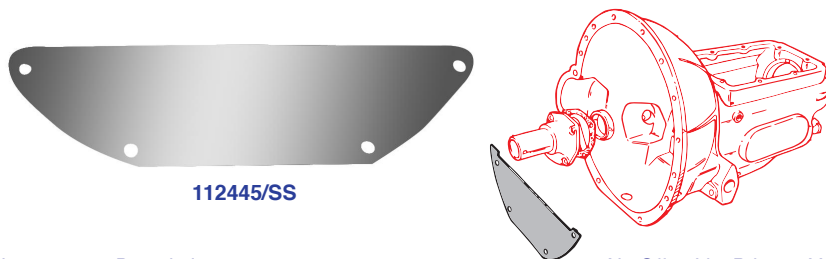

Part No.	Description	No.Off	List Price	Your Price
112445/SS	Cover , bell housing, lower	1		
RFK1841	HARDWARE KIT , securing lower bell housing cover to gearbox; includes 4 set screws, 4 lock washers, and 4 hex nuts	1		

CLUTCH

CLUTCH KITS, TR2, TR3

TRF supplies clutch pressure plates and driven plates still manufactured by the original manufacturer to Triumph, and we supply an uprated throw-out bearing with which we have had very good success—it will last much longer than original bearings.

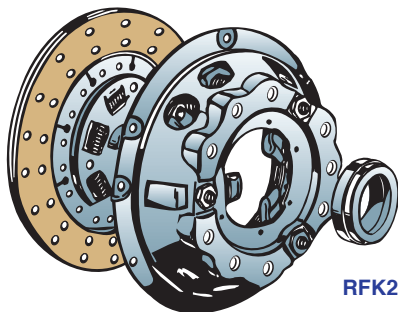

RFK225

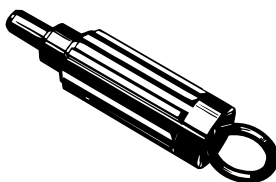

KB33-19



HP222



100159

Part No.	Description	No.Off	List Price	Your Price
RFK225	CLUTCH KIT , three-piece, supplied with clutch alignment tool, all TR2, TR3, TR3A, TR3B	1		
70380	Pressure Plate , brand new	1		
116638	Driven Plate , brand new	1		
HP222	Throw-out Bearing , uprated bearing for longer life	1		
KB33-19	Tool , clutch alignment	1		
RFK2145	THROW-OUT BEARING AND SLEEVE ASSEMBLY , all TR2, TR3, TR3A, TR3B	1		
100159	Sleeve , bronze, throw-out bearing	1		
HP222	Throw-out Bearing , uprated for longer life	1		
RFK1838	HARDWARE KIT , securing clutch to flywheel, all TR2, TR3, TR3A, TR3B	1		
DP408	Dowel , locating pressure plate on flywheel	2		
HU856	Screw , set	6		
WL208	Washer , lock	6		

CLUTCH

CLUTCH MECHANICALS, TR2, TR3

Worn mechanical components can lead to clutch failure, and at TRF, we replace all of the components listed in this section with each new clutch. That is insurance...

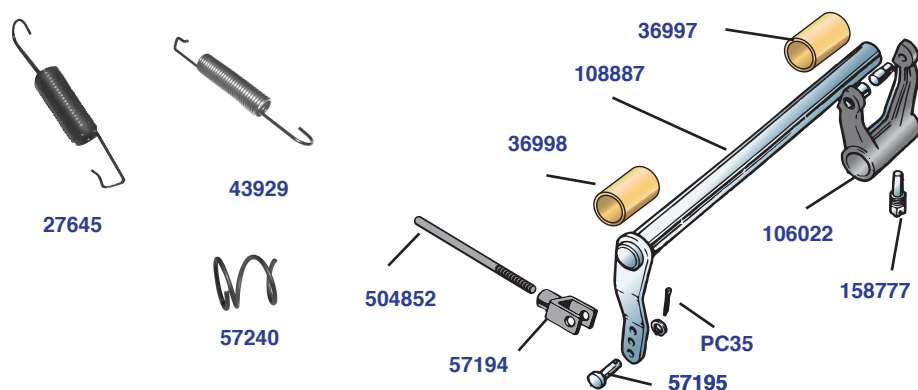

Part No.	Description	No.Off	List Price	Your Price
RFK2146	CLUTCH CROSS-SHAFT KIT , complete	1		
108887	Clutch Cross Shaft , with lever	1		
LN30041	Grease Fitting , ends of cross-shaft	2		
WF507	Washer , fibre on grease fittings	2		
36998	Bush , cross-shaft, pressed into LH side of bell-housing	1		
36997	Bush , cross-shaft, slotted, pressed into RH side of bell-housing	1		
106022	Fork , throw-out bearing	1		
158777	Taper Pin , locking fork to cross-shaft; do not overtighten, and secure with lock wire	1		
30047	Wire , securing taper pin	1		
	PUSH-ROD DETAILS , clutch slave cylinder			
501199	Push Rod , Lockheed slave cylinder, fitted up to comm. no. TS13045	1		
504852	Push Rod , Girling slave cylinder, fitted after comm. no. TS13045	1		
57193	FORK-END KIT , fits both Lockheed and Girling push rods	1		
57194	Fork End	1		
57195	Clevis Pin	1		
57240	Spring , on clevis pin	1		
PC35	Cotter Pin , securing clevis pin	1		
JN2108	Nut , jam, locking fork-end on push rod	1		
106347	Plate , anchoring return spring, fitted on clevis pin	1		
27645	Spring , push rod return, Lockheed slave cylinders, up to comm. no. S13045	1		
43929	Spring , push rod return, Girling slave cylinders, after comm. no. TS13045	1		

CLUTCH

CLUTCH HYDRAULICS—LOCKHEED COMPONENTS, TR2, EARLY TR3, 1954-56

New master cylinders are now available for this application, but they do not appear identical to original components, and fitting them requires an adaptor kit. This is probably not the most desirable option for a concours enthusiast, but we are listing the new master cylinders along with rebuild kits for original ones.

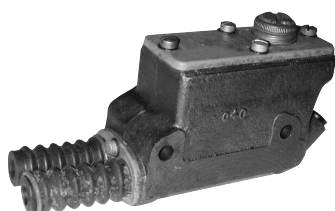

201821/REP



33084



109746/REP



HK71527



LDHAP5136



HK71507



501194

Part No.	Description	No.Off	List Price	Your Price
201821/REP	Master Cylinder Replacement , brake and clutch; appearance is not original, but it may be fitted using the adaptor kit provided	1		
	REBUILD KITS FOR ORIGINAL MASTER CYLINDERS			
HK71527	Repair Kit , brake and clutch master cylinders	1		
501194	Boot , rubber, push rod, not included in repair kit	2		
	CLUTCH SLAVE CYLINDER ; it is unclear if rebuild kit will repair replacement cylinder			
109746/REP	Slave Cylinder , replacement	1		
HK71507	Repair Kit , for original Lockheed slave cylinders	1		
	CLUTCH PIPES AND HOSES , 1954-56			
108218	Pipe Assembly , master cylinder to bracket on chassis frame	1		
33084	Clip , folded, brass, securing pipe to body	1		
YA583	Screw , securing clip to body	1		
LDHAP5136	Hose , flexible, clutch slave cylinder	1		
500463	Washer , copper, hose to slave cylinder	1		

CLUTCH

CLUTCH HYDRAULICS—GIRLING COMPONENTS, LATER
TR3, TR3A, TR3B, 1957-63

Later cars with Girling brand brake and clutch systems used separate but identical master cylinders for the brake and clutch systems.



130561/REP

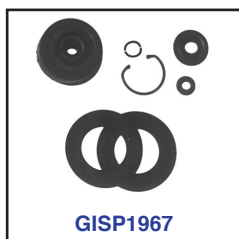

GISP1967



CNP203

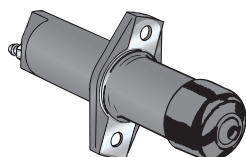

114531/REP



114530

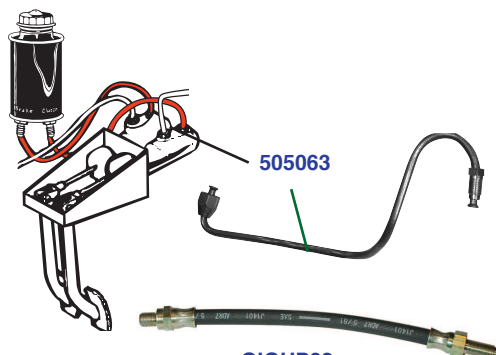

505063



HK2487



GIGHP82

Part No.	Description	No. Off	List Price	Your Price
----------	-------------	---------	------------	------------

MASTER CYLINDERS AND REPAIR KITS

130561/REP	Master Cylinder , clutch	1		
GISP1967	Repair Kit , clutch master cylinder, Girlinging brand	1		

FLUID RESERVOIR CANS

114530	Fluid Reservoir Can , clutch and brake	1		
CNP203	Label , Girling, for reservoir can	1		

SLAVE CYLINDERS

114531/REP	Slave Cylinder	1		
HK2487	Repair Kit , aftermarket brand	1		

CLUTCH PIPES AND HOSES, 1957-62

505063	Pipe , reservoir can to clutch master cylinder, pre-bent	1		
507201	Pipe , clutch master cylinder to hose bracket	1		
GIGHP82	Hose , flexible, slave cylinder	1		
RFK1839	HARDWARE KIT , slave cylinder hose	1		
JN2109	Nut , jam	1		
WN709	Washer , shakeproof	1		
233220A	Washer , copper	1		

CLUTCH

CLUTCH AND BRAKE PEDAL PADS, TR2, TR3

We currently purchase the early pads in England, and they appear rather cheesy to this writer, but I have not yet been able to compare them with originals. TRF manufactures the late pads, and they are superb, just the right hardness. I will study the early pads more closely when the opportunity permits.

105159



122289

Part No.	Description	No.Off	List Price	Your Price
105159	Rubber Pad , clutch or brake pedal, earlier type; may have been fitted up to comm. no. TS13045	2		
122289	Rubber Pad , clutch or brake pedal, later type; probably better for earlier cars as well if they are driven very much	2		

HYDRAULIC CLUTCH FLUID

TRF stocks both traditional Castrol fluid and silicone brake fluid. Silicone fluid is popular with enthusiasts, partly because it does not remove paint if spilled accidentally. Some manufacturers of hydraulic cylinders refuse to honour warranties if silicone fluid has been used, but as far as we know, its use does not lead to failures. Castrol fluid will not void your warranty, but it is a very effective paint remover, and I doubt that any warranty on a master cylinder will cover a paint job. My own TR3 uses Crimson, an older version of the Castrol fluid which was current at the time, and it has leaked, removing paint...



GILMA



SBF32

Part No.	Description	No.Off	List Price	Your Price
GILMA	Castrol Hydraulic Fluid , DOT4, 12 oz. container	A/R		
SBF32	Blue Magic Silicone Fluid , 32 oz. container (please read above)	A/R		

GEARBOX

GEARBOX—INDIVIDUAL COMPONENTS, TR2, TR3, ETC.

TR2, TR3, and TR3A models were fitted with three-synchro gearboxes which some owners have replaced with TR4 gearboxes, as used in most TR3B models. And, it is even possible that the gearbox in a TR2 or TR3 might have come from a TR4A, TR250, or TR6. Any of these can be made to work. Therefore, the first thing you need to find out if you are thinking of serious gearbox work is: What gearbox do you have? Some components are common to all of the big TR gearboxes, and I will list these here along with some components applicable only to specific models. You can get further advice on the TRF Tech Line.

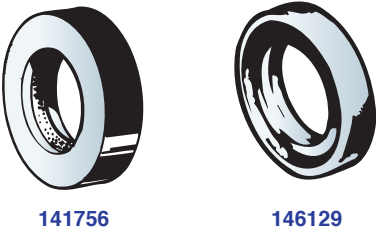
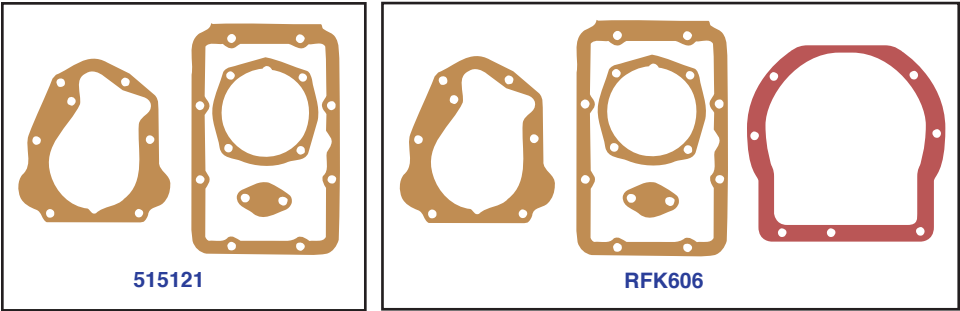

Part No.	Description	No.Off	List Price	Your Price
GASKET SETS AND OIL SEALS, applicable to all TR2 through TR6 gearboxes				
515121	Gasket Set, non-overdrive gearbox	1		
RFK606	Gasket Set, A-type overdrive gearbox, fits TR2-TR6	1		
141756	Seal, oil, fitted in front-end cover	1		
146129	Seal, oil, fitted in rear extension	1		

Continued on Next Page

GEARBOX

GEARBOX—INDIVIDUAL COMPONENTS, TR2, TR3, ETC.
—Continued

58391

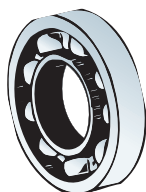

SP75G



129940



129939



55911



113431



55707



145008

Part No.	Description	No.Off	List Price	Your Price
MAINSHAFT PARTS , applicable to all				
TR2 through TR6 gearboxes or as indicated				
58391	Bearing , mainshaft front and center, original RHP brand—best one to use	2		
58391Z	Bearing , mainshaft front and center, less-expensive aftermarket brand	2		
SP75G	Bearing , mainshaft rear, non-overdrive gearboxes	1		
129940	Bush , bronze, inside 3rd gear, 3-synchro gearboxes—not latest TR6 gearboxes	1		
129940	Bush , bronze, inside 1st and 3rd gears, 4-synchro gearboxes—not latest TR6 gearboxes	2		
129939	Bush , bronze, “top-hat,” inside 2nd gear —not latest TR6 gearboxes	1		
113431	Synchronizer Cup , 2nd, 3rd, 4th gears, 3-synchro gearboxes	3		
113431	Synchronizer Cup , 1st, 2nd, 3rd, 4th gears, 4-synchro gearboxes	4		
55911	Bush , bronze, inside constant pinion gear, early 3-synchro gearboxes	1		
145008	Needle Bearing Assembly , inside constant pinion gear, later 3-synchro, gearboxes and all but the very latest TR6 4-synchro gearboxes	1		
55707	Circlip , mainshaft, retaining 3rd gear, all TR2 through TR6 gearboxes	1		

Continued on Next Page

GEARBOX

GEARBOX—INDIVIDUAL COMPONENTS, TR2, TR3, ETC.
—Continued

Part No.	Description	No.Off	List Price	Your Price
----------	-------------	--------	------------	------------

INTERLOCK AND DETENT DETAILS,

mainshaft sliders

106106	Plunger , interlock, first gear sleeve	1		
BL16	Ball , over plunger, first gear sleeve	1		
122075	Spring , detent, first gear sleeve	3		
BL16	Ball , over spring, first gear sleeve	3		
122075	Spring , detent, 3rd/4th gear sleeve	3		
BL16	Ball , over spring, 3rd/4th gear sleeve	3		

COUNTERSHAFT PARTS, 3-synchro

gearboxes

108168	Countershaft	1		
105625	Gear , first speed, countershaft	1		
58088	Needle Bearing Kit , 48 needle bearings	1		
129955	Thrust Washer , front of countershaft	1		
129956	Thrust Washer , rear of countershaft	1		

COUNTERSHAFT PARTS, 4-synchro

gearboxes, TR4, TR4A

128105	Countershaft , high-quality	1		
128107	Gear , countershaft, first and reverse	1		
126862/L	Needle Bearing Assembly , pressed into countershaft gear	2	.	.
129955	Thrust Washer , front of countershaft	1		
129956	Thrust Washer , rear of countershaft	1		

GEARBOX

GEARBOX REBUILD KITS, TR2, TR3, TR4

“Please Read Intro, and Study Illustrations to Understand What Is Included in Kits”

TRF Gearbox Rebuild Kits are made up in-house of components we know and trust. A rebuild kit includes most of the parts you would want to change anytime you are making the effort required to pull a gearbox, to disassemble it, and to put it back together, completely clean and with all clearances checked and set by the book. Kits include gaskets, seals, bearings, countershafts and countershaft thrust washers, synchro cups, and mainshaft circlips. Select the kit you need based on the gearbox you have, realizing that your car may not have its original gearbox. Phone the TRF Tech Line if you need help in identifying your gearbox.

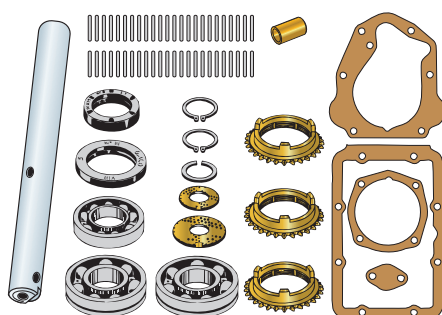

GRK3/E

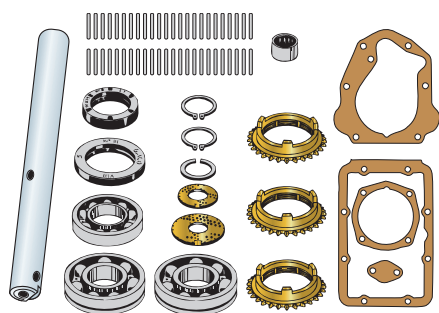

GRK3

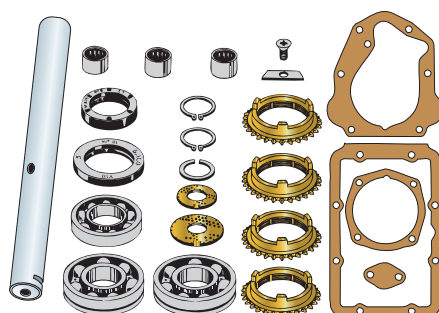

GRK4

Part No.	Description	No.Off	List Price	Your Price
GRK3/E	Gearbox Rebuild Kit , three-synchro gearboxes, with bronze bush inside constant pinion gear, TR2, TR3, early TR3A up to comm. no. TS27000 approx.	1		
GRK3	Gearbox Rebuild Kit , three-synchro gearboxes, with needle bearings inside constant pinion gear, later TR3A, some TR3B	1		
GRK4	Gearbox Rebuild Kit , four-synchro gearboxes, most TR3B, TR4, TR4A	1		

GEARBOX

GEARBOX—GL4 GEAR LUBE, TR2, TR3

GL4 gear lube is not generally available in auto parts stores, but it is the correct type for older gearboxes and differentials with yellow metal bushes and thrust washers. Commonly available lubes will actually damage these components. The lube listed here is formulated especially for classic cars with yellow metal components, and it is supplied by Brad Penn which operates out of the old Kendall refinery in Bradford, Pennsylvania, where Kendall, Wolf's Head, and Amalie oils were made. TRF sells one-thousand quarts of GL4 gear lube every year.



BPGL4



RFT131



155660



114774

Part No.	Description	No. Off	List Price	Your Price
BPGL4	Brad Penn GL4 Gear Lube , SAE 80W-90; supplied in quart containers with “needle” spouts	A/R		
OIL DRAIN AND FILL PLUGS				
114774	Plug , oil drain and fill, standard plug as original	A/R		
155660	Plug , oil drain, magnetic to pick up bits of metal in the gearbox oil	A/R		
RFT131	Combination Wrench , includes square socket for removing oil drain and fill plugs	A/R		



Removing a TR3 gearbox through the interior of the car.

GEARBOX

GEARBOX TOP COVER DETAILS, TR2, TR3

Give the top cover attention while your gearbox is apart. I have seen some baffling problems with perfectly rebuilt gearboxes which ended up being top cover problems. Read your workshop manual, and act on the instructions. Only a few basic parts are listed here...

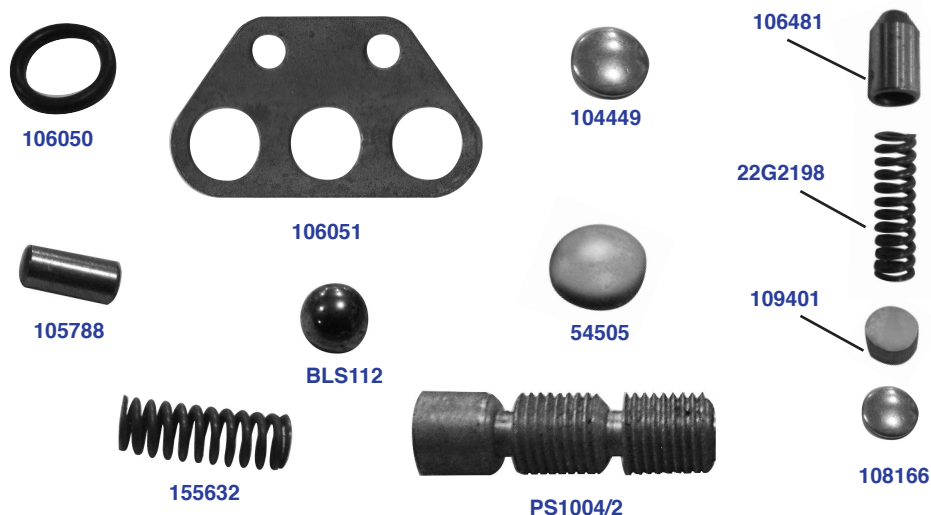

Part No.	Description	No.Off	List Price	Your Price
----------	-------------	--------	------------	------------

SELECTOR SHAFT SEALING DETAILS

106050	Ring , sealing, selector shafts	3		
106051	Plate , cover, over sealing rings	1		
HU704	Screw , securing cover plate	2		
WL207	Washer , lock, on screws	2		
104449	Plug , selector shafts, front of top cover	3		
54505	Plug , fitted in sides of top cover	2		

INTERLOCK DETAILS; these items prevent more than one gear being selected at the same time

105788	Plunger , interlock, fitted in center selector shaft	1		
BLS112	Ball , interlock, 1st/2nd and 3rd/4th selector shafts	2		
PS1004/2	Plug , interlock access, alloy, screwed; stick includes two plugs	1		

DETENT DETAILS, selector shafts, three-synchro gearboxes only

BLS112	Ball , selector shaft, forward gears	2		
155632	Spring , for balls, forward gears	2		
106481	Plunger , selector shaft, reverse	1		
22G2198	Spring , for plunger, reverse	1		
109401	Distance Piece , reverse plunger	1		
108166	Plug , retaining balls, springs, etc., threaded	3		

GEARBOX

GEARSHIFT BOOTS AND KNOBS, TR2, TR3

TRF manufactures these parts to original specification to help enthusiasts to maintain their cars in original condition.



Part No.	Description	No.Off	List Price	Your Price
112447	Lever , gearshift, fitted after comm. no. TS9593	1		
109045	Knob , gearshift lever, black with moulded shift emblem, screws onto lever, fitted after comm. no. TS2877	1		
109045/WRB	Knob , gearshift lever, walnut with Triumph shield emblem in red and black	1		
109045/WBW	Knob , gearshift lever, walnut with Triumph shield emblem in blue and white	1		
109047	Nut , chromed, locking knob to shift lever	1		
ANTI-RATTLE SPRINGS AND PLUNGER IN GEARSHIFT LEVER				
112424	Plunger	1		
106388	Spring , up to comm. no. TS9592	1		
122075	Spring , later TR3, TR3A, TR3B after comm. no. TS9592	1		
603065	Rubber Boot , gearshift lever	1		
RFK2147	HARDWARE KIT , securing gearbox cover, to floors and bulkhead	1		
HU706P	Screw , set, pointed	16		
WM57	Washer , plain	16		
CN1/CAGE	Cage , captive nut, welded to floors and bulkhead; not included in kit	A/R		
CN1/NUT	Nut , captive, square, in cages; not included in kit	A/R		

DRIVE SHAFT

DRIVE TRAIN—PROPELLOR SHAFT UNIVERSAL JOINTS, TR2, TR3

The Roadster Factory supplies genuine Hardy Spicer universal joints with grease fittings, now supplied in GKN boxes.

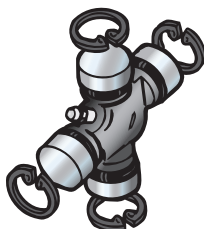
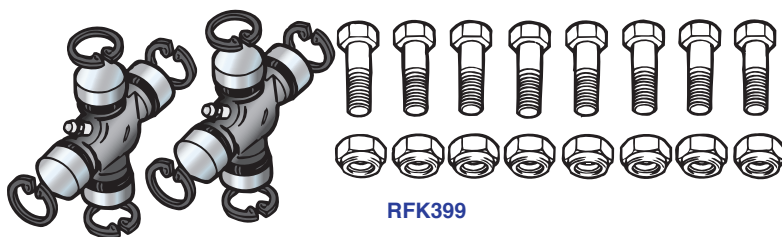

52406/A



Part No.	Description	No. Off	List Price	Your Price
52406	Universal Joint , Hardy Spicer brand, with grease fitting	2		
52406/A	Universal Joint , aftermarket brand, with grease fitting	2		
RFK399	DRIVE SHAFT KIT , TR2, TR3, TR3A, TR3B; includes universal joints and hardware for securing propellor shaft to gearbox flange and diff flange	1		
52406	Universal Joint , Hardy Spicer brand, with grease fitting	2		
107960	Bolt , flanges	8		
TN3209	Nut , nyloc, securing flange bolts	8		
GHF243	Nut , Clevloc, heavy-duty, alternative to TN3209; not included in kit	8		
SLP439	Cork Seal , sealing sliding joint, propellor shaft	1		

REAR AXLE

REAR AXLE AND HUBS, TR2, TR3

The highest quality brand-name components are stocked for rear axle repair and rebuilding. Most of what you need is listed here. Please inquire if you do not find anything you want.

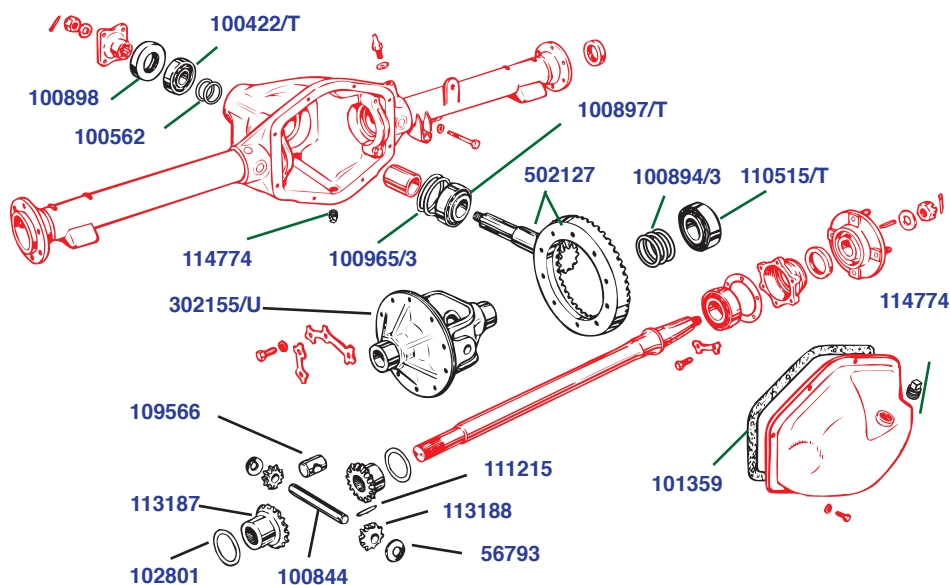

Part No.	Description	No.Off	List Price	Your Price
502127	Crown Wheel and Pinion Assembly, 3.7 : 1 ratio	1		
505014	Crown Wheel and Pinion Assembly, 4.1 : 1 ratio; usually fitted with overdrive	1		
302155/U	Carrier, differential, Girling axles; good used component	1		
113187	Gear, diff side, Girling axles	2		
102801	Thrust Washer, side gears	2		
113188	Gear, diff pinion, Girling axles	2		
56793	Thrust Washer, pinion gears, Girling axles	2		
100844	Cross Pin, pinion gears	1		
111215	Pin, securing cross pin in diff carrier	1		
RFK2148	DIFF BEARING AND SEAL KIT; includes brand name bearings for long life and reliable service	1		
100897/T	Bearing, pinion head, the one closest to the gear; always Timken brand	1		
100422/T	Bearing, pinion shank, the one furthest from the gear; always Timken brand	1		
100898	Oil Seal, differential pinion	1		
110515/T	Side Bearing, differential carrier; always Timken brand	2		
101359	Gasket, diff rear cover to casing	1		

See listings for Shims on following page

Continued on Next Page

REAR AXLE

REAR AXLE AND HUBS, TR2, TR3—Continued

Part No.	Description	No.Off	List Price	Your Price
	ADJUSTING SHIMS , pinion head bearing, placed between bearing race and diff casing to move pinion gear in relation to crown wheel			
100965/3	Shim , .003 inch		A/R	
100966/5	Shim , .005 inch		A/R	
100967/10	Shim , .010 inch		A/R	
	ADJUSTING SHIMS , pinion shank bearing, placed between bearing spacer and bearing to adjust preload			
100562	Shim , .003 inch		A/R	
100563	Shim , .005 inch		A/R	
100564	Shim , .010 inch		A/R	
	ADJUSTING SHIMS , diff carrier side bearings, placed between the side bearings and the diff casing to set the depth of engagement between the crown wheel and the pinion gear			
100894/3	Shim , .003 inch		A/R	
100895/5	Shim , .005 inch		A/R	
100896/10	Shim , .010 inch		A/R	
RFK2149	HARDWARE KIT , with gasket, securing rear axle cover, early and late axles	1		
101359	Gasket , rear axle cover	1		
HU805	Screw , set	8		
WL208	Washer , lock	8		
	PLUGS , oil filler and oil drain			
62058	Plug , oil filler, fitted up to comm. no. TS14823	1		
56912	Gasket , oil filler plug, fitted up to comm. no. TS14823	1		
114774	Plug , oil filler, fitted after comm. no. TS14823	1		
114774	Plug , oil drain, early and late axles	1		
155660	Plug , oil drain, magnetic, alternative to 114774; insure enough clearance exists	1		

Continued on Next Page

REAR AXLE

REAR AXLE AND HUBS, TR2, TR3—Continued

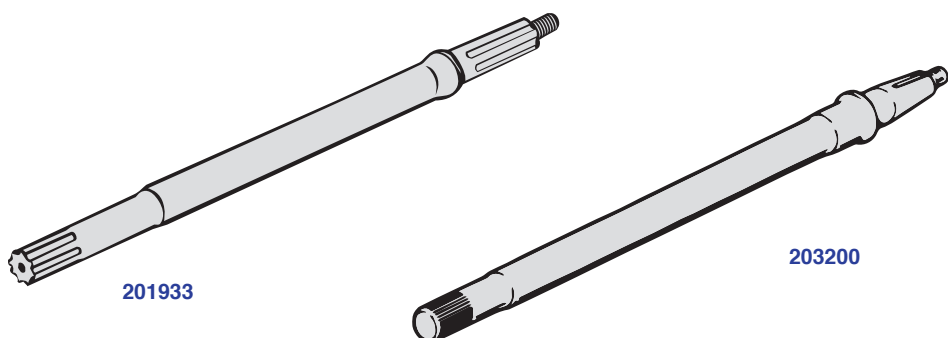

Part No.	Description	No.Off	List Price	Your Price
----------	-------------	--------	------------	------------

REAR AXLE SHAFTS

201933	Axle Shaft , TR2, TR3, up to comm. no. TS13045 (Lockheed brakes)	2		
203200	Axle Shaft , TR3, TR3A, after comm. no. TS13045 (Girling brakes)	2		

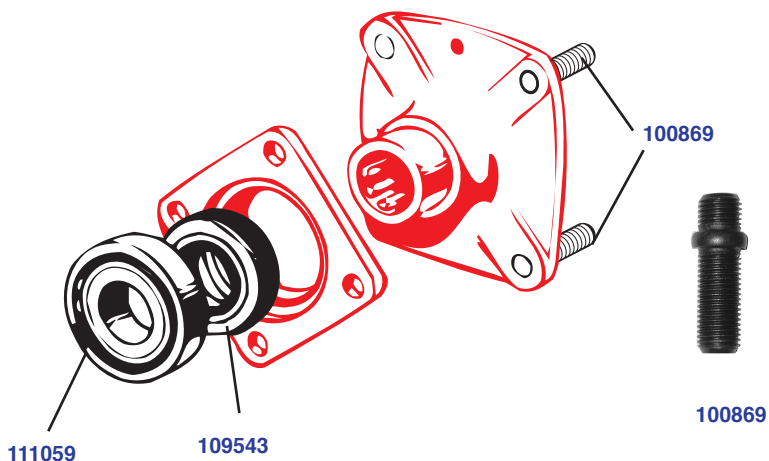

Part No.	Description	No.Off	List Price	Your Price
----------	-------------	--------	------------	------------

REAR HUB DETAILS, TR2, TR3, up to
comm. no. TS13045 (Lockheed brakes)

RFK806	BEARING AND SEAL KIT , rear hub	2		
111059	Bearing , rear hub	2		
109543	Seal , grease, rear hub	2		
	HARDWARE , securing rear hub bearing housing and brake back plate to axle flange			
59056	Bolt	8		
WP9	Washer , plain	8		
YN2909	Nut , nyloc	8		
100869	Stud , wheel, rear hubs, disc wheels only	8		

Continued on Next Page

REAR AXLE

REAR AXLE AND HUBS, TR2, TR3—Continued

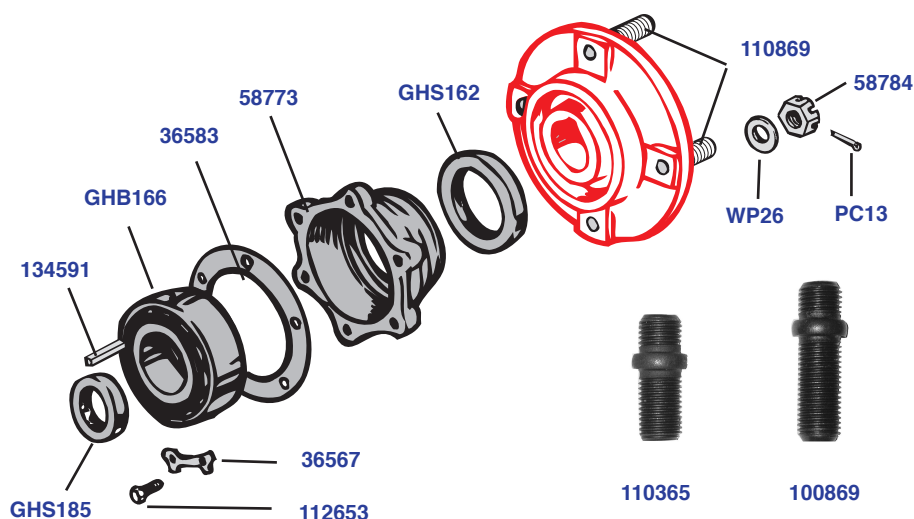

Part No.	Description	No.Off	List Price	Your Price
REAR HUB DETAILS, TR3, TR3A, TR3B, after comm. no. TS13045 (Girling brakes)				
58773	Housing , rear hub bearing	2		
RFK811	BEARING AND SEAL KIT , rear hub	2		
GHB166	Bearing , rear hub	2		
GHS185	Seal , oil, inner, fitted in axle tubes	2		
GHS162	Seal , oil, outer, fitted in bearing housings	2		
SHIMS , adjusting bearing end float				
36583	Shim , .006 inch	A/R		
38264	Shim , .008 inch	A/R		
36582	Shim , 1/64 inch	A/R		
36581	Shim , 1/32 inch	A/R		
HARDWARE , securing bearing housings and brake back plates to rear axle tubes				
112653	Bolt	12		
36567	Locking Plate	6		
STUDS , wheel, rear hubs				
100869	Stud , disc wheels	8		
110365	Stud , wire wheels	8		
RFK2150	HARDWARE KIT , securing hubs to rear axle shafts	2		
134591	Key , supersession for 110621	2		
WP26	Washer , plain	2		
58784	Nut , slotted	2		
PC13	Pin , Cotter	2		