

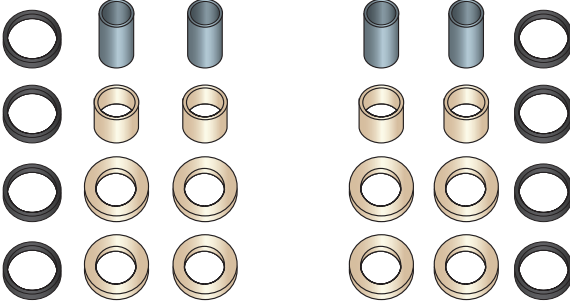
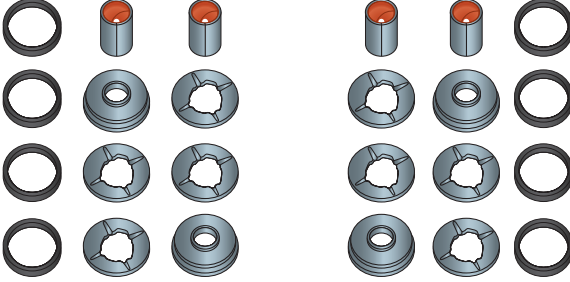

FRONT SUSPENSION AND STEERING

FRONT SUSPENSION—RE-BUSHING KITS, TR2, TR3

						Upper Wishbone Pivots
						Lower Wishbone Inner Pivots
						Lower Wishbone Outer Pivots
						Trunnion Seals
BK1						

Part No.	Description	No.Off	List Price	Your Price
	RE-BUSHING KITS , comprising upper, lower, inner, and outer suspension pivot bushes, washers, rubber rings, etc., all TR2, TR3, TR3A, TR3B			
BK1	Re-bushing Kit , with rubber bushes for upper wishbone inner pivots as original	1		
BK1/U	Re-bushing Kit , with urethane bushes for upper wishbone inner pivots	1		

FRONT SUSPENSION AND STEERING

FRONT SUSPENSION—FULCRUM PINS, BALL JOINTS, VERTICAL LINKS, TRUNNIONS, AND WISHBONES, TR2, TR3

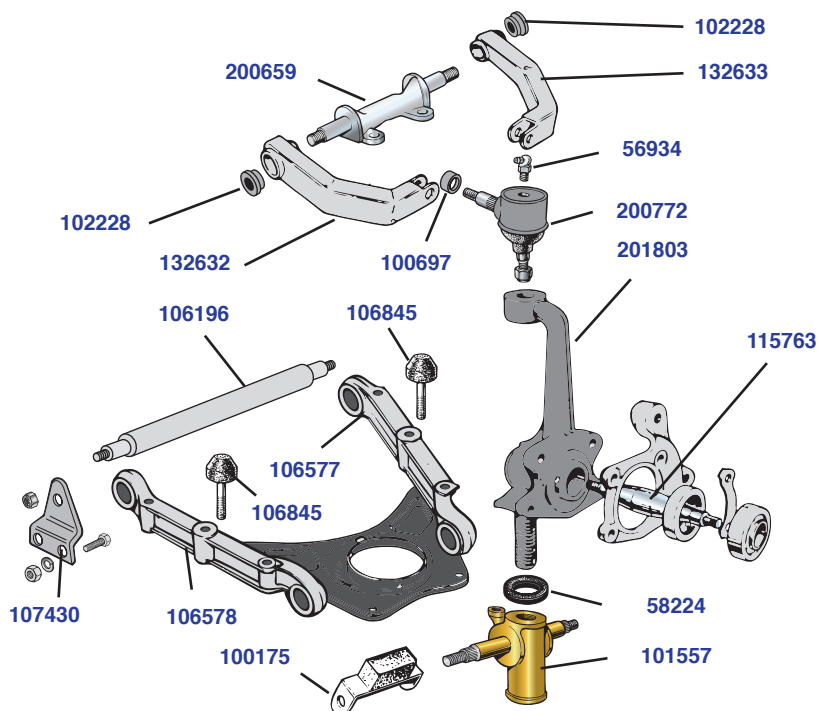

Part No.	Description	No. Off	List Price	Your Price
----------	-------------	---------	------------	------------

UPPER FULCRUM DETAILS

200659	Fulcrum Pin , upper wishbones	2		
102228	Bush , rubber, upper front suspension pivot	8		
102228/U	Bush , urethane, upper front suspension pivot, alternative to 102228	8		
RFK1842	Hardware Kit , securing upper fulcrum pins to suspension turret; includes set screws, bolts, washers, and nuts for installing one fulcrum pin (12 pieces)	2		

UPPER WISHBONES

132632	Wishbone Arm , LH front and RH rear	2		
132633	Wishbone Arm , RH front and LH rear	2		
RFK1843	Hardware Kit , securing upper wishbones to fulcrum pins; includes washers, nuts, and cotter pins (6 pieces)	2		

UPPER BALL JOINTS, A & A replicas

200772	Ball Joint , with grease fitting, rubber boot, and correct hardware	2		
100726	Boot , rubber, ball joints	2		
56934	Grease Fitting , ball joints	2		
100697	Distance Piece , upper wishbone arms	2		

Continued on Next Page

FRONT SUSPENSION AND STEERING

FRONT SUSPENSION—FULCRUM PINS, BALL JOINTS, VERTICAL LINKS, TRUNNIONS, AND WISHBONES, TR2, TR3—Continued

Part No.	Description	No.Off	List Price	Your Price
VERTICAL LINKS				
201803	Vertical Link	2		
115763	Stub Axle , stock type	2		
BOTTOM TRUNNIONS , A & A replicas				
101557	Lower Trunion Assembly , with cross pin and grease fitting	2		
56934	Grease Fitting	2		
58224	Seal , grease, rubber between vertical links and trunnions	2		
LOWER FULCRUM DETAILS , TR2, TR3				
106196	Fulcrum Pin , lower wishbones	2		
RFK1898	BRACKET KIT , supporting lower fulcrum pins, includes brackets and all correct hardware required for installation (15 pieces)	2		
107430	Bracket , fulcrum support	4		
TN3210	Nut , nyloc, securing brackets and wishbones to lower fulcrum pins	2		
RFK1845	Hardware Kit , securing brackets to chassis frame (12 pieces)	2		
LOWER WISHBONES , TR2, TR3				
106578	Wishbone Arm , LH front and RH rear	2		
106577	Wishbone Arm , RH front and LH rear	2		
LN2210	Nut , slotted, wishbone arms to trunnions	4		
PC10	Cotter Pin , securing nuts	4		
200193	Spring Pan Assembly , lower	2		
HARDWARE KITS , securing spring pans to wishbone arms				
RFK1844	Hardware Kit , with drilled bolts, studs, and slotted nuts as original; includes conical bump stop (24 pieces)	2		
RFK1844Z	Hardware Kit , with undrilled bolts, studs, and nyloc nuts to replace original components; includes conical bump stop (19 pieces)	2		
106845	Bump Stop , conical, mounted on lower rear wishbones	2		
100175	Bump Stop Assembly , rectangular, mounted to bracket on chassis under lower spring pans	2		
RFK1984	Hardware Kit , securing rectangular bump stops to chassis brackets (6 pieces)	2		

FRONT SUSPENSION AND STEERING

FRONT SUSPENSION—ROAD SPRINGS, TR2, TR3

We offer a choice of front road springs. Read carefully to insure that you understand whether or not alloy spacers are fitted with the springs you choose. You may wish to choose urethane packing rings for long life, especially in hot climates.

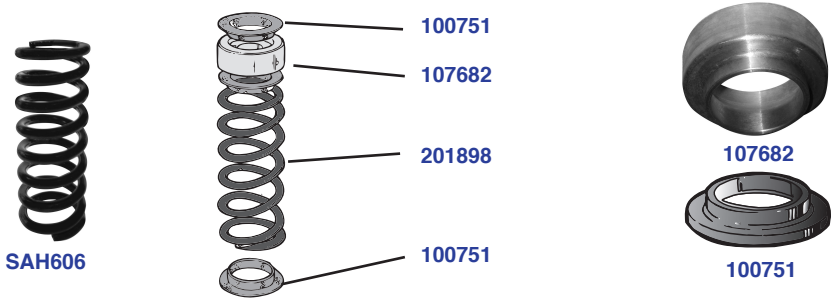

Part No.	Description	No.Off	List Price	Your Price
FRONT SPRINGS , stock fitment				
201898	Spring , front road, as original, fit with alloy spacer above spring	2		
107682	Spacer , alloy, front road spring	2		
210903	Spring , front road, original ride, do not use alloy spacer with this spring	2		
FRONT SPRINGS , uprated				
HP199	Spring , front road, uprated, fit with alloy spacer above spring	2		
107682	Spacer , alloy, front road spring	2		
PACKING RINGS , front road springs; choose original rubber or urethane material; three packings are required when alloy spacers are fitted				
100751	Packing Ring , rubber	4-6		
100751/U	Packing Ring , urethane	4-6		

FRONT SUSPENSION—TRF ROAD SPRING COMPRESSOR TOOLS, TR2, TR3, ETC.

The TRF tool works on the same principles as the one used by dealer mechanics. It has been carefully thought out and constructed to provide complete safety, and many hundreds have been sold. If you own later TRs as well as earlier ones, you may wish to buy the tool that includes both the early and the late adaptor plates. Ideal club purchase...

Part No.	Description	No. Off	List Price	Your Price
RFT102	Spring Compressor Tool ; use for TR2, TR3, and TR4 models	1		
RFT104	Spring Compressor Tool ; use for TR2, TR3, TR4, TR4A, TR250, and TR6	1		

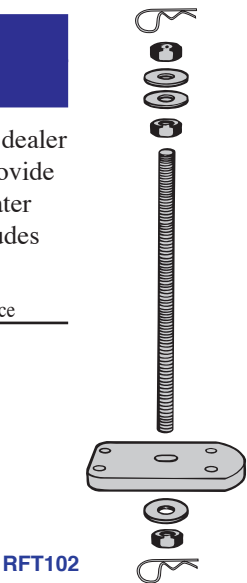

FRONT SUSPENSION AND STEERING

FRONT SUSPENSION—TUBE-TYPE SHOCK ABSORBERS, TR2, TR3

Customers have a choice between stock grade shocks which come in white boxes and high-performance varieties from Koni and Spax. A listing of mounting components is also provided.



AR62-2080



KONI80-1005SP



SPAX101

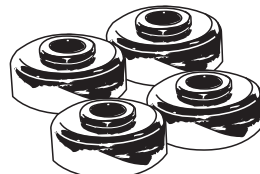

HP146



RFK737

Part No.	Description	No. Off	List Price	Your Price
SHOCK ABSORBERS, all TR2, TR3				
AR62-2080	Shock Absorber , stock grade, similar to Armstrong brand used originally	2		
KONI80-1005SP	Shock Absorber , high-performance, Koni brand adjustable shock	2		
SPAX101	Shock Absorber , high-performance, Spax brand adjustable shock	2		
SHOCK ABSORBER MOUNTINGS				
HP146	Upper Mounting Kit , includes four urethane mounts	1		
RFK737	Lower Shock Mounting Bracket Kit ; includes fulcrum brackets, lock plate, and all hardware required	2		
RFK1846	Hardware Kit , securing lower shock brackets and rebound abutments to studs on spring pans (8 pieces); included in RFK737	2		

FRONT SUSPENSION AND STEERING

SUSPENSION REBOUND RUBBERS, TR2, TR3

The Bump Stop Magic Kit includes bump stops for front and rear suspension and all hardware required for installing them.



106845



100175

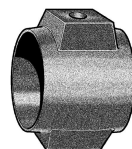

115456

Part No.	Description	No.Off	List Price	Your Price
RFK1940	BUMP STOP MAGIC KIT , all TR2, TR3, TR3A, TR3B	1		
106845	Conical Bump Stop , front suspension, mounted on lower rear wishbones	2		
RFK1983	Hardware Kit , securing conical bump stops to wishbones (3 pieces)	2		
100175	Rectangular Bump Stop , front suspension, mounted on bracket on chassis under lower spring pan	2		
RFK1984	Hardware Kit , securing rectangular bump stop to bracket on chassis under lower spring pan (6 pieces)	2		
115456	Bump Stop , rubber, strapped to rear axle tubes	2		
140606	Wire , strapping rubber bump stops to rear axle tubes	4		

FRONT HUBS—WHEEL STUDS

TRF has manufactured its own wheel studs for many years, after we received some bad ones from another source. We have sold thousands and thousands of these without a failure.



100869



114282



114281

Part No.	Description	No.Off	List Price	Your Price
100869	Wheel Stud , front hub, TR2, TR3, up to comm. no. TS13045, models with disc wheels	8		
	WHEEL STUDS , front hub, TR3, TR3A, TR3B, after comm. no. TS13045			
114282	Wheel Stud , models with disc wheels	8		
114281	Wheel Stud , models with wire wheels	8		

FRONT SUSPENSION AND STEERING

FRONT HUB BEARING KITS—ALWAYS TIMKEN BRAND, TR2, TR3

Many customers have indicated that they prefer to install genuine Timken bearings which is what Triumph used originally. TRF complies by supplying Timken bearings in the kits we make up in house for our customers, and we sell more bearing kits than ever before in spite of the higher price.

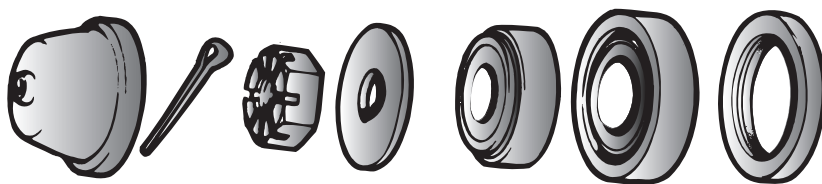

RFK1443



CAWB1



Part No.	Description	No. Off	List Price	Your Price
RFK1443	BEARING KIT , front hub, Timken bearings, includes inner and outer bearings, grease seal, D-washer, slotted nut, cotter pin, and grease cap	2		
TRFCD239	Bearing , inner, Timken brand	2		
TRFCD240	Bearing , outer, Timken brand	2		
GHS110	Seal , grease, front hub	2		
102690	D-washer	2		
LN2211	Nut , slotted	2		
PC20	Pin , cotter	2		
102689	Grease Cap	2		
RELATED ITEM				
CAWB1	Wheel Bearing Grease , 16 oz. resealable plastic tub	A/R		

FRONT SUSPENSION AND STEERING

FRONT HUBS—STRONGER FRONT AXLE KITS, TR3, TR3A, TR3B

TR racers have encountered a problem which is solved by fitting components from the list provided here. Stock TR stub axles are a bit flimsy, and they flex on hard cornering and while driving over rough surfaces. When the axles flex, the brake discs wobble, pushing the brake pistons back into the bores in the calipers. When it is time to brake, it can take a whole pump of fluid to push the pistons back into place. The second pump will slow the car, but what if you don't have time to pump twice? BMC cars used a spacer between the bearings to stiffen the stub axle assemblies on its cars, but Triumph didn't seem to realize they had a problem. Fitting the spacer kit to your stock setup will improve this situation, but fitting the uprated axle kit may be the better solution. This kit was created by Jack Drews, a vintage racer who died while racing a TR4 in 2008. The kits are still supplied by Jack's son.

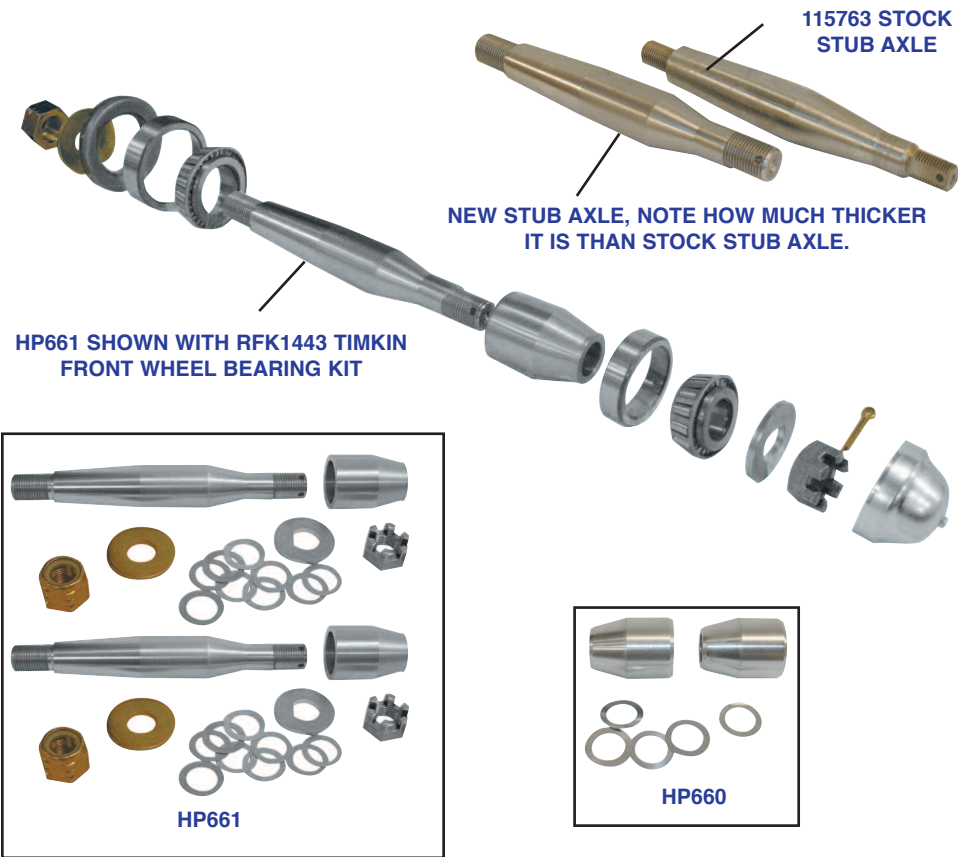

Part No.	Description	No.Off	List Price	Your Price
115763	Stub Axle, stock type, brand new, TR3, TR3A, TR3B, after comm. no. TS13045	2		
HP660	Spacer Kit, to be fitted with stock axles and bearings	1		
HP661	Stub Axle Kit, uprated, stronger axles, bearing spacers, shims, hardware, and instructions	1		
RFK1443	Timken Bearing Kit, as listed in the previous section, to go with a new stub axle kit	2		

FRONT SUSPENSION AND STEERING

SUSPENSION—ADDCO BRAND FRONT AND REAR SWAY BARS, TR3A, TR3B

Addco is a leading manufacturer of sway bars, aka “anti-roll bars,” for all types of cars, including our Triumphs. Kits are designed to be both effective and easy to install. You will notice a definite improvement if you fit the bars listed here to your TR3A or TR3B...

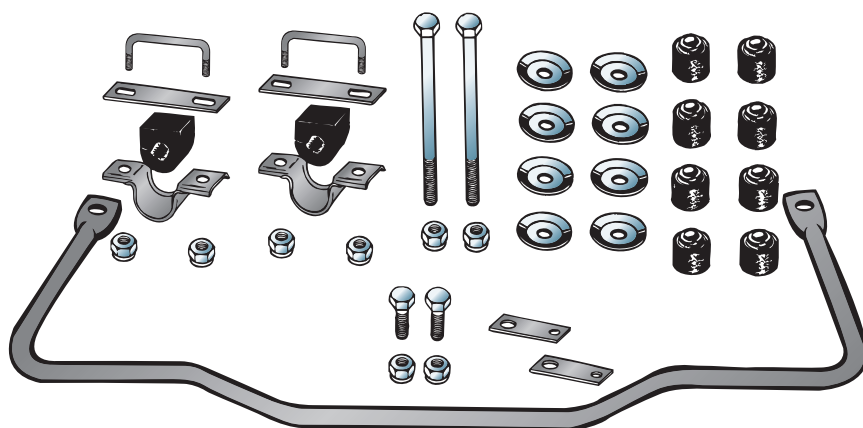
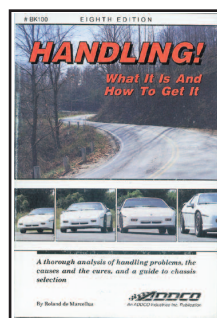
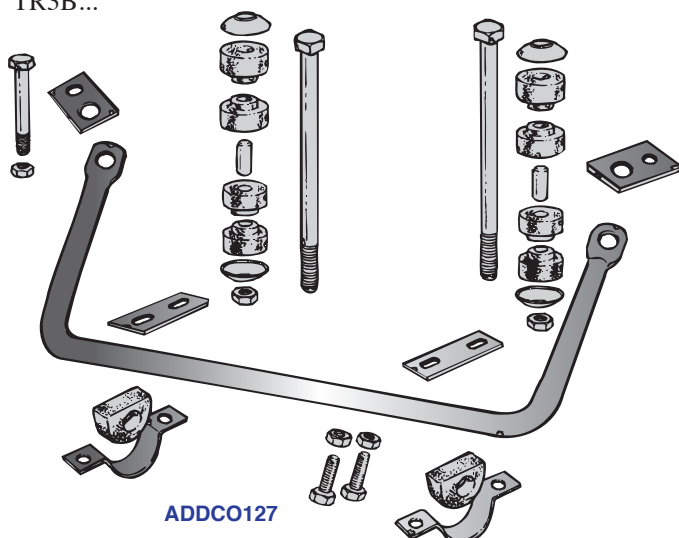

Part No.	Description	No.Off	List Price	Your Price
ADDCO127	Front Sway Bar Kit , 3/4-inch bar; includes bar, bushes, mounts, and hardware, plus installation instructions, TR3A, TR3B, 1958-63	1		
ADDCO923	Rear Sway Bar Kit , 5/8-inch bar; includes bar, bushes, mounts, and hardware, plus installation instructions, TR3A, TR3B, 1958-63	1		
ADCBK100	Book—“Handling! What It Is and How to Get It,” by Roland de Marcellus; 88 pages, soft cover, published by Addco	A/R		

FRONT SUSPENSION AND STEERING

STEERING BOX REBUILDING, TR2, TR3

Early steering boxes had long steering columns, solid all the way to the steering wheel. Later ones were split halfway, possibly allowing the steering box to be removed without removing the front apron. Internals of both boxes are quite identical as far as repairs and rebuilding are concerned. New steering columns are not available, but the cam, aka “worm gear” is available. Removing the old cam and installing the new one is not an easy job, and it requires heat, as the end of the column is mushroomed to prevent the cam coming loose.

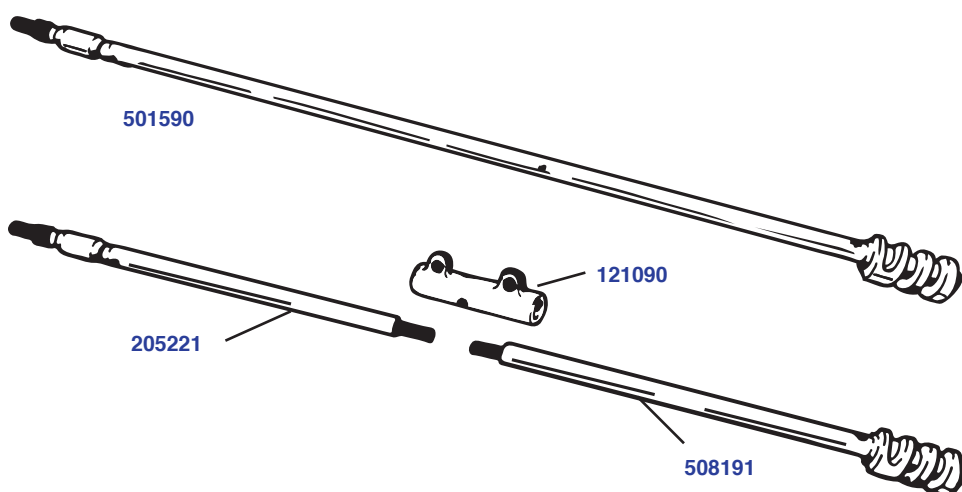

Part No.	Description	No.Off	List Price	Your Price
501590	Steering Column and Cam Assembly, inner, long type, left-hand steering	1		
502400	Steering Column and Cam Assembly, inner, long type, adjustable, left-hand steering	1		
501581	Steering Column and Cam Assembly, inner, long type, right-hand steering	1		
502399	Steering Column and Cam Assembly, inner, long type, adjustable, right-hand steering	1		
508191	Steering Column and Cam Assembly, inner, split type, left-hand steering	1		
508189	Steering Column and Cam Assembly, inner, split type, right-hand steering	1		
	CAMS, aka “Worm Gears,” fitted to long or short column as required			
REP255	Cam, left-hand steering	1		
REP346	Cam, right-hand steering	1		

Continued on Next Page

FRONT SUSPENSION AND STEERING

STEERING BOX REBUILDING, TR2, TR3—Continued

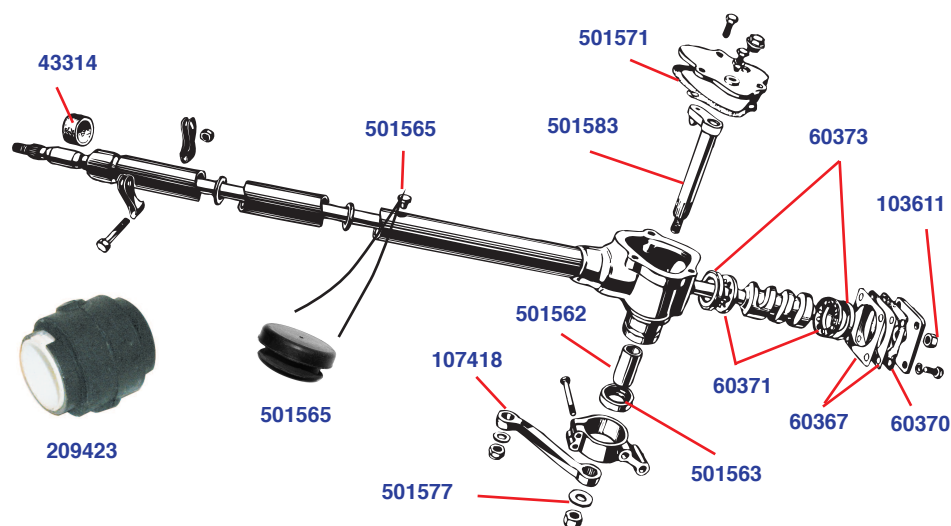

Part No.	Description	No. Off	List Price	Your Price
----------	-------------	---------	------------	------------

STEERING COLUMN—Other Details

60586	Ring , rubber, fitted to inner column, long columns only	2		
43314	Bush , felt, fitted in top of outer column tube	1		
209423	Bush , bearing, rubber and steel with Delrin insert, fitted in upper end of steering box tube and lower end of upper steering column tube, split-type only	2		
501565	Plug , oil filler, fitted in outer column tube	1		

BEARINGS, steering box

60373	Cup , bearing race	2		
60371	BALL BEARING ASSEMBLY	2		
BL16	Ball , fitted in cage	20		

SHIMS, adjusting preload on steering box bearings

60367	Shim , .0024 inch	A/R		
60368	Shim , .005 inch	A/R		
60369	Shim , .010 inch	A/R		

ROCKER SHAFT AND DROP ARM

501583	Rocker Shaft Assembly	1		
501568	Peg , comes with new rocker shaft	1		
501562	Bush , rocker shaft; must be honed to size after installation	1		
501563	Seal , oil, rocker shaft	1		
108153	Drop Arm , left-hand steering	1		
107418	Drop Arm , right-hand steering	1		
62/FNH	Nut , special, securing drop arm to rocker shaft; do not substitute	1		
501577	Plate , locking, securing nut	1		

Continued on Next Page

FRONT SUSPENSION AND STEERING

STEERING BOX REBUILDING, TR2, TR3—Continued

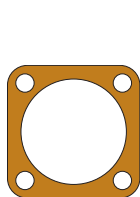

60370

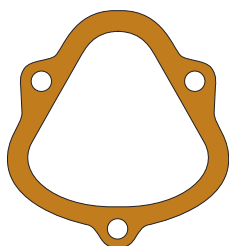

501571



103611



501575



BPGL4

300515 STATOR TUBE
SHOWING CLOSE UP OF SLOT

300515

Part No.	Description	No.Off	List Price	Your Price
GASKETS				
60370	Gasket , front end cover	1		
501571	Gasket , top cover	1		
WF511A	Gasket , for plug in top cover	1		
STATOR TUBES				
300515	Stator Tube , with anti-rattle springs	1		
301451	Stator Tube , with anti-rattle springs, models with adjustable steering columns	1		
	HARDWARE , securing stator tube to steering box front-end cover			
103611	Tubing Nut , brass	1		
501575	Olive , brass (compression sleeve)	1		
ADDITIONAL HARDWARE				
HB814	Bolt , locking steering box assembly to trunnion bracket	2		
WL208	Washer , lock, on bolts	2		
HB926	Bolt , securing trunnion bracket and stiffener to chassis frame	1		
HB925	Bolt , securing trunnion bracket to chassis frame	1		
WL209	Washer , lock on bolts	2		
	GEAR LUBE , correct grade for steering box			
BPGL4	Gear Lube , GL4, Brad Penn brand, one quart bottle with needle tip	1		

FRONT SUSPENSION AND STEERING

STEERING IDLER AND TIE-ROD COMPONENTS

The Roadster Factory manufactures greaseable tie-rod ends which are replicas of A & A parts originally fitted by Triumph. Other components listed here are made to the same standards. Tie-rod ends include rubber boots, grease fittings, and hardware.

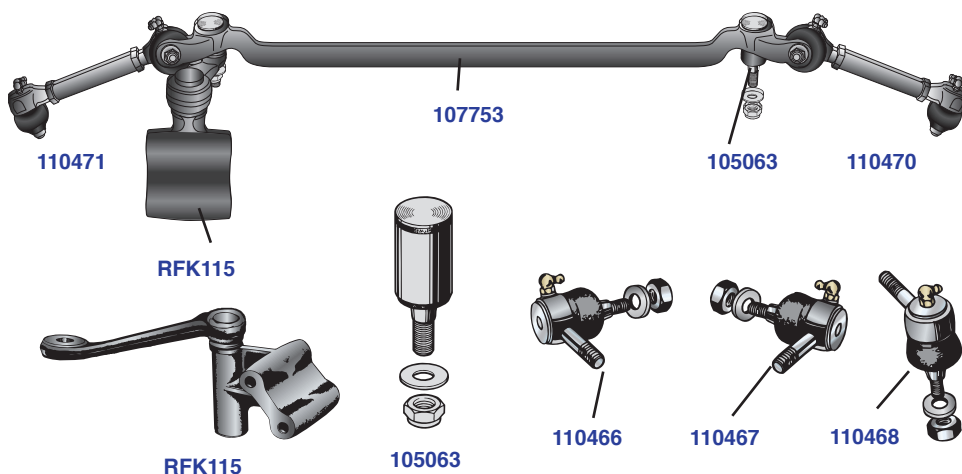

Part No.	Description	No.Off	List Price	Your Price
110470	OUTER TIE-ROD ASSEMBLY , complete, LH	1		
110471	OUTER TIE-ROD ASSEMBLY , complete, RH	1		
106650	Tube , outer tie-rod	2		
110466	Tie-rod End , inner, LH, with hardware	1		
110467	Tie-rod End , inner, RH, with hardware	1		
110468	Tie-rod End , outer, LH or RH, with hardware	2		
107740	Boot , rubber, supplied with tie-rod ends	4		
LN30041	Grease Fitting , supplied with tie-rod ends	4		
101668	Nut , locking, LH thread, outer	2		
101669	Nut , locking, RH thread, inner	2		
RFK115	IDLER LEVER AND BRACKET ASSEMBLY , matched set	1		
501958	Bracket , idler. with grease fitting	1		
105728	Lever Assembly , idler	1		
58615	Seal , grease, rubber	1		
HB925	Bolt , securing idler assembly to chassis	2		
WL209	Washer , lock	2		
CENTER TIE-ROD DETAILS				
107753	Center Tie-rod Assembly , with silent-bloc bush and pin assemblies	1		
105063	Pin Assembly , silent-bloc, securing center tie-rod to steering box drop arm and to idler lever, with hardware	2		
TN3209	Nut , nyloc, securing steering pins	2		
WL209	Washer , plain, under nuts	2		

FRONT SUSPENSION AND STEERING

NEW DESIGN FOR STEERING PINS, TR2, TR3

Uprated steering pin kits includes precision-machined steel pins, Delrin bushes and thrust washers, and attachment hardware. The Delrin bushes are pressed into the eyes of the center tie-rod, and the bushes then pivot on the steel pins. This is probably more precise, and longevity should be much improved, but the flex is gone from the original pins which may help the steering to return to center. Give this some thought, and choose based on your needs.



Part No.	Description	No.Off	List Price	Your Price
HP301	Steering Pin Kit; new design with very high quality production	1		

REPLICA STEERING WHEELS, TR2, TR3

The steering wheels listed here are replicas of the original ones supplied in the cars by Triumph. Regrettably, the adjustable wheel is not available at the time of writing, but we are including an illustration for identification purposes.

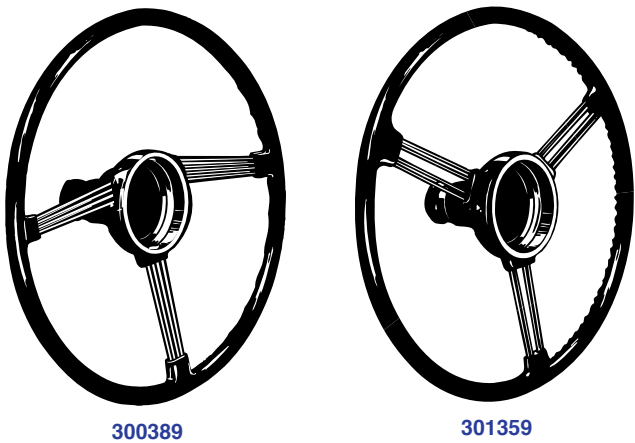

Part No.	Description	No.Off	List Price	Your Price
300389	Steering Wheel, non-adjustable steering columns	1		
301359	Steering Wheel, adjustable steering columns	1		

FRONT SUSPENSION AND STEERING

MOTO-LITA STEERING WHEELS IN WOOD OR LEATHER, TR2, TR3

The steering wheels listed here are very high quality, and TRF offers them at really competitive pricing. Both wood-rimmed and leather rimmed wheels are included, and adaptors are listed which allow the use of the original control heads on TR2 and TR3 models. Adaptors are required to install the Moto-Lita steering wheels on the TR2, TR3 steering columns.



PHOTO LEFT SHOWS A MOTO-LITA WOOD-RIMMED STEERING WHEEL AND TRF'S SIGNAL SWITCH/HORN PUSH (CONTROL HEAD) FITTED TO JOHN SWAUGER'S 1958 TR3A.



ML901



201872/A



201872



ML103



ML203



ML303

Part No.	Description	No.Off	List Price	Your Price
----------	-------------	--------	------------	------------

WOOD-RIMMED WHEELS, laminated marine timber with rivets and polished alloy spokes; 16-inch wheel is recommended for TR2 and TR3

ML103	Steering Wheel , 15-inch diameter, flat	1		
ML105	Steering Wheel , 16-inch diameter, flat	1		

LEATHER-COVERED WHEELS, with alloy spokes

ML203	Steering Wheel , 15-inch diameter, flat, with polished alloy spokes	1		
ML303	Steering Wheel , 15-inch diameter, flat, with black alloy spokes	1		

ADAPTOR HUB KITS, allow the use of original control heads

ML901	Adaptor Kit , non-adjustable steering	1		
ML902	Adaptor Kit , adjustable steering	1		

CONTROL HEADS, including turn signal switch and horn button; replicas of Lucas switches originally fitted to TR2, TR3

201872	Control Head , non-adjustable steering	1		
201872/A	Control Head , adjustable steering	1		

REAR SUSPENSION

REAR SUSPENSION—LEAF SPRINGS, TR2, TR3

It is possible to replace virtually the entire rear suspension with brand-new components, or make selections from the list provided below to restore the ride and handling of your classic Triumph.

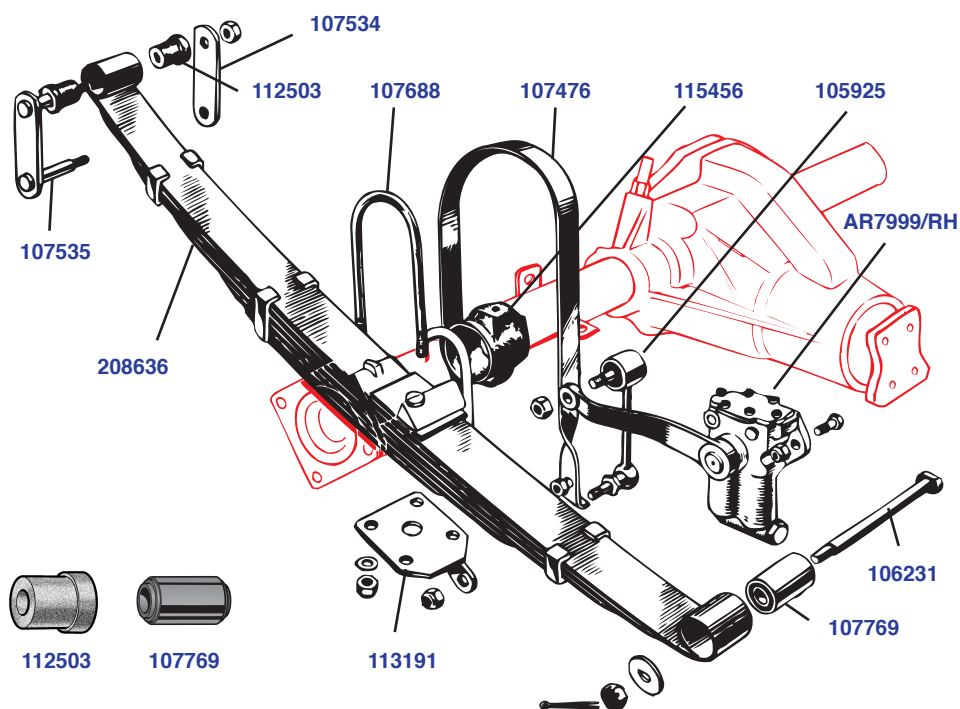

Part No.	Description	No.Off	List Price	Your Price
REAR LEAF SPRINGS				
208636	Leaf Spring Assembly	2		
107769	Bush , silent-bloc, front spring eye; supplied with new springs	2		
RFK1860	SPRING ATTACHMENT KIT , front	2		
106231	Bolt , special, through chassis frame	2		
102690	D-Washer , on bolts	2		
LN2211	Nut , slotted, securing springs to bolts	2		
PC10	Pin , cotter, securing nuts	2		
RFK1861	SPRING ATTACHMENT KIT , rear, rubber bushes	2		
RFK1861/U	SPRING ATTACHMENT KIT , rear, urethane bushes	2		
107535	Shackle Plate , with pins	2		
107534	Shackle Plate , without pins	2		
112503	Bush , rubber, rear spring shackle	8		
112503/U	Bush , urethane, rear spring shackle	8		
HN2009	Nut , securing shackle plate	4		
WL209	Washer , lock, securing nuts	4		

Continued on Next Page

REAR SUSPENSION

REAR SUSPENSION—LEAF SPRINGS, TR2, TR3—Continued

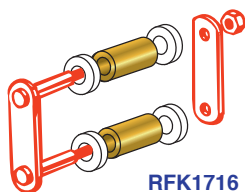

RFK1716

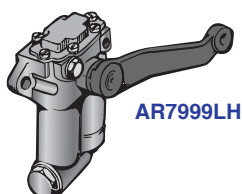

AR7999LH

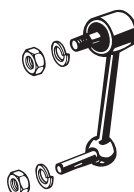

105925



ARSF2

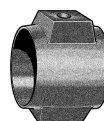

115456

Part No.	Description	No. Off	List Price	Your Price
RFK1716	Spring Shackle Kit , high-performance; includes bronze shackle bushes and Delrin spacers to replace original rubber bushes; does both sides	1		
	ATTACHMENTS , rear axle to leaf springs			
113181	Plate , spring clip, LH, Girling axles	1		
113191	Plate , spring clip, RH, Girling axles	1		
107688	Clip (U-Bolt) , securing axle to leaf springs, Lockheed axles	4		
113194	Clip (U-Bolt) , securing axle to leaf springs, Girling axles	4		
YN2909	Nut , nyloc, securing U-bolts and plates	8		
WP9	Washer , plain, on U-bolts	8		
	LEVER SHOCKS , brand new			
AR7999LH	Lever Shock , LH	1		
AR7999RH	Lever Shock , RH	1		
	LEVER SHOCKS , factory rebuild; send rebuildable shocks with order, or pay refundable core charge			
202389R	Lever Shock , LH	1		
CORE45	Core Charge, on the above	1		
202388R	Lever Shock , RH	1		
CORE45	Core Charge, on the above	1		
RFK804	Hardware Kit , securing shock absorbers to chassis frame; services both shocks	1		
ARSF2	Shock Fluid , for refilling lever shocks, 1/2 liter container	A/R		
105925	Link Kit , rear lever shock; includes link and mounting hardware	2		
RFK467	REAR AXLE REBOUND RUBBER KIT	1		
115456	Rebound Rubber , strapped to axle tubes	2		
140606	Binding Wire , strapping rebound rubbers to axle tubes	4		
	CHECK STRAP DETAILS , rear suspension			
107476	Check Strap	2		
HN2009	Nut , securing straps to studs on chassis frame	4		
WL209	Washer , lock, securing nuts	4		