

TUNE-UP

ELECTRICAL TUNE-UP, TR2, TR3

TRF generally supplies genuine Lucas components, unless otherwise indicated. Up-rated "Red Rotors" are used in place of the ones available in the past which caused a shorting problem because of a design flaw.

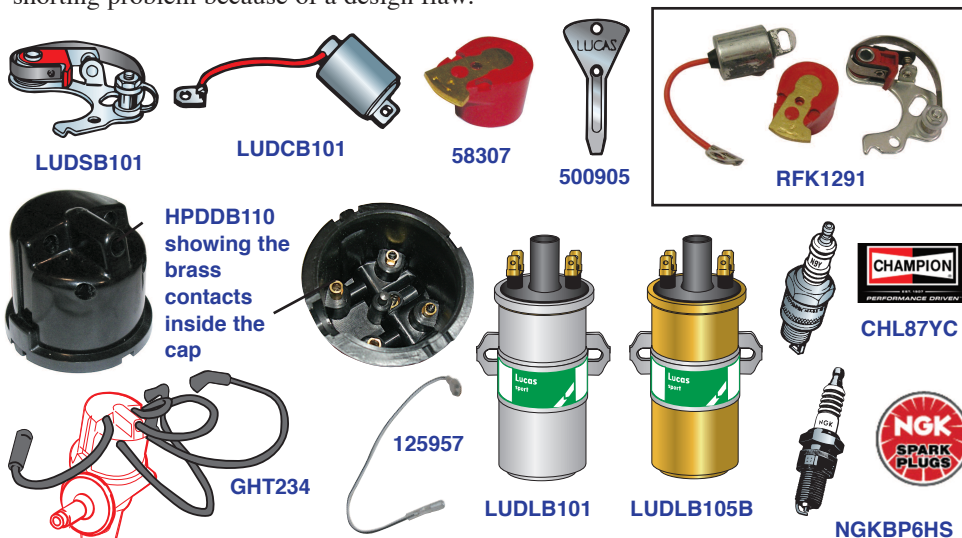

Part No.	Description	No. Off	List Price	Your Price
----------	-------------	---------	------------	------------

DISTRIBUTOR TUNE-UP

LUDSB115	Contact Set (Points) , TR2	1		
LUDSB101	Contact Set , TR3, TR3A, TR3B	1		
LUDCB101	Condenser , all TR2, TR3 models	1		
58307	Rotor , red, best quality available	1		
HPDDB110	Distributor Cap , brass contacts, all TR2, TR3 models	1		
500905	Tool , distributor, Lucas; good to have on your key ring	1		

USEFUL HARDWARE

SLP108	Screw , securing points	1		
SLP109	Screw , securing condenser	1		

MINI TUNE-UP KITS; include points, condenser, and rotor

RFK1868	Mini Tune-up Kit , TR2	1		
RFK1291	Mini Tune-up Kit , TR3 models	1		

SPARK PLUGS

CHL87YC	Spark Plug , Champion brand	4		
NGKBP6HS	Spark Plug , NGK brand	4		

IGNITION COILS

LUDLB101	Ignition Coil , Lucas, standard type	1		
LUDLB105B	Ignition Coil , Lucas "Sport" type	1		
125957	Low Tension Lead , coil to distributor, with black tracers	1		

IGNITION WIRE SETS

GHT234	Cable Set , stranded copper core with black insulation, terminals, and boots; set of five cables, manufactured by TRF	1		
--------	--	---	--	--

TUNE-UP

PERTRONIX ELECTRONIC IGNITION CONVERSIONS,
TR2, TR3

Distributor conversions are very popular among TR2 and TR3 enthusiasts. Pertronix is the way to go, simple, easy to understand and install, reliable. Everything is hidden under the cap.

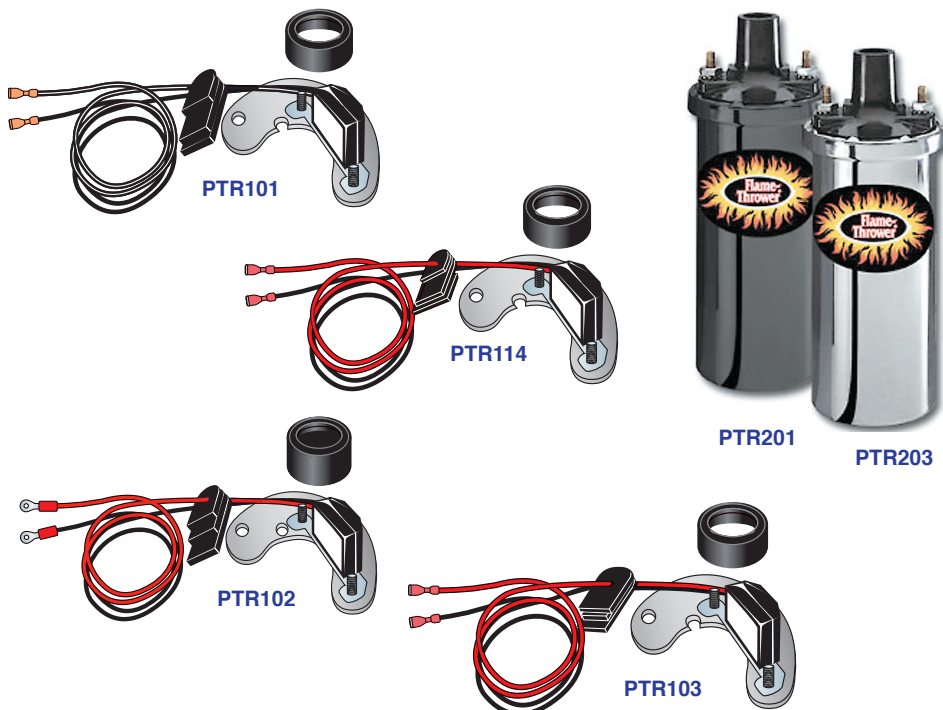

Part No.	Description	No.Off	List Price	Your Price
CONVERSION KITS				
PTR101	Electronic Ignition Conversion, TR2 models with positive (+) ground and Lucas DM2 distributors	1		
PTR114	Electronic Ignition Conversion, TR2 models with negative (-) ground and Lucas DM2 distributors	1		
PTR102	Electronic Ignition Conversion, TR3 models with positive (+) ground and Lucas 25D distributors	1		
PTR103	Electronic Ignition Conversion, TR3 models with negative (-) ground and Lucas 25D distributors	1		
PERTRONIX IGNITION COILS				
PTR201	Ignition Coil , high-performance, black housing, all TR2, TR3 models	1		
PTR203	Ignition Coil , high-performance, chrome housing, all TR2, TR3 models	1		

TUNE-UP

AIR AND OIL FILTERS, TR2, TR3

TRF stocks replicas of the reusable metal canister filters fitted to TR2 and TR3 models along with high-quality oil filters and fittings.



Part No.	Description	No.Off	List Price	Your Price
----------	-------------	--------	------------	------------

AIR CLEANERS

107356	Air Cleaner Assembly , TR2	2		
203131	Air Cleaner Assembly , TR3 models	2		
ACL20	Label Set , TR2 air cleaners	1		
ACL30	Label Set , water decals, TR3 air cleaners	1		
RFK775	Fitting Kit , TR2 air cleaners, includes hardware and gaskets	1		
RFK776	Fitting Kit , TR3 air cleaners, includes hardware and gaskets	1		
102488	Gasket , air cleaners, TR2	2		
112892	Gasket , air cleaners, TR3 models	2		

OIL FILTERS

GFE104	Oil Filter , original canister type, all TR2, TR3 models	1		
507151	Seal , canister to filter head	1		
500321	Seal , rubber, filter bolt head to canister	1		
TRFEL401	Spin-on Filter Adaptor , Purolator brand filter heads (coarse thread bolt)	1		
TRFEL402	Spin-on Filter Adaptor , Tecalect brand filter heads (fine thread bolt)	1		
GFE148	Oil Filter , spin-on type, for use with spin-on adaptors	1		

OIL CHANGE PLUGS, ETC.

114774	Oil Drain Plug , original square-head type; fits engine, gearbox, axle	A/R		
155660	Oil Drain Plug , magnetic type with square head	A/R		
RFT131	Wrench , with square socket to fit oil drain plugs	1		

ENGINE

RECOMMENDED ENGINE OIL

“Get One Quart Free When You Purchase Six Quarts”

TRF stocks “Brad Penn” high-performance engine oil, rich in zinc and phosphorous as required by classic engines with flat valve tappets and high spring pressures. These additives have now been removed from modern engine oils sold by auto parts stores and other sources, as they are no longer required in modern engines. Brad Penn oils are refined in the old Kendall plant in Bradford, Pennsylvania.



BPPG1040/1

Part No.	Description	No.Off	List Price	Your Price
----------	-------------	--------	------------	------------

PENN GRADE “1” ENGINE OIL,

partial synthetic; includes ZDDP

BPPG1040/1	Engine Oil , 10W-40, per quart	A/R
BPPG1040/6	Engine Oil , 10W-40, per six quarts	A/R
BPPG2050/1	Engine Oil , 20W-50, per quart	A/R
BPPG2050/6	Engine Oil , 20W-50, per six quarts	A/R

PENN GRADE “1” ENGINE OIL,

single weight; includes ZDDP

BPPG30/1	Engine Oil , SAE 30, per quart	A/R
BPPG30/6	Engine Oil , SAE 30, per six quarts	A/R
BPPG40/1	Engine Oil , SAE 40, per quart	A/R
BPPG40/6	Engine Oil , SAE 40, per six quarts	A/R

ENGINE REBUILDING—FRONT AND REAR ENGINE MOUNTS, TR2, TR3

All components listed here are replicas of factory originals manufactured by The Roadster Factory.



106428

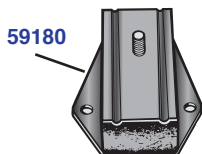

59180



109582

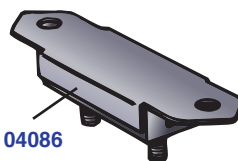

104086

Part No.	Description	No.Off	List Price	Your Price
----------	-------------	--------	------------	------------

RFK745	FRONT ENGINE MOUNTING KIT; includes two front mounts, shims, steady brackets, and correct hardware	1		
59180	Engine Mount , front	2		
109582	Shim , to align crank pulley with hole in radiator for hand crank	A/R		
106428	Bracket , steady; keeps engine from moving too much on the mounts	4		
RFK746	REAR ENGINE (GEARBOX) MOUNTING KIT; includes gearbox mount and required hardware	1		
104086	Engine Mount , rear (gearbox)	1		

ENGINE

ENGINE REBUILDING—GASKET SETS AND INDIVIDUAL GASKETS, ALL TR2, TR3

Choose from two levels of gasket sets or purchase individual gaskets as required.

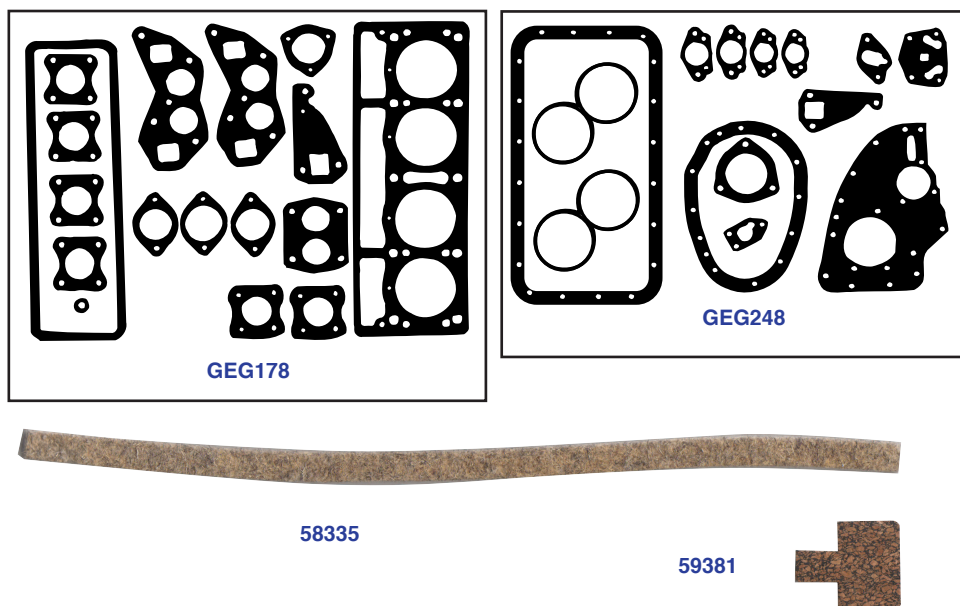

Part No.	Description	No.Off	List Price	Your Price
UPPER ENGINE GASKET SETS				
GS1	Gasket Set , for models with low-port head, TR2, early TR3 (contents similar to illustration of GEG178)	1		
GEG178	Gasket Set , Payen brand or similar high quality, for models with high-port head, later TR3, TR3A, TR3B	1		USE REG178
REG178	Gasket Set , similar to GEG178 but with less-expensive components	1		
LOWER ENGINE GASKET SETS				
GEG248	Gasket Set , Payen brand (for contents, see illustration), all TR2, TR3	1		
REG248	Gasket Set , similar to GEG248 but with less-expensive components	1		
RELATED PARTS				
58335	Packing , felt, rear main bearing cap; read your workshop manual for installation instructions; critical part	2		
59381	Sealing Pad , cork, fitted to each side of front bearing cap sealing block	2		

Continued on Next Page

ENGINE

ENGINE REBUILDING—GASKET SETS AND INDIVIDUAL GASKETS, ALL TR2, TR3—Continued

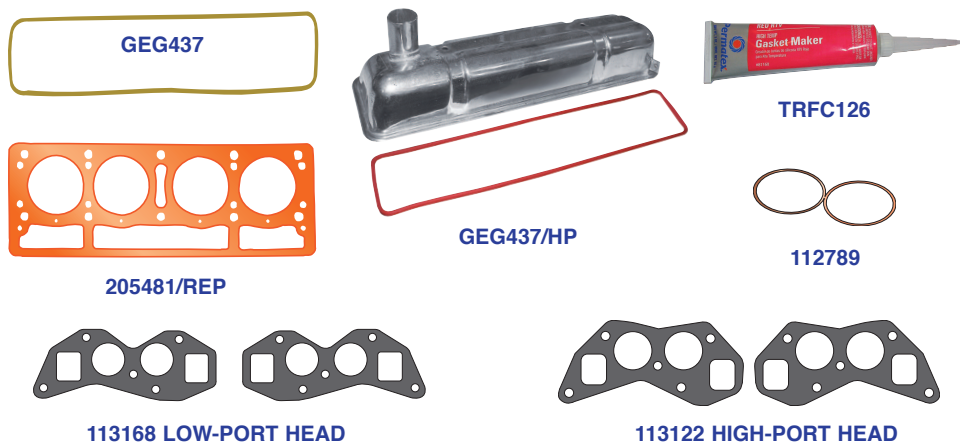

Part No.	Description	No. Off	List Price	Your Price
----------	-------------	---------	------------	------------

INDIVIDUAL GASKETS, upper engine

205481/REP	Gasket , cylinder head, copper	1		
GEG437	Gasket , valve cover, stock type	1		
GEG437/HP	Gasket , valve cover, silicon, reusable	1		
TRFC126	Gasket Adhesive , red Permatex, for securing silicon gasket to valve cover	1		
113168	Gasket , manifolds to cylinder head, low-port head	2		
113122	Gasket , manifolds to cylinder head, high-port head	2		
112866	Gasket , thick, H6 carbs to manifold	2		
112867	Gasket , thin, H6 carbs to manifold	4		
102488	Gasket , air cleaners to H4 carbs	2		
112892	Gasket , air cleaners to H6 carbs	2		
138586	Gasket , water pump housing to engine block	1		
138587	Gasket , water pump to housing	1		
GTG103	Gasket , thermostat cover	1		
GEG718	Gasket , flange, exhaust pipe to manifold	1		
125251	Gasket , shim, distributor to pedestal to engine block	A/R		

INDIVIDUAL GASKETS, lower engine

112789	Seal , figure-of-eight, cylinder liners to engine block	2		
56389	Gasket , front plate to engine block	1		
211122	Gasket , timing cover to engine plate	1		
56282	Gasket , oil pump to engine block	1		
211123	Gasket , oil sump (oil pan) to engine block	1		
139041	Gasket , fuel pump to engine block	1		
112146	Gasket , oil filter head to engine block	1		

ENGINE

ENGINE REBUILDING—MAIN BEARINGS, ROD BEARINGS, ETC., ALL TR2, TR3

TRF still holds some stock of genuine Vandervell main bearings, but most of our bearings are manufactured by King and boxed as “County Brand.” The County Brand bearings are available in both bi-metal and tri-metal. Original Vandervell were tri-metal, lead, indium, and bronze.

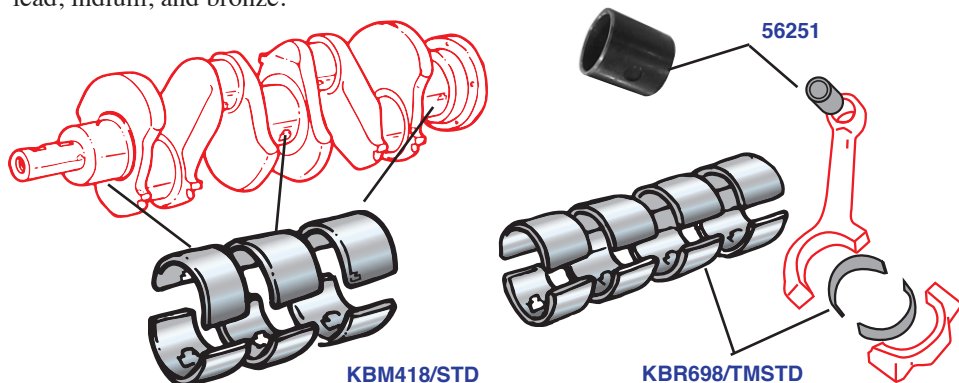

Part No.	Description	No. Off	List Price	Your Price
MAIN BEARINGS —Vandervell Brand, tri-metal bearings				
VPM418/STD	Main Bearing Set , standard size	1		
VPM418/040	Main Bearing Set , .040-inch undersize	1		
MAIN BEARINGS —King Brand, tri-metal bearings				
KBM418/TM010	Main Bearing Set , .010-inch undersize	1		
KBM418/TM020	Main Bearing Set , .020-inch undersize	1		
MAIN BEARINGS , King Brand, bi-metal bearings				
KBM418/BMSTD	Bearing Set , standard size	1		
KBM418/BM010	Bearing Set , .010-inch undersize	1		
KBM418/BM020	Bearing Set , .020-inch undersize	1		
KBM418/BM030	Bearing Set , .030-inch undersize	1		
CONNECTING ROD BEARINGS , King Brand, tri-metal bearings				
KBR698/TMSTD	Rod Bearing Set , standard size	1		
KBR698/TM010	Rod Bearing Set , .010-inch undersize	1		
KBR698/TM020	Rod Bearing Set , .020-inch undersize	1		
CONNECTING ROD BEARINGS , King Brand, bi-metal bearings				
KBR698/BMSTD	Rod Bearing Set , standard size	1		
KBR698/BM010	Rod Bearing Set , .010-inch undersize	1		
KBR698/BM020	Rod Bearing Set , .020-inch undersize	1		
KBR698/BM030	Rod Bearing Set , .030-inch undersize	1		
56251	Small-End Bush , connecting rods	4		

Continued on Next Page

ENGINE

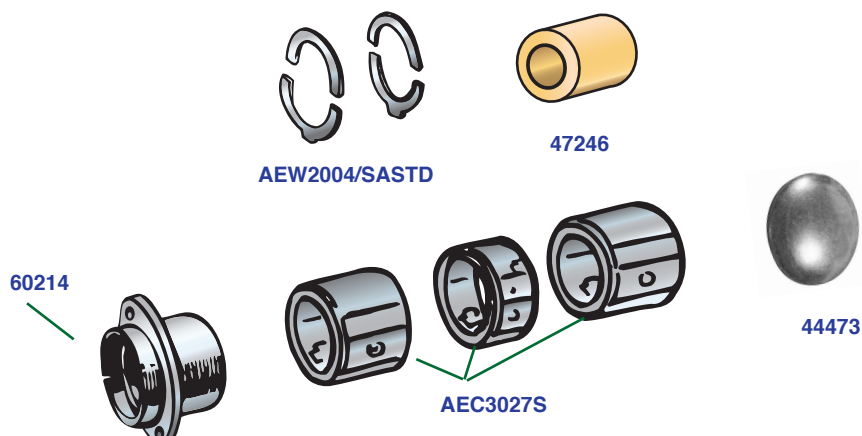
ENGINE REBUILDING—MAIN BEARINGS, ROD BEARINGS,
ETC., ALL TR2, TR3—Continued

Part No.	Description	No.Off	List Price	Your Price
----------	-------------	--------	------------	------------

CRANKSHAFT THRUST WASHERS;

sizes may be combined in pairs to
attain correct end-float

AEW2004/SASTD	Thrust Washer Set , standard size	1		
AEW2004/SA005	Thrust Washer Set , .005 oversize	1		

PILOT BUSH

47246	Bush , oilite, fitted in rear of crankshaft	1		
-------	---	---	--	--

CAMSHAFT BEARINGS

60214	Bearing , camshaft front	1		
56370	Bolt , securing front bearing to block	2		
WL208	Washer , lock, on screws	2		
AEC3027S	Camshaft Bearing Set ; does not include front bearing	1		
110462	Screw , spigot-end, locating bearings in engine block	3		
WP107	Washer , plain, fitted under screw heads	3		
44473	Plug , core, fitted in block to rear of camshaft	1		

ENGINE

ENGINE REBUILDING—PISTON AND LINER KITS, ALL TR2, TR3

High-quality County brand piston and liner kits are available in 87mm size which provides a little more displacement for any TR2 or TR3 engine. One nice feature of these kits is the protective coating to prevent corrosion on the outside surfaces of the liners which contact the cooling water.

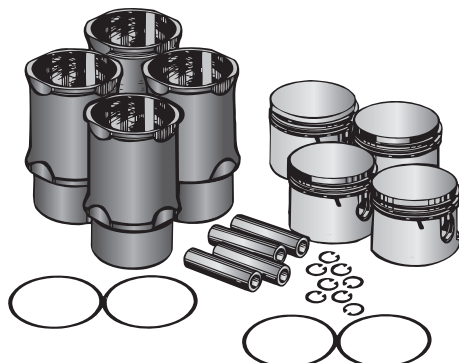

CBPLK1710

Part No.	Description	No.Off	List Price	Your Price
CBPLK1710	Piston and Liner Kit , 87mm, includes pistons with rings and wrist pins, coated liners, and figure-of-eight gaskets	1		

ENGINE REBUILDING—OIL PUMP DETAILS

Check your old pump by following the directions in the workshop manual. If it is out of specification, you may be able to fix it by fitting a new rotor kit. If not, new pumps are available.

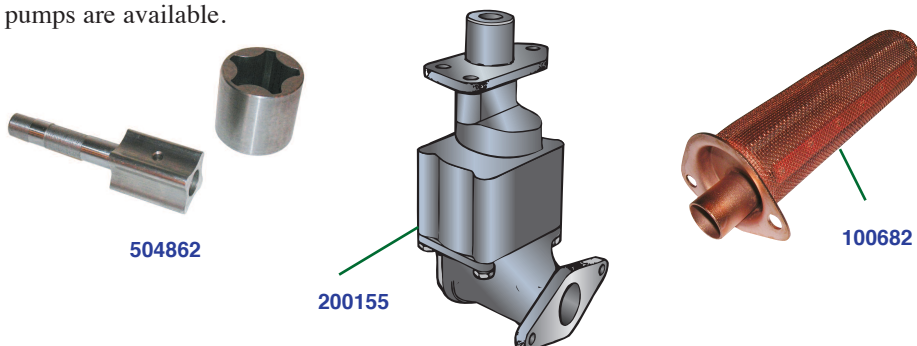

Part No.	Description	No.Off	List Price	Your Price
200155	Oil Pump Assembly , brand new	1		
504862	Rebuild Kit , oil pump rotor assembly	1		
100682	Filter Screen Assembly , oil pump	1		
RFK2142	Hardware Kit , securing oil pump to engine block, includes studs, lock washers, and hex nuts (9 pieces)	1		
56282	Gasket , oil pump to engine block	1		
RFK2143	Hardware Kit , securing oil filter screen to pump; includes screws, washers, and nuts (6 pieces)	1		

ENGINE

ENGINE REBUILDING—FRONT AND REAR ENGINE OIL SEALS, ALL TR2, TR3

Stock seals are listed here which are the types listed in the workshop manuals. As most enthusiasts are aware, it is difficult to keep the stock rear seal from leaking, and many “fixes” for this problem have been promoted. The best was devised by a TR4 racer in Germany by the name of Christian Marx. The seal is a high-quality Viton Seal, and it comes with a new aluminium seal housing. Machining of the crankshaft is NOT required, and the leaks stop.

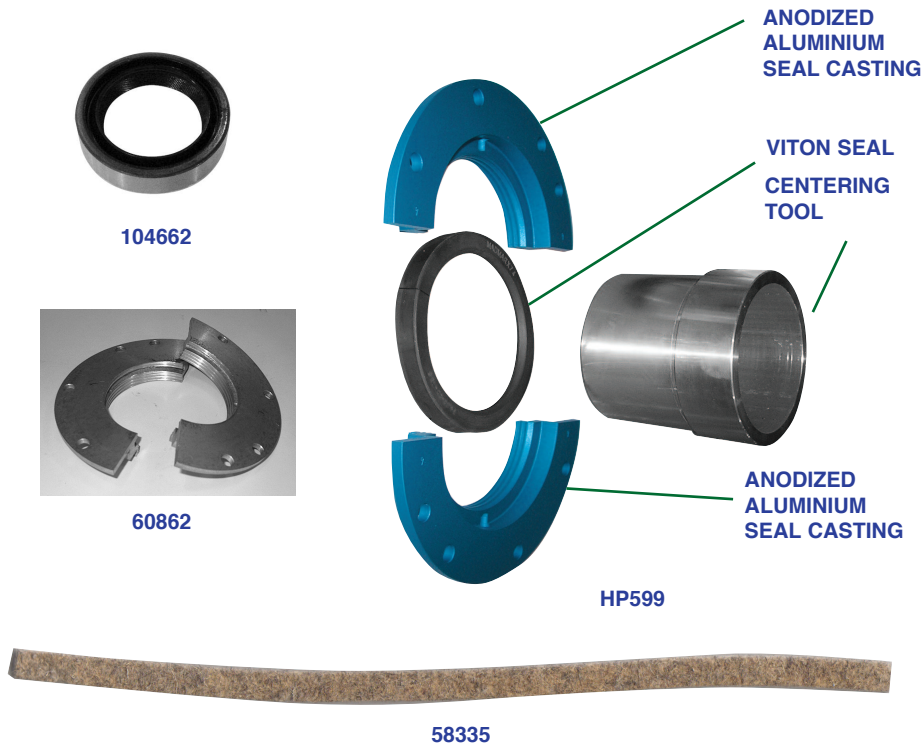

Part No.	Description	No.Off	List Price	Your Price
STOCK SEALS				
104662	Oil Seal, front, fitted in timing cover	1		
60862	Oil Seal Assembly, rear, matched halves	1		
REPLACEMENT REAR ENGINE SEAL				
HP599	Rear Seal Kit, upgraded, Viton seal, alloy seal housing, and tool for centering the seal during installation	1		
REAR SEAL INSTALLATION TOOL				
RFT130	Tool, for centering rear engine seal; use for original seals and upgraded seals	1		
RFK2141	Hardware Kit, securing rear oil seal to block and to rear bearing cap, includes 8 screws and 8 lock washers	1		
58335	Packing Strip, felt, rear bearing cap—Read your shop manual for installation details	2		

ENGINE

ALLOY FRONT ENGINE PLATES, TR2, TR3

New, flat, and light in weight, these replacement engine plates may have advantages over battered originals for both street and track.

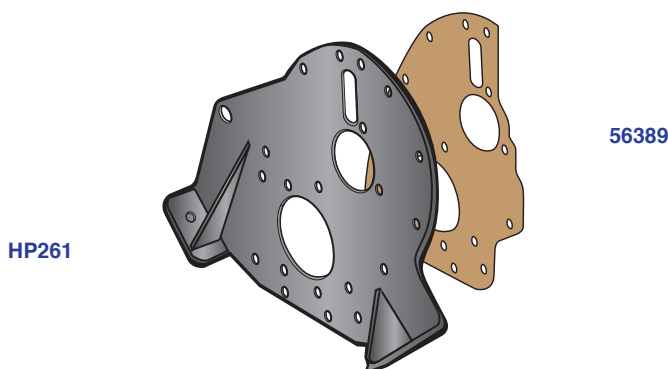

Part No.	Description	No.Off	List Price	Your Price
HP261	Front Engine Plate Assembly , lightweight alloy material	1		
56389	Gasket , front engine plate to engine	1		

ENGINE REBUILDING—FRONT CRANKSHAFT PULLEYS, ALL TR2, TR3

Repair or replace bent and out-of-balance crankshaft pulleys with the components listed here.

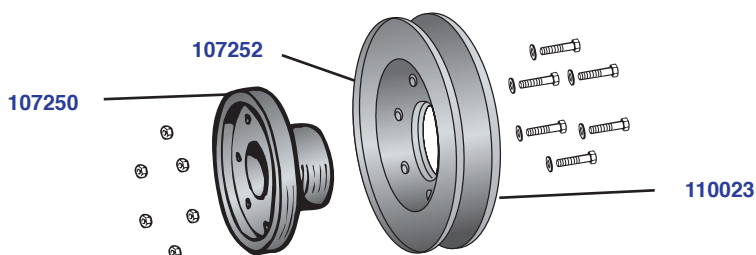

Part No.	Description	No.Off	List Price	Your Price
RFK101	CRANKSHAFT PULLEY KIT , all TR2, TR3 models (assembly required)	1		
110023	Pulley Half , front	1		
107252	Pulley Half , rear	1		
RFK1993	Hardware Kit , for assembling pulley halves and hub	1		
107250	Hub , crankshaft pulley; not included in kit	1		

ENGINE

ENGINE REBUILDING—LOCK PLATES, CORE PLUGS,
ALL TR2, TR3

105313



56293



56524



107857

Part No.	Description	No.Off	List Price	Your Price
RFK794	LOCK PLATE KIT , includes the following...	1		
105313	Locking Plate , connecting rod bolts; not used with high-tensile bolts	4		
56293	Locking Plate , camshaft timing gear	1		
56524	Locking Plate , flywheel to crankshaft	2		
107857	Locking Plate , engine fan mounting bolts	2		
115776	Locking Plate , late ring gears; not inc. in kit	6		
CORE PLUGS				
44473	Plug , core, rear of camshaft	1		
PU1404/3	Plug , screwed, ends of oil gallery, stick of three plugs supplied	1		

ENGINE REBUILDING—CAMSHAFT, TIMING GEARS AND
CHAINS, TR2, TR3

Brand new components remain available, and TRF stocks genuine Renold brand timing chains as installed in Triumph factory engines.

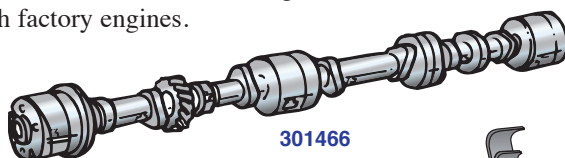
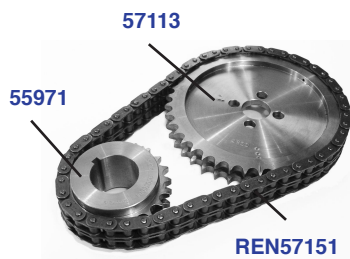

Part No.	Description	No.Off	List Price	Your Price
301466	Camshaft , brand new	1		
57113	Gear (ChainWheel) , timing, camshaft	1		
56370	Bolt , securing timing gear to camshaft	2		
56293	Locking Plate , securing timing gear bolts	1		
55971	Gear (Chain Wheel) , timing, crankshaft	1		
56522	Shim , .004 in., locating gear on crankshaft	A/R		
56523	Shim , .006 in., locating gear on crankshaft	A/R		
57196	Deflector , oil, fitted in front of timing gear	1		
KW624	Key , locating crankshaft timing gear	2		
REN57151	Timing Chain , duplex, OEM Renold brand	1		
43404	Tensioner , timing chain	1		
58701	Pin , anchoring timing chain	1		
WP18	Washer , plain, securing tensioner to pin	1		
PC5	Pin , cotter, securing washer and tensioner	1		

ENGINE

ENGINE REBUILDING—VALVES, GUIDES, SPRINGS

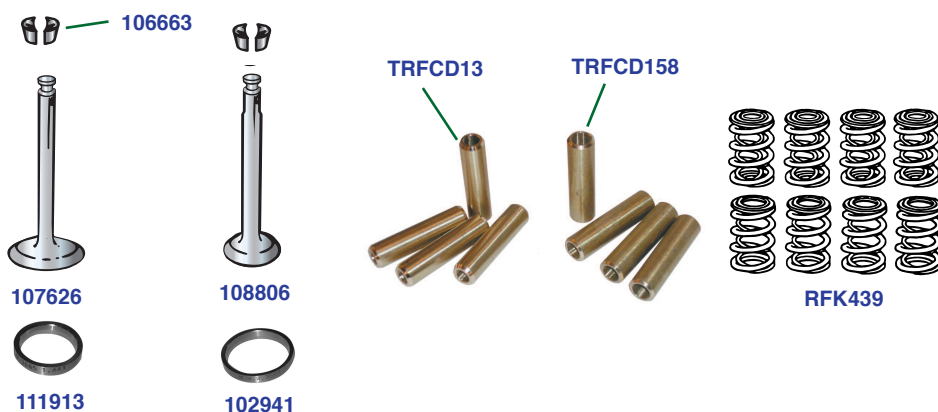

Part No.	Description	No.Off	List Price	Your Price
VALVES				
107626	Valve , intake, 1/16-inch stem	4		
108806	Valve , exhaust, 3/8-inch stem, original for TR2, TR3	4		
136567	Valve , exhaust, improved, later TR4, TR4A; may be fitted to TR2, TR3 with guide no. TRFCD80	4		
HARDENED VALVE SEAT INSERTS; these are best installed by a good automotive machine shop to adapt vintage cylinder heads for the use of unleaded fuel				
111913	Insert , valve seat, intake	4		
102941	Insert , valve seat, exhaust	4		
BRONZE VALVE GUIDES				
TRFCD13	Valve Guide , intake, bronze	4		
TRFCD158	Valve Guide , exhaust, bronze, for original exhaust valves	4		
TRFCD80	Valve Guide , exhaust, bronze, for fitting 136567 valves to TR2, TR3 cylinder heads	4		
SPRING SETS				
RFK439	Valve Spring Set , as original, with double springs on intake valves and triple springs on exhaust valves	1		
VALVE KEEPERS				
106663	Keeper , split cone, valve springs; eight pairs required per engine; priced for one pair	8		

ENGINE

ENGINE REBUILDING—ROCKER GEAR, TR2, TR3

Alternatives here include purchasing individual components, completely rebuilt rocker assemblies, or high-performance roller rockers. Tappets and push rods are listed at the end of the section.



Part No.	Description	No. Off	List Price	Your Price
----------	-------------	---------	------------	------------

INDIVIDUAL ROCKER COMPONENTS

111064	Rocker Shaft	1		
42880	Screw , locking rocker shaft to rear pedestal	1		
108012	Rocker Assembly , Nos. 1, 3, 5, and 7	4		
108014	Rocker Assembly , Nos. 2, 4, 6, and 8	4		
44370	Bush , rocker arm; included in rockers	16		
109495	Ball Pin , valve adjusting, fitted to rocker arms	8		
57110	Nut , securing ball pins	8		

REBUILT ROCKER ASSEMBLIES,

complete and ready to install

TRFCD221	Rocker Arm Assembly , re-bushed rockers and hard-chromed shaft	1		
CORE50	Refundable Core Charge on the above	1		

HIGH-PERFORMANCE ROLLER ROCKERS;

kits include rockers, adjusting screws, and hardened rocker shaft; pedestals and springs not included

HP207	Roller Rocker Kit , 1.55 : 1 ratio	1		
HP206	Roller Rocker Kit , 1.65 : 1 ratio	1		
HP210	Spacer Kit , allows use of original valve cover; includes spacer and gasket	1		

TAPPETS AND PUSH RODS

57933	Valve Tappet , aka Lifter	8		
106968	Push Rod , stock type and length	8		
TRFCD122	Push Rod Kit , chrome-moly push rods may be adjusted for length to accommodate high-lift applications	1		

ENGINE

ENGINE REBUILDING—ALLOY VALVE COVERS, TR2, TR3

These valve covers quiet valve noise and provide a racy appearance. They are manufactured in England with a choice of three finishes.

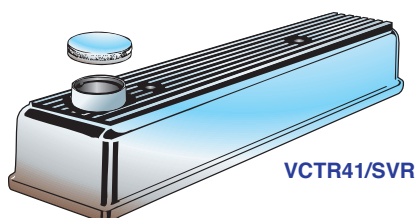

VCTR41/SVR

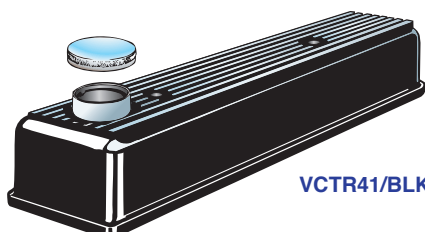

VCTR41/BLK



VCTR42/CRK



TRFC126

HP310

Part No.	Description	No.Off	List Price	Your Price
VCTR41/SVR	Valve Cover , cast alloy, polished finish	1		
VCTR41/BLK	Valve Cover , cast alloy, black finish with polished silver details	1		
VCTR41/CRK	Valve Cover , cast alloy, black crackle finish	1		
	SILICONE GASKETS , for alloy valve covers			
HP310	Gasket , valve cover, silicone, reusable, designed for alloy valve covers	1		
TRFC126	Gasket Adhesive , red Permatex, for securing silicon gasket to valve cover	1		

ENGINE

ENGINE REBUILDING—HARDWARE KITS

It is beyond the scope of this catalogue's format to list every piece of hardware individually. However, this section provides an extensive list of hardware kits which will cover most needs. If individual components of kits are required, please speak to TRF Sales, Level 2 at 800-234-1104. Additional hardware and hardware kits are listed in specific sections of this catalogue

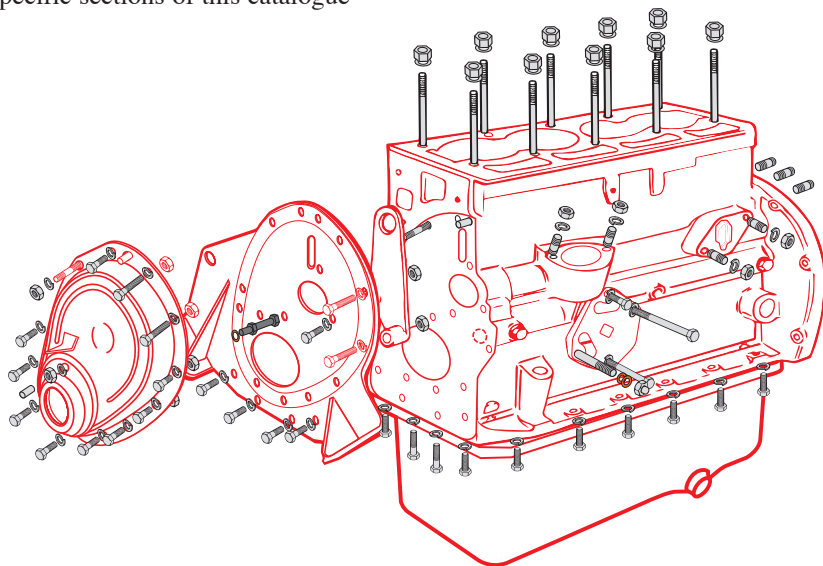

Part No.	Description	No.Off	List Price	Your Price
RFK212	Hardware Kit , securing main bearing caps, 6 bolts and 6 lock washers	1		
RFK2126	Hardware Kit , securing connecting rod bearing caps, 8 bolts and 4 locking plates	1		
RFK2127	Hardware Kit , securing cylinder head to engine block, includes 10 studs, 10 plain washers, and 10 hex nuts, TR2, early TR3 models, up to eng. no. TS13052E	1		
RFK2128	Hardware Kit , securing cylinder head to engine block, includes 10 studs, 10 plain washers, and 10 hex nuts, TR3, TR3A, TR3B after eng. no. TS13052E	1		
RFK2129	Hardware Kit , securing front engine plate to block; does not include timing cover support or tensioner hardware; includes dowels, stud, bolts, lock washers, and nuts (15 pieces)	1		
RFK2130	Hardware Kit , securing timing cover to front engine plate and to block; includes support and related hardware, plus 13 set screws of correct lengths and 13 lock washers (35 pieces)	1		
RFK2140	Hardware Kit , securing front main bearing sealing block, includes 2 screws	1		
RFK2131	Hardware Kit , securing oil sump (oil pan) and breather pipe to block, includes 17 set screws, 2 bolts, and 19 lock washers	1		

Continued on Next Page

ENGINE

ENGINE REBUILDING—HARDWARE KITS—Continued

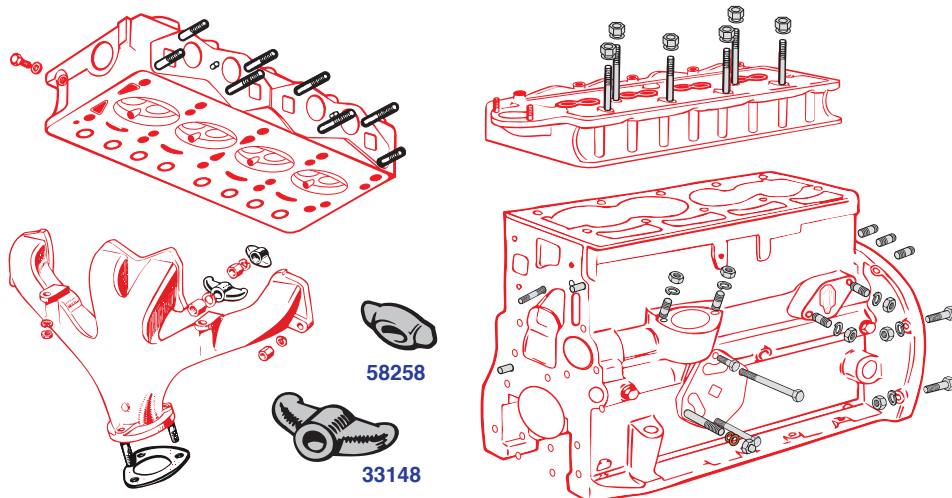

Part No.	Description	No. Off	List Price	Your Price
RFK2132	Hardware Kit , securing oil filter head to engine block, includes stud, bolts of correct lengths, lock washers, copper washers, and cap nut (10 pieces), fitted up to eng. no. TS9951E	1		
RFK2144	Hardware Kit , securing oil filter head to engine block, includes stud, bolts of correct lengths, lock washers, copper washers, and cap nut (10 pieces), fitted after eng. no. TS9951E	1		
RFK2133	Hardware Kit , securing fuel pump to engine block, includes two studs, two lock washers, two hex nuts	1		
RFK2134	Hardware Kit , securing distributor pedestal to engine block, includes two studs, two lock washers, two hex nuts	1		
RFK2135	Hardware Kit , securing gearbox to engine block, includes 2 dowel pins, 3 studs, 6 bolts, 9 lock washers, and 3 hex nuts; does not include starter motor hardware	1		
RFK2136	Hardware Kit , securing starter motor to engine block and to gearbox; includes two bolts, two lock washers, and two hex nuts	1		
RFK2137	Hardware Kit , securing intake and exhaust manifolds to cylinder head; includes 9 studs (an extra one for engines with rear lifting hook), 8 lock washers, and 8 special nuts; purchase clamps separately	1		
58258	Clamp , small, manifold to cylinder head	4		
33148	Clamp , large, manifold to cylinder head	4		
RFK2138	Hardware Kit , securing rocker pedestals to cylinder heads; includes 4 studs, 4 lock washers and 4 hex nuts	1		
RFK2139	Hardware Kit , securing rocker cover to cylinder head; includes 2 studs, 2 plain washers, 2 fibre washers, and two nyloc nuts	1		

FUEL SYSTEM

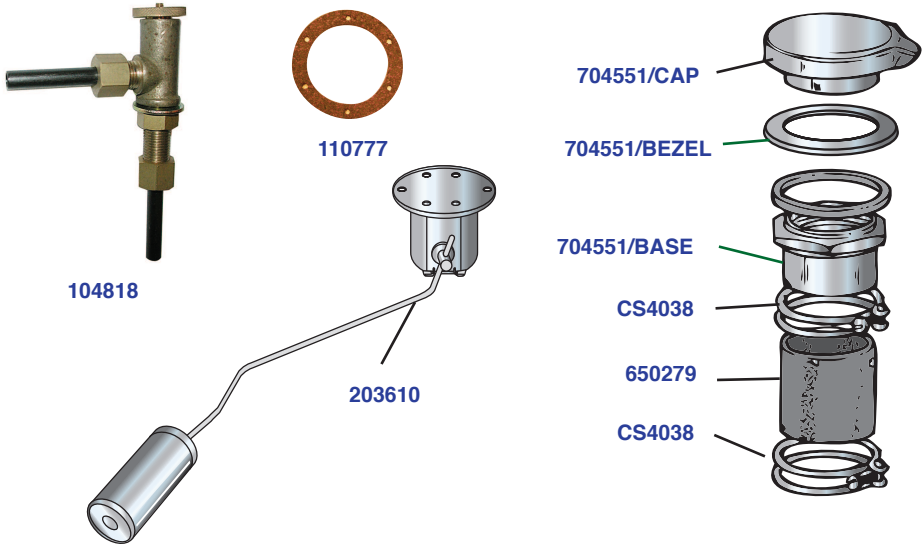
FUEL SYSTEM—FILLER CAP, TANK SENDING UNIT,
SHUT-OFF TAP, TR2, TR3

Part No.	Description	No.Off	List Price	Your Price
FUEL FILLER DETAILS, all TR2, TR3				
RFK1960	FUEL FILLER KIT , comprising indented listings...	1		
704551/CAP	Cap , fuel filler, hinged, chrome	1		
704551/BEZEL	Bezel , chrome, between cap and rear deck panel	1		
704551/BASE	Body , fuel pump, threaded for cap	1		
650279	Hose , connecting fuel cap to tank	1		
CS4038	Clip , securing hose to cap and tank	2		
FUEL TANK SENDING UNIT (GAUGE)				
203610	Sending Unit , fuel gauge, in fuel tank	1		
110777	Gasket , cork, sealing gauge unit to tank	1		
RFK1857	HARDWARE KIT , securing sending unit to fuel tank	1		
TF2504	Screw	6		
WN705	Washer , shakeproof	6		
SHUT-OFF TAP, TR2, TR3, early TR3A models				
104818	Shut-off Valve , fitted to bracket on chassis frame near fuel pump, TR2, TR3, early TR3A	1		
REP431	Cork Seal , included with valve	1		
JN2111	Nut , jam, securing shut-off tap to chassis frame	1		
WP29	Washer , plain, under nut	1		

FUEL SYSTEM

FUEL SYSTEM—FUEL PUMP, REPAIR KIT, FUEL FILTER, TR2, TR3

The Roadster Factory supplies a replica pump which is quite identical to the original AC pump fitted by Triumph. Our replica pump is made in Italy, and it has performed very well for us. Includes glass bowl and priming lever. Suitable for use with ethanol fuels. Our repair kit will fit original AC pumps and our replica pump. It includes high-quality components of correct design and seal to keep fuel out of your engine oil.

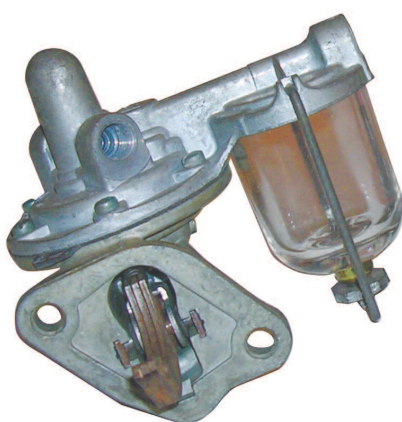

ORIGINAL
AC PUMP

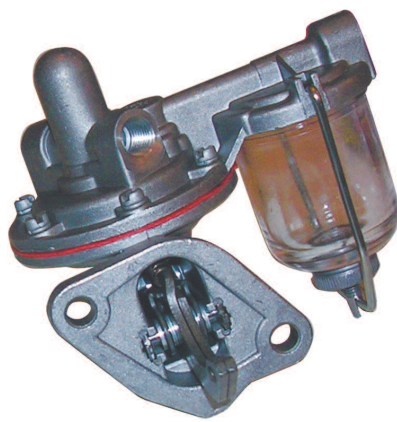

109637
REPLICA PUMP

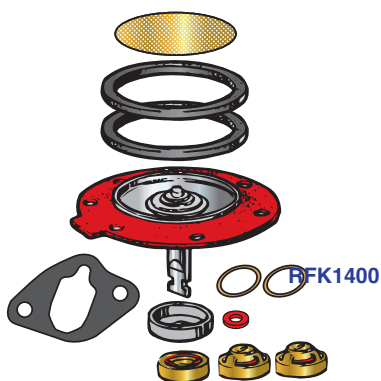

RFK1400



GFF56

Part No.	Description	No.Off	List Price	Your Price
109637	Fuel Pump Assembly , OEM quality	1		
RFK1400	Repair Kit , fits original pump and replica pump listed above	1		
	FUEL FILTER ASSEMBLY , AC brand, metal case			
GFF56	Fuel Filter	1		

FUEL SYSTEM

FUEL SYSTEM—CARBURETTOR REPAIR, TR2, TR3

TRF supplies the best repair kits on the market for both SU H4 and SU H6 carbs. SU H4 carbs were fitted to TR2 models and SU H6 carbs were fitted to TR3, TR3A, and some TR3B models.

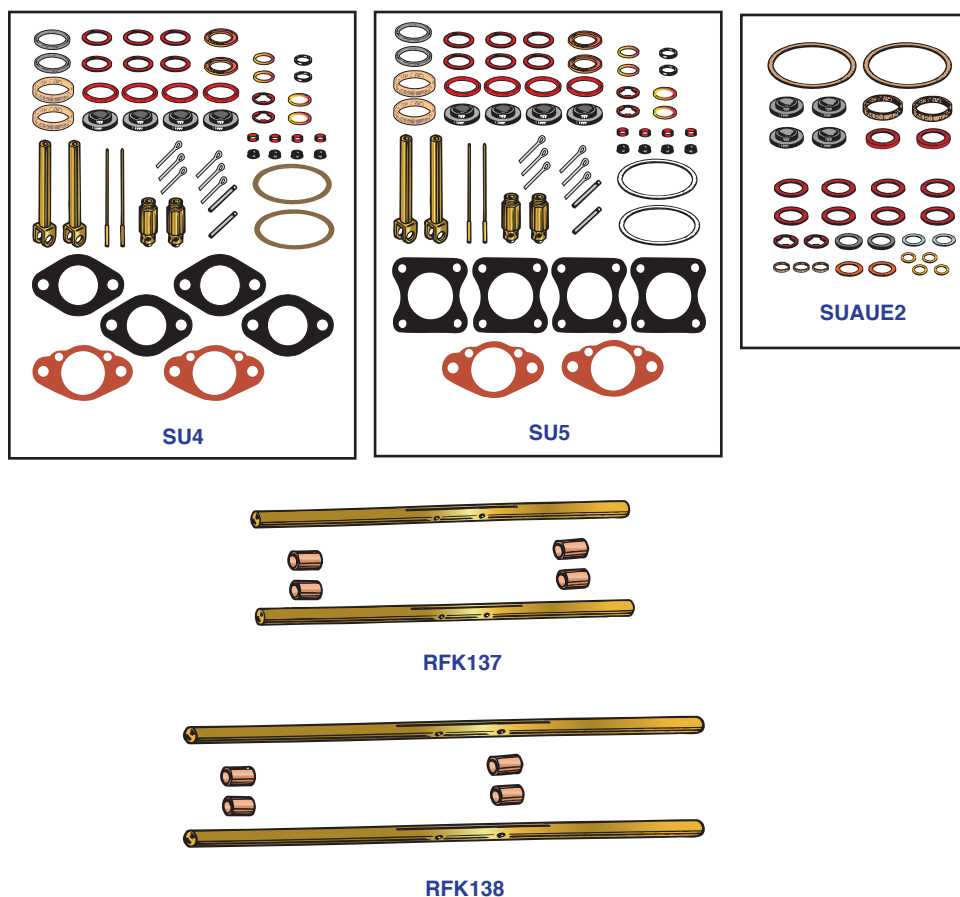

Part No.	Description	No.Off	List Price	Your Price
CARBURETTOR REPAIR KITS				
SUAUE2	Gasket Kit , services two H4 or H6 carbs; very complete gasket kit	1		
SU4	Major Rebuild Kit , H4 carbs; includes gaskets, needles, jets, and float chamber needle valves, TR2	1		
SU5	Major Rebuild Kit , H6 carbs; includes gaskets, needles, jets, and float chamber needle valves, TR3, TR3A, maybe TR3B	1		
THROTTLE SHAFT KITS; include one pair of throttle shafts and four replacement bushes				
RFK137	Throttle Shaft Kit , SU H4 carbs	1		
RFK138	Throttle Shaft Kit , SU h6 carbs	1		

P.S. Please note that throttle shaft bushes must be reamed in alignment after installation. This is work for a good automotive machine shop.

Continued on Next Page

FUEL SYSTEM

FUEL SYSTEM—CARBURETTOR REPAIR, TR2, TR3 —Continued



RFP513

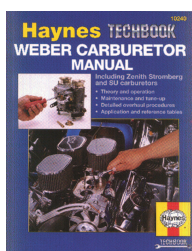

RFP500

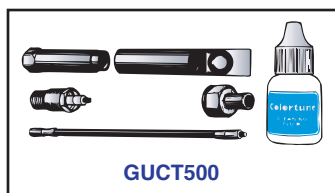

GUCT500

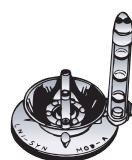

CAT2



CAT3

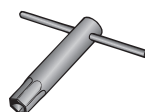

CAT4

Part No.	Description	No.Off	List Price	Your Price
----------	-------------	--------	------------	------------

WORKSHOP MANUALS

RFP500	Haynes Carburettor Workshop Manual , covers SU, Zenith-Stromberg, and Weber carbs	A/R
RFP513	SU Carburettor High-Performance Manual	A/R

BASIC TOOLS

CAT3	Wrench , adjusting SU H6 carb jets	1
CAT2	Air Flow Meter , for matching throttle settings; called a "Unisyn"	1
CAT4	Wrench , for servicing SU float chamber needle valves	1
GUCT500	Colortune Tune-up Kit ; allows setting of fuel mixture by observing the colour of combustion inside the engine	1

FUEL SYSTEM—CARBURETTOR HEAT SHIELDS, TR2, TR3

If fuel vaporizes too quickly before it gets into the combustion chamber, the engine will not run well, a common occurrence during hot weather. Heat shields protect the carburetors from heat radiated by the exhaust manifold. Developed by racers in the past. Available to all of us now.



HP188



HP192

Part No.	Description	No.Off	List Price	Your Price
----------	-------------	--------	------------	------------

HP188	Heat Shield , TR3, TR3A, TR3B with SU H6 carbs	1
HP192	Heat Shield , fits Weber side-draught carbs; one req. per carb	2

FUEL SYSTEM

FUEL SYSTEM—CARBURETTOR LINKAGE AND CHOKE CABLE, TR2, TR3

You can use selections from this list of components manufactured by TRF to keep your throttle linkage tight and responsive.

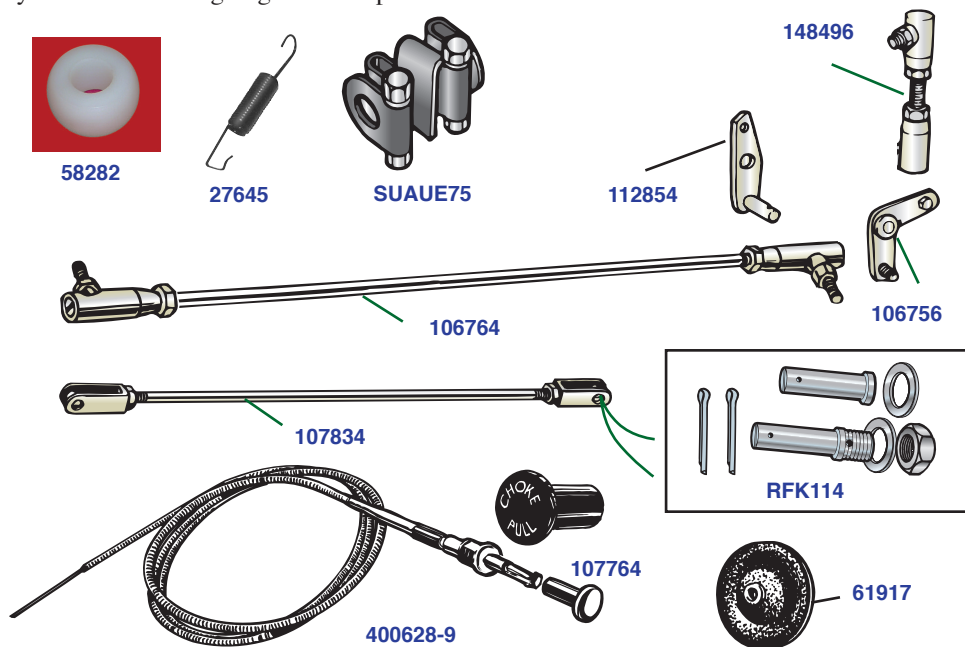

Part No.	Description	No. Off	List Price	Your Price
----------	-------------	---------	------------	------------

THROTTLE LINKAGE

58282	Bush , nylon, accelerator cross-shaft; bushes are located in housings on the bulkhead	2		
27645	Spring , return, accelerator shaft lever	1		
106764	Link Rod , long, horizontal, with end joints	1		
106756	Lever , bell crank	1		
112854	Bracket , pivot, bell crank lever, on intake manifold	1		
148496	Link Rod , short, vertical, with end joints	1		
SUAUE75	Folded Coupling , connecting front and rear carb throttles	2		

CHOKE CABLE AND LINKAGE

400628-9	Choke Cable Assembly , with knob	1		
107764	Knob , choke cable	1		
61917	Grommet , rubber, choke cable to hole in bulkhead	1		
107834	Link Rod , with clevis ends, connecting carburettor jet levers	1		
RFK114	Pin Kit , securing link rod and choke cable to jet lever on front carb; includes special joint pin, washers, lock nut, and cotter pin	1		
PJ8506	Pin , joint, securing link rod to jet lever on rear carb	1		
PC8	Pin , cotter, securing joint pin	1		

COOLING SYSTEM

COOLING SYSTEM—COOLING FANS, TR2, TR3

The original metal fan is still available for concours enthusiasts, but the yellow plastic fan from TR250, early TR6 is better for cooling. The yellow fan may be fitted to the original fan hub by turning it backward, or a new specially-designed hub can be fitted. Once installed, it is not noticeable that the fan is turned backwards or forwards.

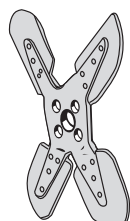

202025

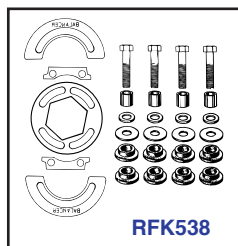

RFK538

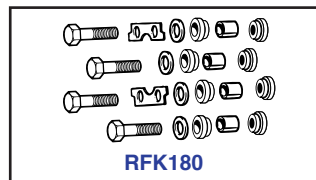

RFK180



308353



108496/U



RFK1597

Part No.	Description	No.Off	List Price	Your Price
----------	-------------	--------	------------	------------

ORIGINAL METAL FAN

202025	Fan , metal, four blades, as original	1		
RFK538	FITTING KIT , original fan	1		
108496	Bush , rubber	8		
108499	Sleeve , steel, inside rubber bushes	4		
108495	Washer , plain, over outside bushes	4		
108497	Washer , lock, securing crankshaft center bolt	1		
107858	Balance Piece , fan	A/R		
HB811	Bolt , securing fan to hub extension	4		
WP34	Washer , plain, under heads of bolts	4		
107857	Locking Plate , securing bolts	2		

YELLOW PLASTIC FAN

308353	Fan , yellow plastic	1		
RFK180	FITTING KIT , yellow fan, for use with original TR2, TR3 fan hub extension	1		
108496	Bush , rubber	8		
108499	Sleeve , steel, fitted in rubber bushes	4		
108495	Washer , plain, fitted on outsides of rubber bushes	4		
HB811	Bolt , securing fan to hub	4		
107857	Locking Plate , securing bolts	2		
RFK1597	ADAPTOR KIT , plastic fan; shorter extension replaces original TR2, TR3 fan hub; includes mounting hardware	1		

ALTERNATIVE FITMENT

108496/U	Bush , urethane, can be substituted for 108496 rubber bushes in any of the assemblies listed above	8		
----------	---	---	--	--

COOLING SYSTEM

COOLING SYSTEM—WATER PUMPS AND FAN BELTS,
TR2, TR3

Several water pump configurations are described below. The five-vane pump is an attempt to provide more water circulation to improve cooling.

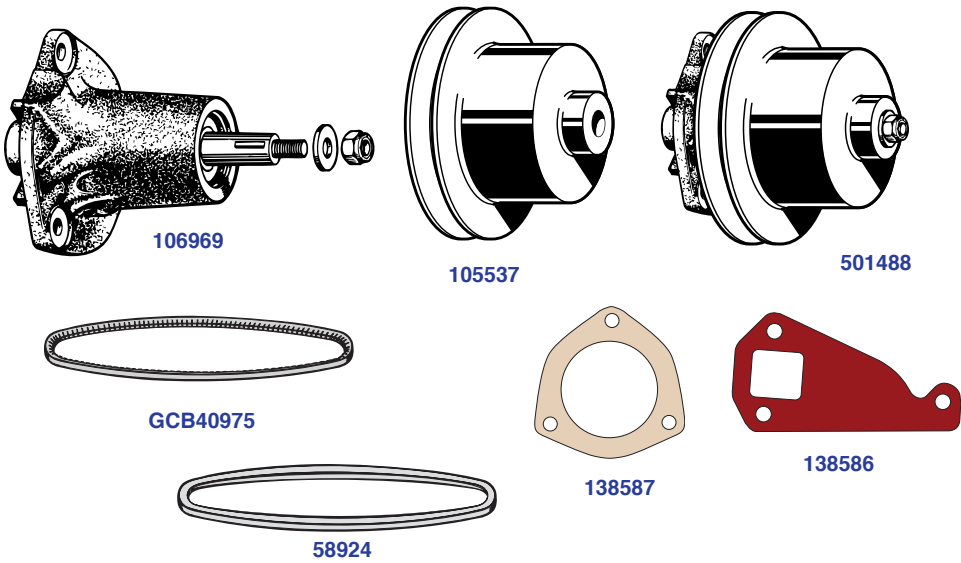

Part No.	Description	No.Of	List Price	Your Price
501488	Water Pump Assembly , with pulley	1		
106969	Water Pump Assembly , without pulley, four vane pump	1		
HP106969	Water Pump Assembly , without pulley, five vane pump	1		
105537	Pulley , water pump	1		
	HARDWARE , securing pulley to pump			
KW420	Key , locating pulley on pump shaft	1		
WP181	Washer , securing pulley to shaft	1		
TN3208	Nut , nyloc, securing pulley to shaft	1		
RFK1836	HARDWARE KIT , securing water pump housing to engine block; includes three bolts and three lock washers	1		
RFK1837	HARDWARE KIT , securing water pump to water pump housing; includes two studs, one bolt, three lock washers, and two nuts	1		
	GASKETS			
138586	Gasket , water pump housing to engine block	1		
138587	Gasket , water pump to water pump housing	1		
	FAN BELTS			
58924	Fan Belt , original type, high quality	1		
GCB40975	Fan Belt , cogged type	1		

COOLING SYSTEM

COOLING SYSTEM—RADIATORS, TR2, TR3

Original style radiators are still available for most TR2 and TR3 applications. In addition, TRF offers high-performance alloy radiators with and without electric cooling fans.

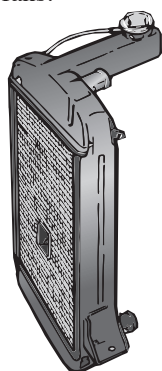

400412

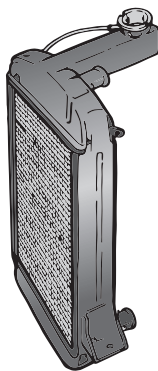

400412/WO

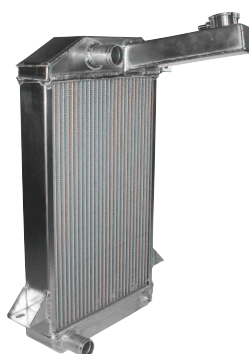

HP651



HP651/FAN

Part No.	Description	No.Off	List Price	Your Price
----------	-------------	--------	------------	------------

ORIGINAL STYLE RADIATORS

400311	Radiator , cooling, TR2 up to TS1201	1		
400412	Radiator , cooling, TR2, TR3 models after comm. no. TS1201; with hole for starting crank as original	1		
400412/WO	Radiator , cooling, TR2, TR3 models after comm. no. TS1201; without hole for starting crank	1		

MODERN ALLOY RADIATORS; without hole for starting crank, all TR2, TR3, TR3A, TR3B

HP651	Radiator , cooling, alloy	1		
HP651/FAN	Radiator , cooling, alloy, with electric fan, wiring harness, temperature sensor, relay, and instructions	1		

COOLING SYSTEM—DRAIN TAPS, TR2, TR3

The brass taps are still available and they are worth updating, as they are part of the character of the TR2 and TR3 models which has been lost on modern vehicles



61478



61864

Part No.	Description	No.Off	List Price	Your Price
----------	-------------	--------	------------	------------

61478	Brass Tap , water drain, engine block	1		
WF511	Washer , fibre, sealing tap to engine block	1		
61864	Brass Tap , water drain, original radiators; may not be applicable to replacement radiators	1		

COOLING SYSTEM

RADIATOR CAPS AND THERMOSTATS, TR2, TR3

Make sure these components are in good working condition, as failure of these minor parts can create cooling problems.

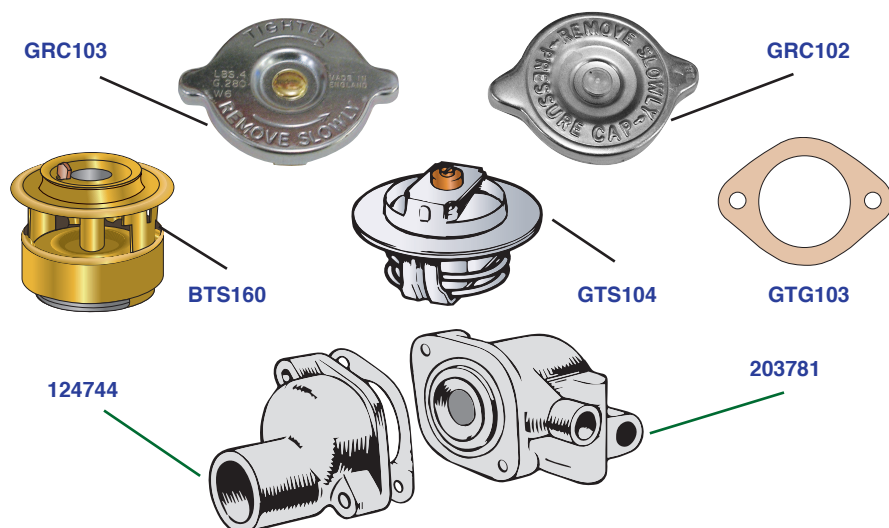

Part No.	Description	No.Off	List Price	Your Price
RADIATOR CAPS, TR2, TR3 models				
GRC103	Cap , radiator, four pounds pressure, one-inch reach, TR2, TR3, TR3A	1		
GRC102	Cap , radiator, seven pounds pressure, one-inch reach, TR3B	1		
THERMOSTATS				
BTS160	Thermostat , original bellows type, 160 degrees F.	1		
BTS185	Thermostat , original bellows type, 185 degrees F.	1		
GTG103	Gasket , thermostat	1		
THERMOSTATS, modern type; can be used on TR2, TR3 if bypass hose to radiator is blocked				
GTS102	Thermostat , 165 degrees F.	1		
GTS104	Thermostat , 180 degrees F.	1		
GTG103	Gasket , thermostat	1		
THERMOSTAT HOUSING, fits TR3, TR3A, TR3B				
203781	Housing , thermostat	1		
124744	Cover , outlet, thermostat housing	1		
RFK1871	Hardware Kit , thermostat housing to cylinder head; includes gasket	1		
RFK1872	Hardware Kit , outlet cover to thermostat housing; includes gasket	1		
GTG103	Gasket , thermostat housing to cylinder head and outlet cover to housing	2		

COOLING SYSTEM

COOLING SYSTEM—WATER TEMPERATURE GAUGE FITTINGS, TR2, TR3

TRF has kept the fittings listed here available over the years to the delight of TR2, TR3 concours enthusiasts.

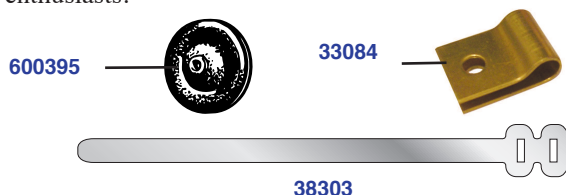

Part No.	Description	No.Off	List Price	Your Price
600395	Grommet , rubber, capillary tube to hole in bulkhead	1		
33084	Clip , folded, brass, securing capillary tube to bulkhead stays	2		
38303	Clip , aluminium strap, securing capillary tube to fuel pipe along LH side of engine; install and cut to length	A/R		
RFP1033	Drawing , showing correct run of the capillary tube with fittings	1		

COOLING SYSTEM—DELUXE WATER HOSE KIT, TR2, TR3

This kit, manufactured exclusively for The Roadster Factory contains four radiator hoses, (upper, lower, and bypass) and four heater hoses (two on bulkhead and two under dash), along with a complete set of sixteen Supergrip hose clips.

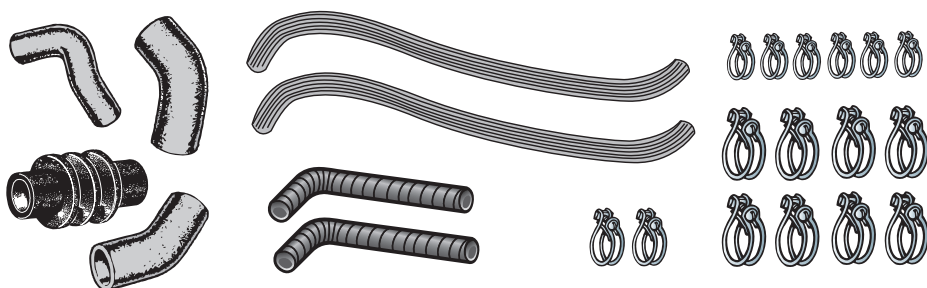

Part No.	Description	WHS46	No.Off	List Price	Your Price
WHS46	Deluxe Water Hose Kit ; includes all four radiator hoses and all four heater water hoses, plus sixteen hose clips		1		

COOLING SYSTEM

COOLING SYSTEM—INDIVIDUAL RADIATOR AND
HEATER HOSES, TR2, TR3

All of TRF's hoses for these models are made to match factory originals as closely as possible. They are high-quality hoses, and they do not generally let anyone down on the road.

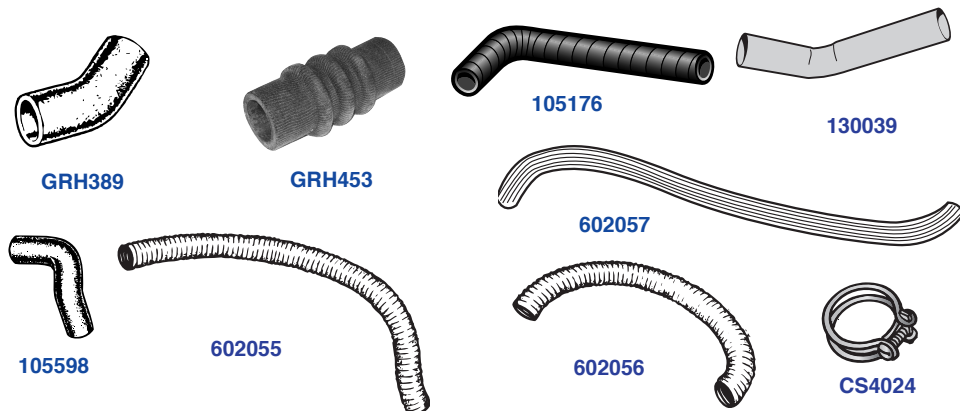

Part No.	Description	No.Off	List Price	Your Price
RADIATOR HOSES				
GRH453	Hose , cloth covered, radiator top, from thermostat housing to radiator inlet	1		
105598	Hose , cloth covered, radiator bypass, from thermostat housing to water pump housing	1		
GRH389	Hose , rubber, radiator bottom, from radiator outlet to connector pipe and from connector pipe to water pump housing	2		
130039	Pipe , connector, metal	1		
HEATER HOSES				
105176	Hose , L-formed, bulkhead pipes to water valve and to return pipe under bonnet	2		
602057	Hose , striated, bulkhead pipes to heater, under dash	2		
HOSE CLIPS				
CS4027	Clip , Supergrip type, radiator top hose and radiator bottom hoses	6		
CS4017	Clip , Supergrip type, radiator bypass hose	2		
CS4012	Clip , Supergrip type, heater hoses	8		
DEMISTER HOSES , from heater to demisters behind dash				
602056	Hose , air, heater to LH demister	1		
602055	Hose , air, heater to RH demister	1		

COOLING SYSTEM

COOLING SYSTEM—HEATER WATER VALVES AND PIPES, TR2, TR3

The Roadster Factory has manufactured most of the parts listed here, including the brass water valve which is our pride and joy, very beautiful with its green painted twist handle.

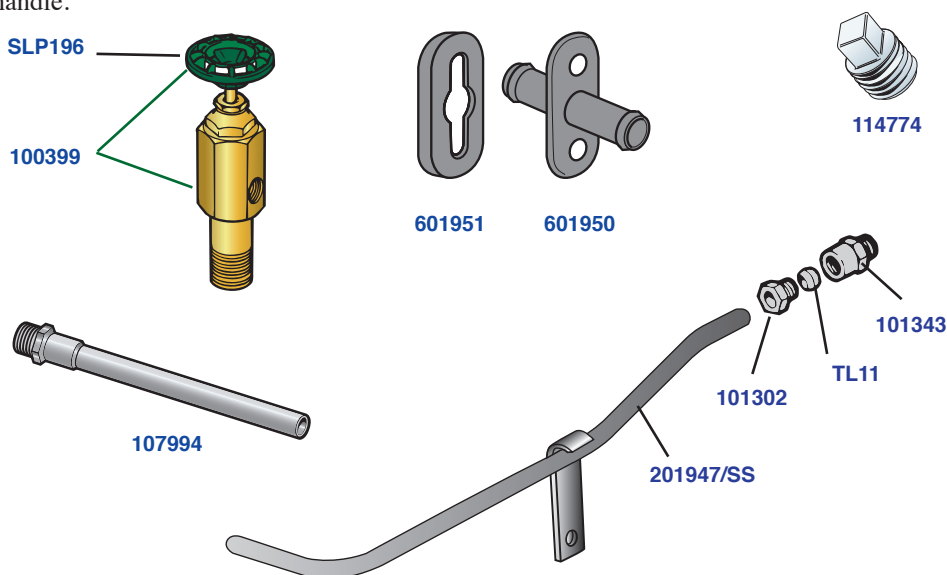

Part No.	Description	No.Off	List Price	Your Price
HEATER WATER VALVE , mounted on cylinder head				
100399	Valve , brass, with green twist handle	1		
SLP196	Handle , twist, painted green	1		
107994	Pipe , extension, screwed into heater valve	1		
RFK742	BULKHEAD HEATER CONNECTION KIT ; comprising two bulkhead connections, rubber gaskets, and attachment hardware	1		
601950	Connection Pipe , bulkhead	2		
601951	Gasket , rubber, connection pipes	2		
YJ2464	Screw , securing bulkhead pipes	4		
FU2585	Fix Nut , securing bulkhead pipes	4		
HEATER RETURN PIPE , on LH side of engine				
201947/SS	Pipe , heater water return, stainless steel	1		
101343	Adaptor , return pipe to water pump housing	1		
101302	Nut , tubing, connecting return pipe to adaptor	1		
TL11	Sleeve , tubing, sealing joint	1		
114774	Plug , blanking hole in water pump housing on models not fitted with heaters	1		

COOLING SYSTEM

RADIATOR AIR DEFLECTOR, TR3A, TR3B MODELS

The air deflector is made of fibreboard, and it must be painted before installation to protect it from water impregnation. I am going to try something different next time I change this, and I will let you know how it comes out. Note that the bumper over-rider support tubes help to secure the air deflector against the inner fenders behind the grille.

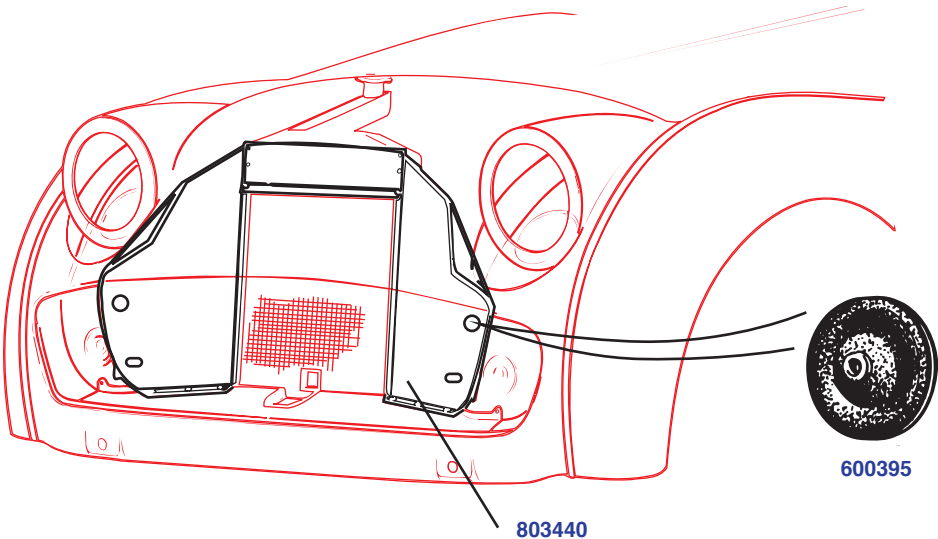

Part No.	Description	No.Off	List Price	Your Price
803440	Radiator Air Deflector , to be painted in body colour	1		
RFK1471	HARDWARE KIT , securing air deflector to flat area inside front apron—the parts catalogue says four screws, but my car had six, and I know it was original, so the kit has six	1		
YA404	Screw , self-tapping	6		
515128	Washer , plain, on screws	6		
600395	Grommet , fitted to holes in air deflector, to seal leads to signal lamps	2		

EXHAUST SYSTEM

EXHAUST SYSTEM—MILD STEEL COMPONENTS, TR2, TR3

These are not always readily available, but they are in stock from time to time. I will just list them individually rather than in kits. If you prefer mild steel to stainless steel, please ask a salesperson for availability to avoid a long backorder situation. A shiny tail pipe extension seems always to have been fitted, but possibly, the early tail pipe was of smaller diameter than the later ones listed here.

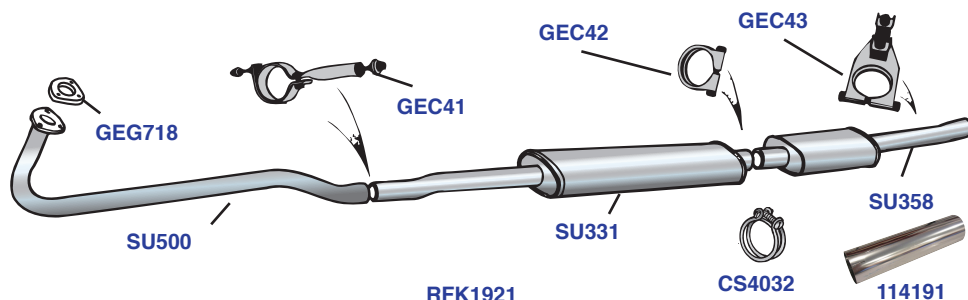

Part No.	Description	No.Off	List Price	Your Price
SU500	Front Exhaust Pipe (Downpipe) , mild steel, all TR2, TR3	1		
SU331	Center Muffler , mild steel, all TR2, TR3	1		
202009	Rear Exhaust Pipe , mild steel, fitted up to comm. no. TS11384	1		
SU358	Rear Muffler , mild steel, fitted after comm. TS11384	1		
114191	Extension , aluminium, tail pipe	1		
CS4032	Clip , Supergrip, securing extension to tail pipe	1		

EXHAUST SYSTEM—HANGERS AND CLAMPS, TR2, TR3

The Roadster Factory has sourced all of the hangers and clamps and related hardware, and they are generally in stock. Actually, the mounting we use for the “cruciform” under the gearbox was not originally used until later, and it might present some questions to anyone trying to use it on a car with a commission number earlier than TS4310

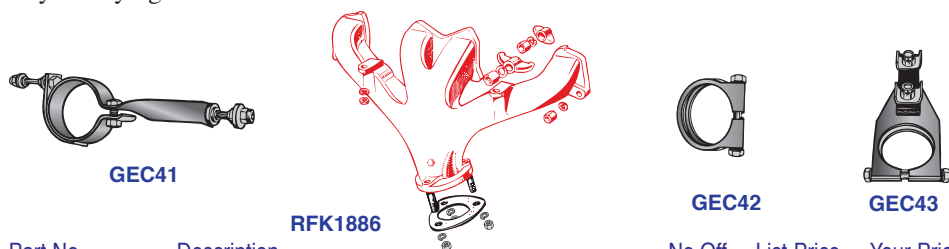

Part No.	Description	No.Off	List Price	Your Price
RFK1886	Hardware Kit , exhaust flange to exhaust manifold	1		
GEC41	Cruciform Mounting Kit , at connection between front pipe and center muffler	1		
GEC42	Clamp Kit , center muffler to rear muffler	1		
GEC43	Hanger Kit , rear muffler; includes flexible hanger, bracket, and correct hardware	1		

EXHAUST SYSTEM

EXHAUST SYSTEM—STAINLESS STEEL COMPONENTS, TR2, TR3

TRF stocks Falcon brand stainless steel exhaust components with which we have had good luck for more than thirty years. For TR2 and TR3, we supply Falcon’s versions of the front pipe, the center muffler, and the rear muffler. A concours enthusiast wanting to use the original style tail pipe extension would have to do some trimming and fitting to get the right look. Most clubs do not take off points for stainless steel exhausts in concours judging. I am not sure if they require the tail pipe extension. The hangers and clamps supplied with the stainless steel systems are those listed in the previous section.

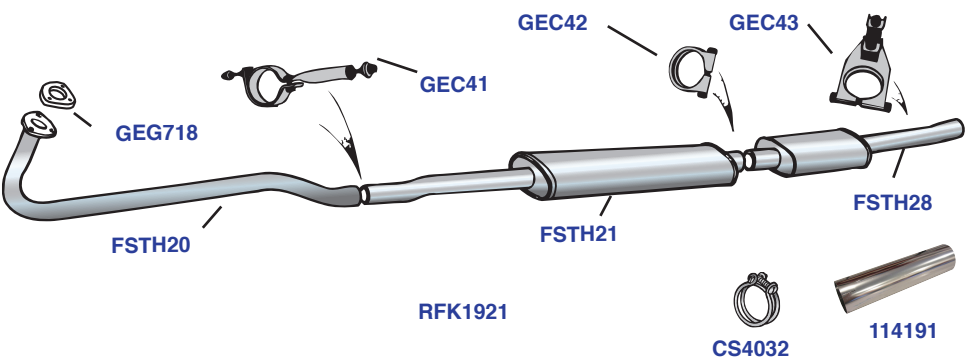

Part No.	Description	No.Off	List Price	Your Price
RFK1921	STAINLESS STEEL EXHAUST KIT, downpipe, center muffler, and rear muffler, complete with flange gasket, manifold studs and nuts, and all hangers and clamps (tail pipe extension not included)	1		
RFK106	STAINLESS STEEL EXHAUST KIT, includes downpipe, center muffler, rear muffler, and flange gasket only	1		
FSTH20	Front Pipe (Downpipe), stainless steel	1		
FSTH21	Center Muffler, stainless steel	1		
FSTH28	Rear Muffler, stainless steel	1		
GEG718	Gasket, exhaust flange	1		
RFK354	TAIL PIPE EXTENSION KIT; not easily usable with stainless steel systems	1		
114191	Extension, tail pipe, aluminium pipe per factory design	1		
CS4032	Clip, securing extension to tail pipe on rear muffler	1		

EXHAUST SYSTEM

EXHAUST SYSTEM—MONZA FREE-FLOW EXHAUST SYSTEM, TR2, TR3

If you've never driven your car with a free flow system, it can be very pleasant. The accelerator pedal is more responsive, and indeed, the horsepower is raised a bit. The sound is deeper and more throaty too. You must have an original front pipe to fit the Monza system, and some hangers and clamps are supplied with the kit. It is pretty easy to produce a workmanlike level of installation.

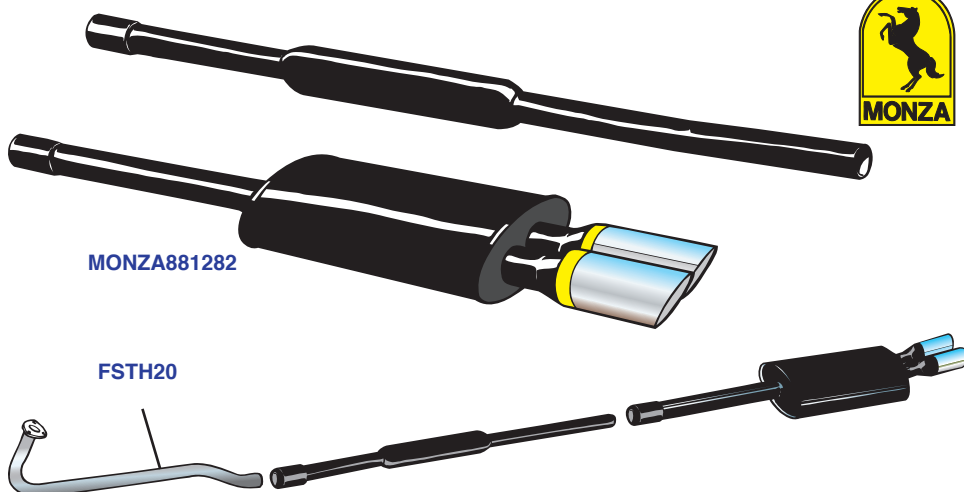

Part No.	Description	No.Off	List Price	Your Price
MONZA881282	Monza Free-Flow Exhaust System, includes center muffler and rear muffler with twin chromed tail pipes	1		
FSTH20	Front Pipe (Downpipe), stainless steel; required for installation of the Monza free-flow exhaust	1		

Photo shows a Falcon stainless steel exhaust system fitted to John Swauger's 1958 TR3A which has been restored.

