

STEERING

STEERING RACK REBUILD COMPONENTS

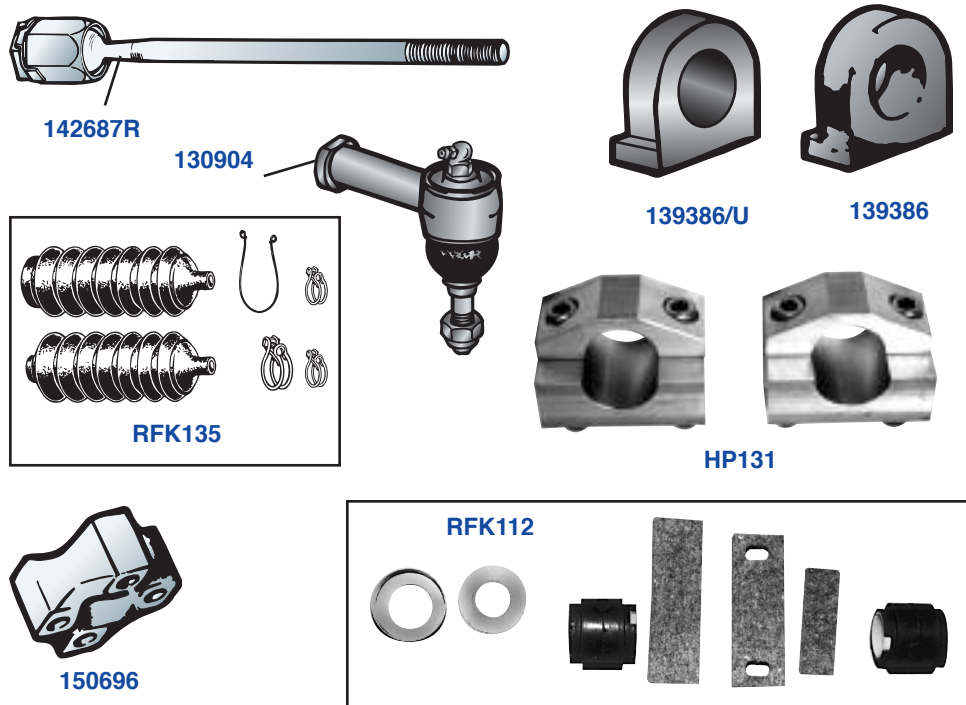

Part No.	Description	No. Off	Current Prices on Website
----------	-------------	---------	---------------------------

STEERING RACK REBUILD COMPONENTS

129961R	Inner Tie Rod End , rebuilt by C.A.R. Components, TR4 only	2
CORE20	Core charge on the above	2
142687R	Inner Tie Rod End , rebuilt by C.A.R. Components, TR4A only	2
CORE20	Core charge on the above	2
130904	Outer Tie Rod End , greaseable, TR4, TR4A	2
RFK135	Rubber Boot Kit , steering rack; includes two boots and correct hardware	1
139386	Steering Rack Mount , stock grade, later TR4, TR4A	2
139386/U	Steering Rack Mount , urethane, later TR4, TR4A	2
HP131	Steering Rack Mounting Kit , alloy	1
RFK112	Mounting Kit , steering column; includes steering column bushes and felt strips; cures a wobbly steering column	1
130044	Flexible Steering Joint , TR4, TR4A, original type	2
150696	Flexible Steering Joint , later type with countersunk holes; can be used in place of 130044 when fitted with hardware listed below	2
128323	Bolt , drilled	8
158701	Wire , locking	4

STEERING

MOTO LITA STEERING WHEELS

“Classic Wood Rims or Comfortable Leather-wrapped Rims”



ML101



ML201



ML301



TRFCD47

Part No.	Description	No. Off	Current Prices on Website
----------	-------------	---------	---------------------------

WOOD-RIMMED STEERING WHEELS;

Moto-Lita Mk.3; laminated marine timber with rivets and three polished alloy spokes with thin slots

ML100	Steering Wheel , 14-inch, flat	1
ML101	Steering Wheel , 14-inch, dished	1
ML103	Steering Wheel , 15-inch, flat	1
ML104	Steering Wheel , 15-inch, dished	1

LEATHER STEERING WHEELS;

Moto-Lita Mk.4; leather rim, three polished alloy spokes with thin slots

ML201	Steering Wheel , 14-inch, flat	1
ML202	Steering Wheel , 14-inch, dished	1
ML203	Steering Wheel , 15-inch, flat	1
ML204	Steering Wheel , 15-inch, dished	1

LEATHER STEERING WHEELS,

Moto-Lita Mk.4, leather rim, three black spokes with thin slots

ML301	Steering Wheel , 14-inch, flat	1
ML302	Steering Wheel , 14-inch, dished	1
ML303	Steering Wheel , 15-inch, flat	1
ML304	Steering Wheel , 15-inch, dished	1

TRFCD47	HUB KIT , steering wheel mounting; black crackle finish, Triumph logo	1
---------	--	---

FRONT SUSPENSION AND STEERING MAGIC KITS, EARLY TR4

This exploded view diagram illustrates the assembly of a vehicle chassis. The components are organized into several rows and columns, showing the relationship between different parts. Key components include:

- Top Row:** Two large cylindrical components (likely shock absorbers or struts) with associated mounting hardware, two yellow hydraulic cylinders, and two black steering knuckles.
- Second Row:** Various mounting brackets, bolts, and nuts, including a large black coil spring with a wire.
- Third Row:** More mounting brackets, bolts, and nuts, along with two black coil springs with wires.
- Fourth Row:** Two sets of wheel hubs and brake components, including brake discs and calipers.
- Fifth Row:** A large number of small circular components, likely wheels or tires, arranged in a grid.
- Sixth Row:** A large number of small circular components, likely wheels or tires, arranged in a grid.
- Seventh Row:** A large number of small circular components, likely wheels or tires, arranged in a grid.
- Eighth Row:** A large number of small circular components, likely wheels or tires, arranged in a grid.

RFK1348

Section Continues On Next Page

FRONT SUSPENSION AND STEERING MAGIC KITS, LATER TR4

Section Continues On Next Page

FRONT SUSPENSION

FRONT SUSPENSION AND STEERING MAGIC KITS, TR4A

Kits include bushes, trunnions, ball joints, outer tie rod ends, steering rack boots, and hardware

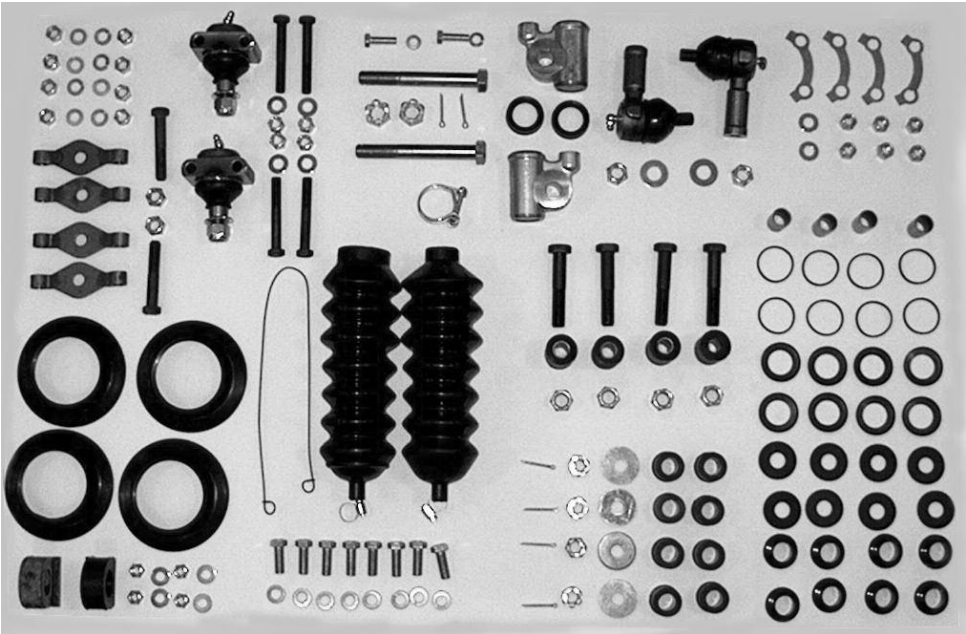

RFK1316

Part No.	Description	No. Off	Current Prices on Website
RFK1316	Magic Front Suspension Kit, TR4A, stock grade; with rubber upper control arm bushes, and rubber and steel lower inner control arm bushes	1	
RFK1330	Magic Front Suspension Kit, TR4A, urethane; same as previous listing but with urethane upper and lower control arm bushes	1	

FRONT SUSPENSION

FRONT SUSPENSION REBUSHING KITS

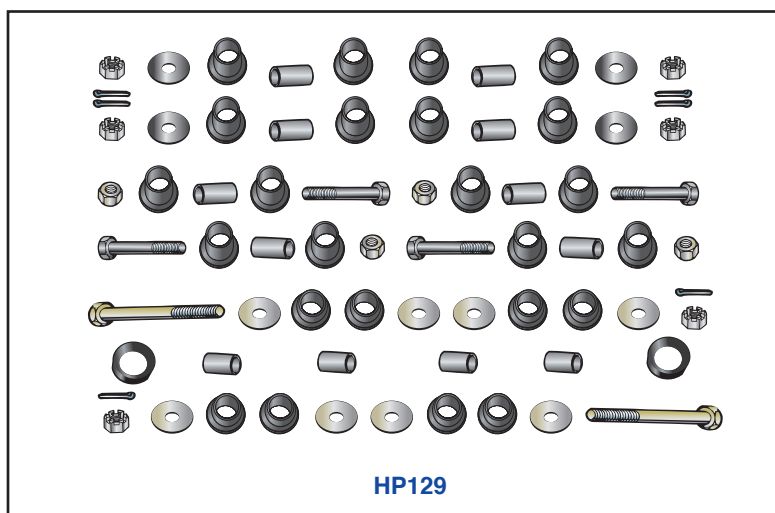
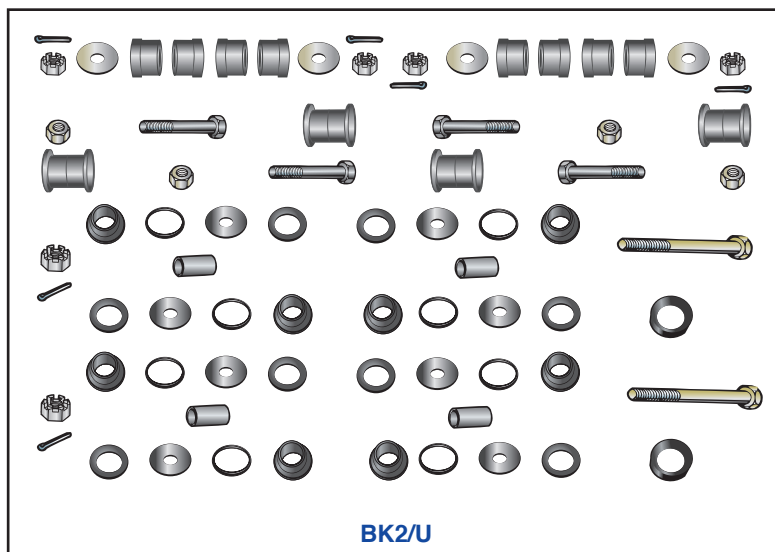
“Lots of Choices for Different Levels of Performance”

Part No.	Description	No. Off	Current Prices on Website
RE-BUSHING KITS FOR TR4			
BK1	Re-bushing Kit , TR4, with rubber wishbone bushes as original	1	
BK1/U	Re-bushing Kit , TR4, with urethane wishbone bushes	1	
RE-BUSHING KITS FOR TR4A			
BK2	Re-bushing Kit , TR4A, with rubber upper wishbone bushes	1	
BK2/U	Re-bushing Kit , TR4A, with urethane upper wishbone bushes	1	
HP129	Re-bushing Kit , TR4A, front suspension; high-performance nylatron bushes with steel sleeves for upper and lower pivot points	1	

FRONT SUSPENSION

UPPER FULCRUM PINS

102228

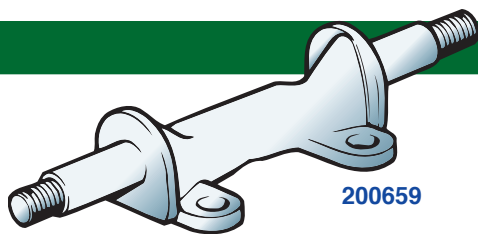
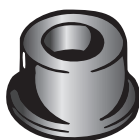

200659

Part No.	Description	No. Off	Current Prices on Website
200659	Upper Fulcrum Pin	2	
102228	Bush , rubber, upper fulcrum; included in rebuild kits listed on previous page	8	
102228/U	Bush , urethane, upper fulcrum; included in rebuild kits listed on previous page	8	

BALL JOINTS AND TRUNNIONS

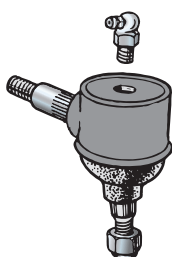

200772

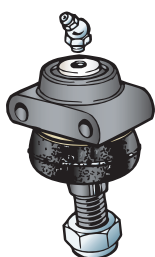

142394

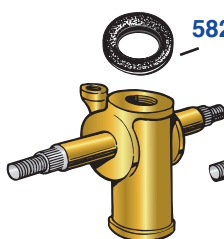

101557

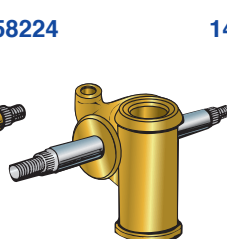

133838

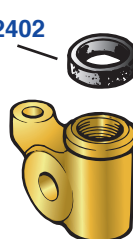

142378

Part No.	Description	No. Off	Current Prices on Website
----------	-------------	---------	---------------------------

BALL JOINTS

200772	Ball Joint , early type, with studs that fit through the upper wishbone arms, early TR4	2	
142394	Ball Joint , later type; secured by bolts and nuts, later TR4, TR4A	2	

LOWER TRUNNIONS

101557	Trunnion , with cross pin; pins are not slanted, early TR4	2	
58224	Seal , trunnion, early TR4	2	
133839	Trunnion , with slanted cross pin, later TR4, L.H.	1	
133838	Trunnion , with slanted cross pin, later TR4, R.H.	1	
142378	Trunnion , TR4A, L.H., no cross pin, uses bolt through trunnion and lower wishbone arms	1	
142377	Trunnion , TR4A, R.H., no cross pin, uses bolt through trunnion and lower wishbone arms	1	
142402	Seal , trunnion, later TR4, TR4A	2	

FRONT SUSPENSION

FRONT SUSPENSION MOUNTING BRACKETS, TR4A

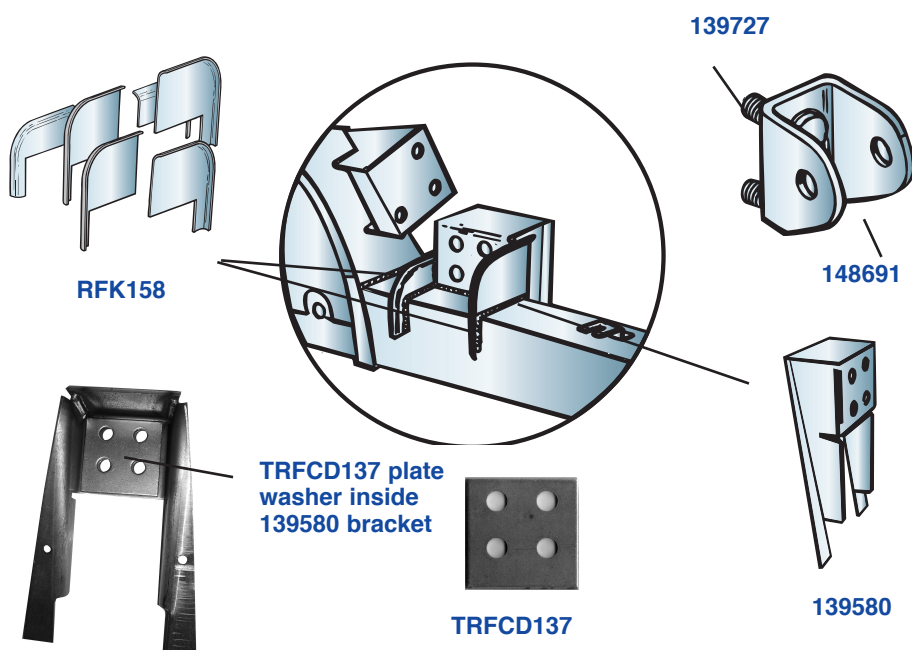

Part No.	Description	No. Off	Current Prices on Website
----------	-------------	---------	---------------------------

CHASSIS BRACKET REPAIR,

TR4A only

139580	Bracket , front suspension mounting; welded to chassis frame	4
RFK158	Gusset Kit ; includes six gussets for reinforcing the four brackets listed above	1
148691	Pivot Bracket Assembly , front suspension	4
TRFCD137	Plate Washer , reinforcing pivot bracket attachment; per Kas Kastner's instruction in the TR4, TR4A competition manual	4
139727	Shim , front wheel alignment; fitted between pivot brackets and front suspension mounting brackets	A/R
YN2909	Nyloc Nut , securing pivot brackets	8
WM59	Washer , plain, used with nyloc nuts	8

FRONT SUSPENSION

SHOCK ABSORBERS

“Lots of Alternatives to Suit Any Driving Style”



RFK737



RFK738



AR62-1395



AR62-2080



SPAX101



KONI80A-1784

Part No.	Description	No. Off Current Prices on Website
FRONT TUBE SHOCKS, TR4		
AR62-2080	Tube Shock , stock grade	2
KONI80-1005SP	Tube Shock , Koni brand high-performance shock	2
SPAX101	Tube Shock , Spax brand high-performance shock	2
FRONT TUBE SHOCKS, TR4A		
AR62-1395	Tube Shock , stock grade	2
KONI80A-1784	Tube Shock , Koni brand high-performance shock	2
SPAX102	Tube Shock , Spax brand high-performance shock	2
LOWER SHOCK MOUNTING BRACKETS; replace these with new if they are rusted solid or bent out of alignment		
RFK737	BRACKET KIT ; includes two brackets, set screw, lock tab, and hardware for securing brackets to lower spring pan; does one side, TR4	2
106841	Fulcrum Pin and Bracket Assembly , TR4	2
106843	Bracket , TR4	2
RFK738	BRACKET KIT ; includes two brackets, fulcrum bolt, nyloc nut, and hardware for securing brackets to lower spring pan; does one side, TR4A	2
106843	Bracket , TR4A	4

FRONT SUSPENSION



210903



SAH606



213165

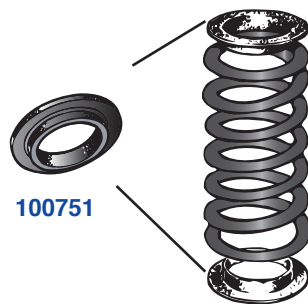

100751

FRONT ROAD SPRINGS, TR4

Part No.	Description	No. Off	Current Prices on Website
210903	Front Road Spring , stock grade, do not use with factory aluminium upper packings	2	
SAH606	Front Road Spring , uprated	2	
100751	Packing , rubber, top and bottom of spring; six required if early short springs and factory aluminium packings are used; four required if later taller springs are used without factory aluminium packings	4 or 6	
100751/U	Packing , urethane, top and bottom of spring; six required if early short springs and factory aluminium packings are used; four required if later taller springs are used without factory aluminium packings	4 or 6	

FRONT ROAD SPRINGS, TR4A

Part No.	Description	No. Off	Current Prices on Website
213165	Front Road Spring , stock grade	2	
SAH606	Front Road Spring , uprated	2	
100751	Packing , rubber	4	
100751/U	Packing , urethane	4	

Please see section on uprated coil spring kits for TR4A kits on page 93.

FRONT SUSPENSION

SPRING COMPRESSOR TOOLS

“Patterned After the Original Spring Compressor Tool Used in Triumph Dealerships”

Part No.	Description	No. Off Current Prices on Website
RFT102	Spring Compressor Tool, TR2, TR3, TR4	1
RFT103	Spring Compressor Tool, TR4A, TR250, TR6	1
RFT104	Spring Compressor Tool, TR2, TR3, TR4, TR4A, TR250, TR6; includes two bottom plates to service all of the models listed	1

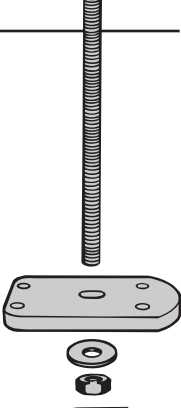

RFT102

REBOUND RUBBERS, TR4 only

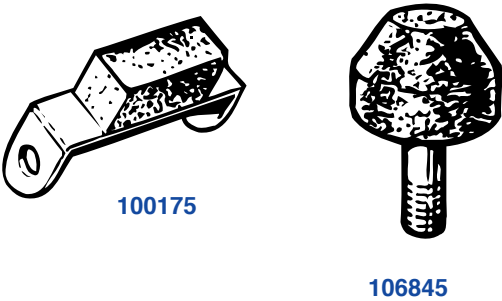

Part No.	Description	No. Off Current Prices on Website
100175	Rebound Rubber Assembly, rectangular; mounted on chassis bracket under front suspension	2
106845	Rebound Rubber Assembly, conical; mounts on lower wishbones	2

FRONT SUSPENSION

FRONT HUBS

“TRF Uses Only Timken Bearings on Hub Rebuilds”

The front hubs listed in this section are rebuilt by C.A.R. Components. Each hub is disassembled and carefully inspected. Hubs are then bead blasted and cleaned, and new Timken bearings and races are installed. You have the choice of ordering rebuilt hubs only, or rebuilt hubs kits which include either stock rotors or EBC slotted and spot-drilled rotors. All hubs and hub kits listed below are sold as single units except hub kits with EBC rotors. In the case of the kits with EBC rotors, there is a left hand and right hand rotor and, therefore, these are supplied in pairs. Call us at 800 234-1104, ext. 3010 to discuss having your hubs rebuilt. C.A.R. Components is currently closed, but we will revise this page when it reopens.

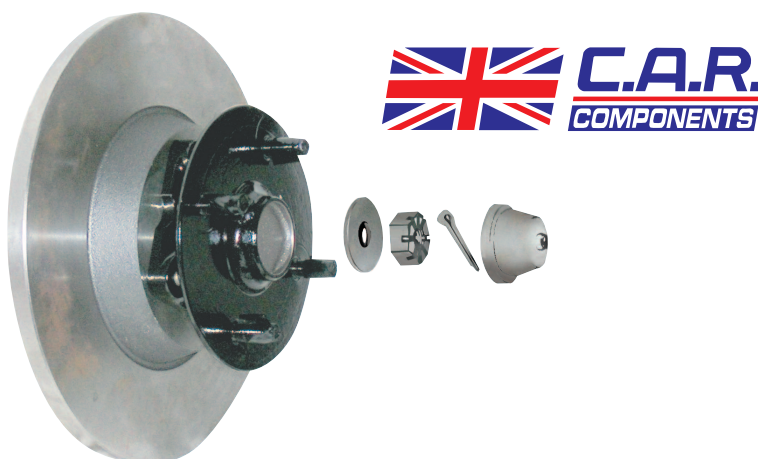

Part No.	Description	No. Off	Current Prices on Website
----------	-------------	---------	---------------------------

REBUILT FRONT HUBS

RHK51/DW	Rebuilt Front Hub , disc wheel studs; not fitted with brake disc, all TR4, TR4A, single	2	
----------	--	---	--

CORE30	Core Charge on the above	2	
--------	--------------------------	---	--

RHK51/WW	Rebuilt Front Hub , wire wheel studs; not fitted with brake disc, all TR4, TR4A, single	2	
----------	--	---	--

CORE30	Core Charge on the above	2	
--------	--------------------------	---	--

REBUILT FRONT HUBS WITH BRAKE

DISCS; early TR4 with 11-inch discs; fitted up to comm. no. CT4387

RHK32/DW	Rebuilt Front Hub Kit , disc wheel studs; fitted with stock brake disc, 11-inch disc, single	2	
----------	--	---	--

CORE30	Core Charge on the above	2	
--------	--------------------------	---	--

RHK32/WW	Rebuilt Front Hub Kit , wire wheel studs; fitted with stock brake disc, 11-inch disc, single	2	
----------	--	---	--

CORE30	Core Charge on the above	2	
--------	--------------------------	---	--

Section Continues On Next Page

FRONT SUSPENSION

FRONT HUBS—Continued

Part No.	Description	No. Off	Current Prices on Website
REBUILT FRONT HUBS WITH BRAKE			
	DISCS—Continued; early TR4 with 11-inch discs; fitted up to comm. no. CT4387		
RHK33/DW	Rebuilt Front Hub Kit , disc wheel studs; fitted with EBC slotted and spot drilled brake discs, 11-inch disc, pair	1	
CORE60	Core Charge on the above	1	
RHK33/WW	Rebuilt Front Hub Kit , wire wheel studs; fitted with EBC slotted and spot drilled brake discs, 11-inch disc, pair	1	
CORE60	Core Charge on the above	1	
REBUILT FRONT HUB WITH BRAKE			
	DISCS; later TR4, TR4A with 10.75-inch brake discs; TR4 after comm. no. CT4387, all TR4A		
RHK52/DW	Rebuilt Front Hub Kit , disc wheel studs; fitted with stock brake disc, 10.75-inch disc, single	2	
CORE30	Core Charge on the above	2	
RHK52/WW	Rebuilt Front Hub , wire wheel studs; fitted with stock brake disc, 10.75-inch disc,	2	
CORE30	Core Charge on the above	2	
RHK53/DW	Rebuilt Front Hub , disc wheel studs; fitted with EBC slotted and spot drilled brake discs, 10.75-inch disc, pair	1	
CORE60	Core Charge on the above	1	
RHK53/WW	Rebuilt Front Hub , wire wheel studs; fitted with EBC slotted and spot drilled brake disc, 10.75-inch disc, pair	1	
CORE60	Core Charge on the above	1	

Call us at

800 234-1104, ext. 3010 to discuss having your hubs rebuilt.

C.A.R. Components is currently closed, but we will revise this page when it reopens.



FRONT SUSPENSION

FRONT WHEEL BEARINGS AND KITS

“Front Wheel Bearing Kits Contain Timken Bearings”

We at TRF became confused a few years ago, because of a large number of no-name bearings on the market, some from third world countries. They came in when we ordered bearings, and we tried them. But we didn't like them, and we decided not to use them in components that we rebuild at C.A.R. Components. That led to another problem—We don't sell parts to our customers that we wouldn't use ourselves. I decided that I couldn't sell bearings that I consider questionable to my customers. Therefore, we assigned new part numbers to certain high-quality bearings, and those are the ones we are offering now. Yes, they are more expensive. The best parts nearly always are. How expensive is it to do the job over? How expensive is a job that doesn't last? Actually, I have been extremely well pleased. We find that we have sold many more kits since we began listing the better bearing kits, and customers tell us they are glad to buy the original brand components...

Kits also include additional components not found in cheaper kits sold elsewhere.

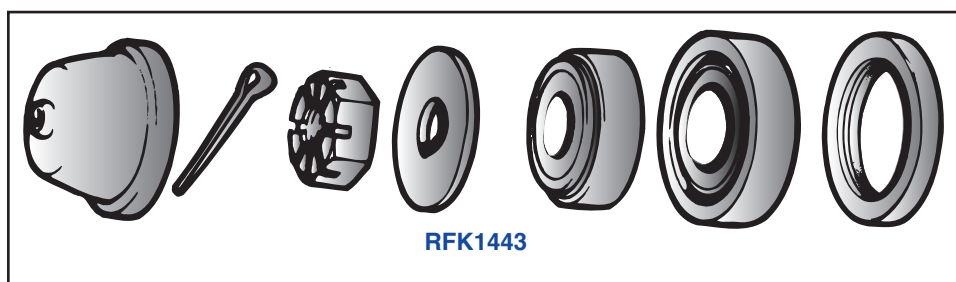

CAWB1

Part No.	Description	No. Off	Current Prices on Website
RFK1443	BEARING KIT , front hub; Timken bearings; all TR4, TR4A	2	
TRFCD239	Bearing , inner, Timken brand	2	
TRFCD240	Bearing , outer, Timken brand	2	
GHS110	Seal , front hub	2	
102690	D-Washer	2	
LN2211	Nut , slotted	2	
PC20	Pin , cotter	2	
102689	Cap , grease	2	
	WHEEL BEARING GREASE ; TRF has always stocked this special Castrol grease		
CAWB1	Castrol Wheel Bearing Grease , 28 oz. resealable tub	A/R	

FRONT SUSPENSION

STRONGER FRONT AXLE KITS SOLVE BRAKING PROBLEMS

“Race Car Solution Makes Your Street Car Stop Better”

The stub axle kits listed here work well to solve a common braking problem. Stock stub axles are a bit flimsy and they flex, causing brake discs to wobble, reducing braking efficiency, particularly on rough surfaces. This will cause caliper pistons to be pushed back too far into the caliper, requiring additional fluid to come back out. The result will be the pedal going to the floor on the first pump. A second pump slows the car. BMC cars used a spacer between the wheel bearings to support the stub axle and to reduce the flexing, thus improving braking and handling, but Triumph didn’t seem to realize there was a problem. Fitting a spacer, particularly along with a beefier stub axle, will solve this problem.

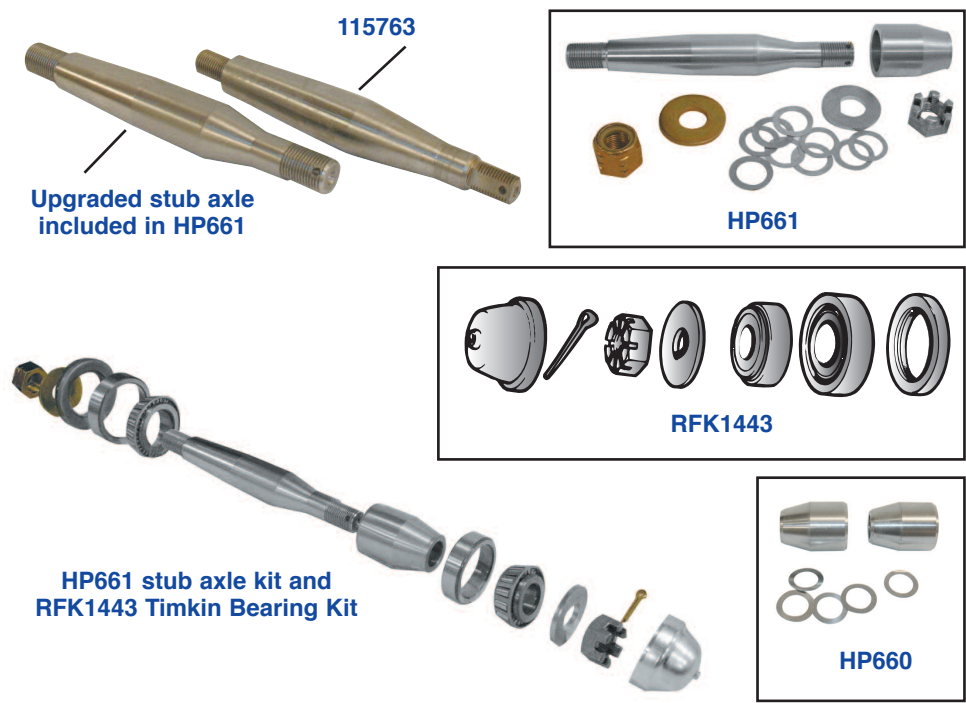

Part No.	Description	No. Off	Current Prices on Website
115763	Stub Axle , stock replacement	2	
FRONT AXLE KITS AND COMPONENTS			
HP661	Stub Axle Kit , uprated; includes one pair of uprated stub axles, spacers, adjusting shims, hardware, and installation instructions; eliminates axle flexing and wobble	1	
HP660	Spacer Kit , front hubs; includes wheel bearing spacers, adjusting shims, and installation instructions	1	
RFK1443	Timken Front Wheel Bearing Kit ; includes Timken wheel bearings, grease seals, D-washers, slotted nuts, and bearing caps	2	

REAR SUSPENSION

TRAILING ARM COMPONENTS, TR4A IRS

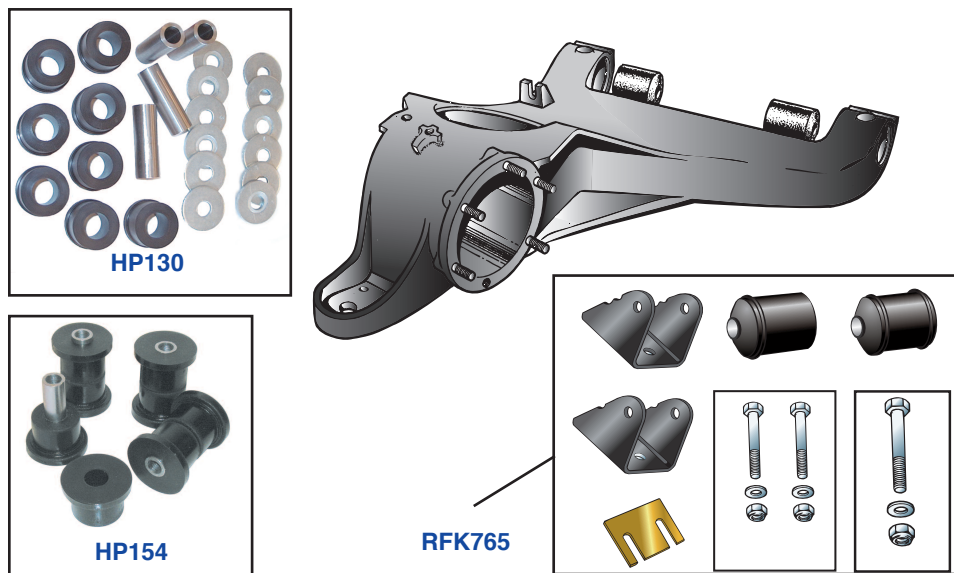

Part No.	Description	No. Off	Current Prices on Website
----------	-------------	---------	---------------------------

TRAILING ARM PIVOT BUSHES,

TR4A IRS

137599	Pivot Bush , rubber, stock grade	4
TRFCD30	Pivot Bush , rubber, heavy duty for improved handling	4
HP154	Pivot Bush Kit , urethane; includes high-performance urethane bushes with steel sleeves	1
HP130	Pivot Bush Kit , nylatron; includes high-performance nylatron bushes, steel sleeves, special shim washers, and full instructions for setting up your rear suspension for minimal deflection under load	1

TRAILING ARM MOUNTING

BRACKET KITS; kits include mounting brackets, bushes, alignment shims, and hardware

RFK223	MOUNTING KIT ; with stock grade rubber bushes	1
RFK765	MOUNTING KIT , with heavy duty rubber bushes	1

TRAILING ARM MOUNTING COMPONENTS

141399	Bracket , mounting, trailing arm, inner, two notch	2
141398	Bracket , mounting, trailing arm, outer, one notch	2
139363	Alignment Shim	A/R

Section Continues On Next Page

REAR SUSPENSION

TRAILING ARM COMPONENTS, TR4A IRS —Continued

Part No.	Description	No. Off	Current Prices on Website
	HARDWARE , securing brackets to chassis frame		
HB926	Bolt	7	
YN2909	Nut , nyloc	8	
	HARDWARE , securing trailing arms to inner and outer brackets		
HB1029	Bolt	4	
WM803	Washer , plain	4	
TN3210	Nut , nyloc	4	

ADJUSTABLE TRAILING ARM MOUNTING BRACKETS, TR4A IRS

“The Idea for These Adjustable Mounting Brackets Comes from the Group 44 TR6 Race Car”

If you’ve been wishing you could adjust rear wheel camber on your TR4A IRS, here is the product that you have been looking for. Beautifully made components are simple in design and easy to install with instructions provided. New pivot bolts and mounting bolts and hardware are included. All parts are plated or powder coated.

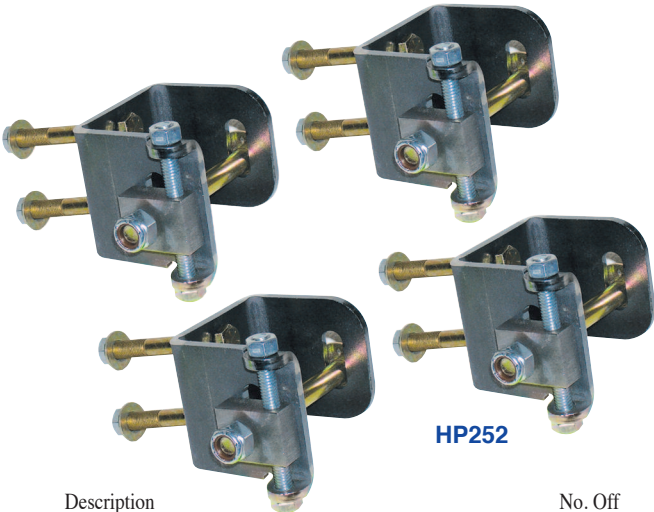

Part No.	Description	No. Off	Current Prices on Website
HP252	Adjustable Mounting Kit , rear suspension trailing arms; allows rear wheel camber adjustment; simple design, instructions included	1	

REAR SUSPENSION

CROSS MEMBER REPAIR COMPONENTS, TR4A



RFK1788



RFK1786

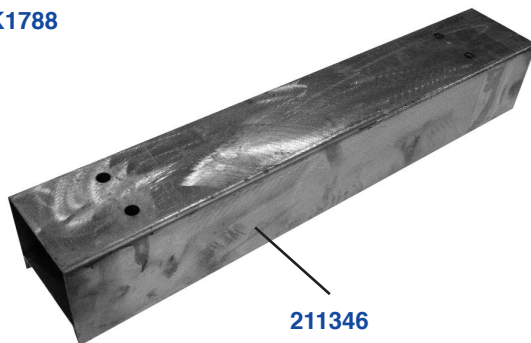

211346

Part No.	Description	No. Off	Current Prices on Website
----------	-------------	---------	---------------------------

CROSSMEMBER REPAIR COMPONENTS,

TR4A IRS

211346	Cross Member Repair Section; this is the section that the trailing arms are secured to on IRS cars, and that the leaf spring front brackets are secured to on solid axle cars	2
RFK1788	FRONT CROSSMEMBER REPAIR KIT; includes differential mounting bolts, brackets on bolts, and reinforcement plates and washers	1
147400	Bolt, differential mounting	2
140009	Bracket, reinforcing bolts	2
SLP118	Plate, reinforcing brackets	4
SLP119	Plate, reinforcing bolts on tops of crossmember	2
RFK1786	REAR CROSSMEMBER REPAIR KIT; includes brackets and bolts	1
147400	Bolt, differential mounting	2
140051	Bracket, reinforcing bolts	2

REAR SUSPENSION

LEAF SPRINGS, TR4, TR4A

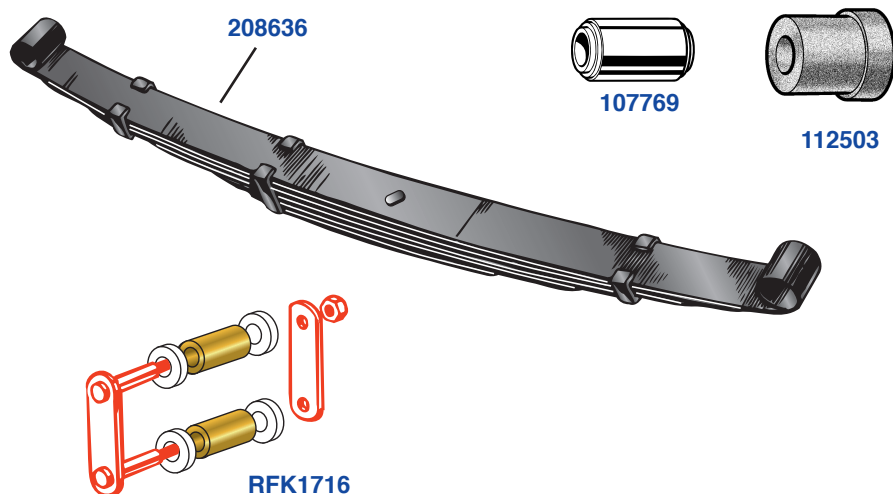

Part No.	Description	No. Off	Current Prices on Website
REAR LEAF SPRINGS, TR4			
208636	Rear Leaf Spring , TR4 up to comm. no. CT23383	2	
113194	U-bolt 4		
209964	Rear Leaf Spring , TR4 after comm. no. CT23383	2	
136865	U-bolt	4	
HARDWARE SECURING LEAF SPRINGS			
YN2909	Nut , nyloc	8	
WP9	Washer , plain	8	
REAR LEAF SPRINGS, TR4A			
212113	Rear Leaf Spring , TR4A solid axle	2	
136865	U-bolt	4	
HARDWARE SECURING LEAF SPRINGS			
YN2909	Nut , nyloc	8	
WP9	Washer , plain	8	
REAR SPRING BUSHES			
107769	Bush , silent-bloc, front spring eyes; included with leaf springs listed above	2	
112503	Bush , rubber, rear spring eyes; not included with leaf springs listed above	8	
112503/U	Bush , urethane, rear spring eyes; not included with leaf springs listed above	8	
RFK1716	Rear Spring Shackle Bush Kit , high-performance; kit includes four bronze bushes and eight Delrin washers to replace stock bushes for improved handling, TR4 only	1	

REAR SUSPENSION

COIL SPRINGS, TR4A IRS

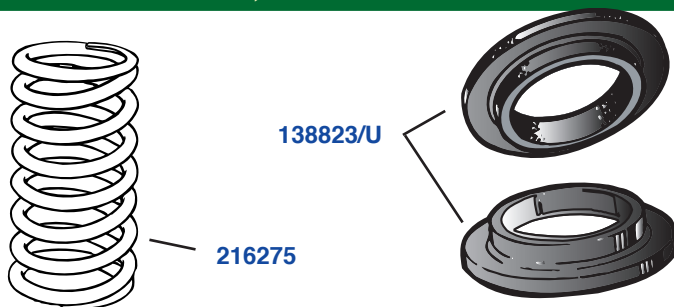

Part No.	Description	No. Off	Current Prices on Website
216275	Rear Road Spring , stock grade	2	
SAH1081/E	Rear Road Spring , high-performance	2	
138823	Packing , rubber, rear road spring	4	
138823/U	Packing , urethane, rear road spring	4	

SHOCK ABSORBERS, TR4

“Your Choice of New or Rebuilt...”



AR7999LH

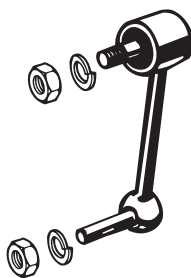

105925



ARSF2

Part No.	Description	No. Off	Current Prices on Website
REAR LEVER SHOCKS AND LINKS, TR4			
AR7999LH	Lever Shock , new, L.H.	1	
202389R	Lever Shock , rebuilt, L.H.	1	
CORE45	Core Charge on the above	1	
AR7999RH	Lever Shock , new R.H.	1	
202388R	Lever Shock , rebuilt, R.H.	1	
CORE45	Core Charge on the above	1	
105925	Link , rear shock	2	
ARSF2	Shock Oil , for refilling lever shocks, 1/2 liter bottle	1	

REAR SUSPENSION

SHOCK ABSORBERS, TR4A

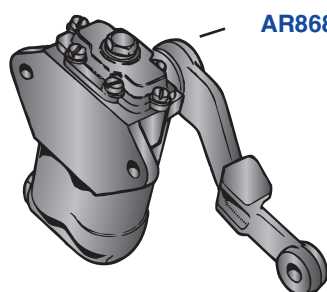

AR8686LH



ARSF2



141464

Part No.	Description	No. Off	Current Prices on Website
----------	-------------	---------	---------------------------

REAR LEVER SHOCKS AND LINKS,

TR4A

AR8686LH	Lever Shock , L.H.	1
211936R	Lever Shock , rebuilt, L.H.	1
CORE45	Core Charge on the above	1
AR8686RH	Lever Shock , R.H.	1
211937R	Lever Shock , rebuilt, R.H.	1
CORE45	Core Charge on the above	1
AR8856LH	Link , rear shock, L.H., solid axle cars	1
AR8856RH	Link , rear shock, R.H., solid axle cars	1
141464	Link , rear shock, TR4A IRS cars	2
141464/U	Link , rear shock, with urethane bushes,	2
	TR4A IRS	
ARSF2	Shock Oil , for refilling lever shocks,	1
	1/2 liter bottle	

REAR SUSPENSION REBOUND RUBBERS

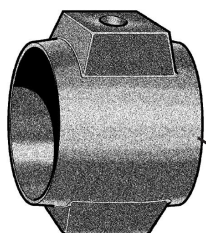

115456



140290

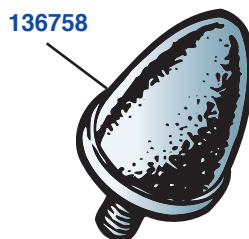

136758

Part No.	Description	No. Off	Current Prices on Website
----------	-------------	---------	---------------------------

RFK767	REBOUND KIT , TR4	1
115456	Rear Axle Buffer	2
140606	Binding Wire , to secure buffers to axle	4
RFK785	REBOUND CONE KIT , TR4A solid axle	1
140290	Bumper Cone , fitted to body	2
136758	Bumper Cone , fitted to axle housing	2
140290	Bumper Cone , fitted to chassis frame	2
RFK786	REBOUND CONE KIT , TR4A IRS	1
140290	Bumper Cone , fitted to body	2
136758	Bumper Cone , fitted to trailing arms	2

REAR SUSPENSION

REAR TUBE SHOCK CONVERSION KITS, TR4A IRS ONLY

Four different rear tube conversion kits are available for TR4A's with independent rear suspension. Many enthusiasts wish to switch to rear tube shocks, as the original lever shocks used on many classic British cars are thought to be antiquated. TRF currently offers two different types of kits with the choice of two different brands of shocks for each. We call these easy-mount type and structural type based on the design of the kits.

Easy-mount kits have a bracket that bolts to the existing shock mount to which the top of the tube shock is attached. The lower portion of the tube shock mounts to the link holes in the trailing arms.

In the structural type, heavy metal brackets are bolted to the chassis and body to which the top of the tube shock is attached. The lower portion of the tube shock mounts to the link holes in the trailing arm.

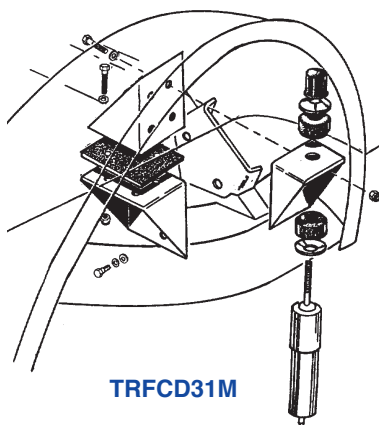

TRFCD31M

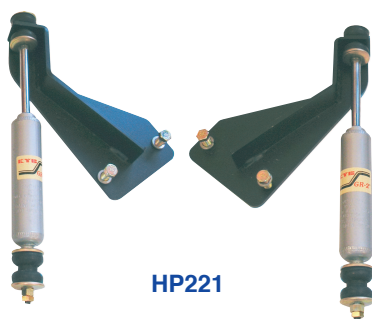

HP221

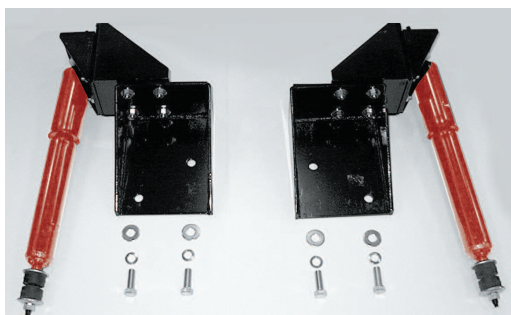

TRFCD31M

Part No.	Description	No. Off	Current Prices on Website
----------	-------------	---------	---------------------------

EASY-MOUNT TUBE SHOCK CONVERSION KITS

HP221	Tube-Shock Conversion; comes with KYB gas shocks and required parts; instructions	1
HP121	Tube-Shock Conversion; comes with SPAX shocks and required parts; instructions	1

STRUCTURAL TUBE SHOCK CONVERSION KITS

TRFCD31M	Tube-Shock Conversion; comes with Monroe shocks and required parts; instructions	1
TRFCD31K	Tube-Shock Conversion; comes with Koni shocks and required parts; instructions	1

REAR SUSPENSION

SWAY BARS

“Famous Addco Sway Bar Kits For Your Triumph”

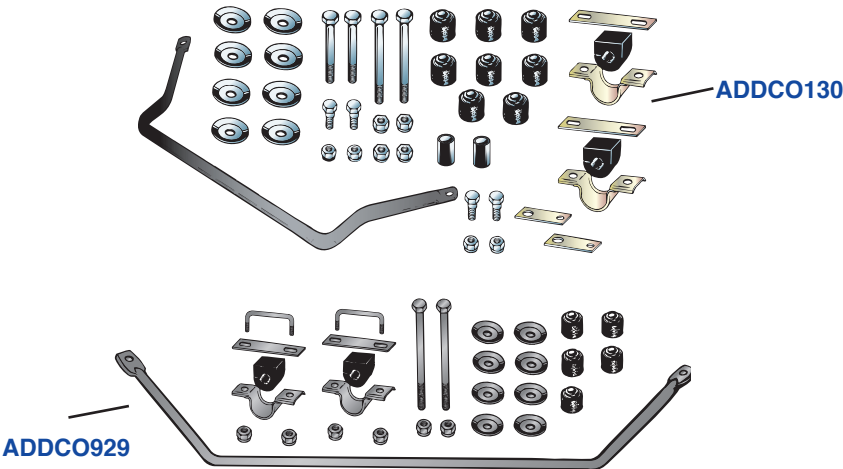

Part No.	Description	No. Off	Current Prices on Website
ADDCO FRONT AND REAR SWAY BAR KITS			
ADDCO130	Front Sway Bar Kit , 3/4-inch bar, TR4	1	
ADDCO128	Front Sway Bar Kit , 3/4-inch bar, TR4A	1	
ADDCO920	Rear Sway Bar Kit , 5/8-inch bar, TR4	1	
ADDCO922	Rear Sway Bar Kit , 5/8-inch bar, TR4A solid axle	1	
ADDCO929	Rear Sway Bar Kit , 3/4-inch bar, TR4A IRS	1	

HANDLING KITS—UPRATED COIL SPRINGS, TR4A IRS

“Up-rated Springs For Better Handling and Less Rear End Squat...”

RFK777/E

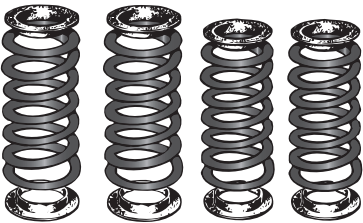

Part No.	Description	No. Off	Current Prices on Website
RFK777/E	TRF HANDLING KIT; high-performance road springs for front and rear of car; includes urethane spring packings	1	
SAH606	Road Spring , front, uprated	2	
SAH1081/E	Road Spring , rear, uprated	2	
100751/U	Packing , urethane, front spring	4	
138823/U	Packing , urethane, rear spring	4	

REAR SUSPENSION

REAL COMPETITION GRADE SPRINGS

LOWER YOUR CAR AND PROVIDE A 20% INCREASE IN SPRING RATE, TR4A IRS ONLY

“High-Performance Urethane Spring Packings Included”

Our spring kit comes with high-performance urethane spring packings and lowers ride height approximately one inch. If you want a stock ride height, you can fit TRF's Handling Kit listed in the previous section, or you can use these springs and adjust the ride height with stackable spacers listed in this section

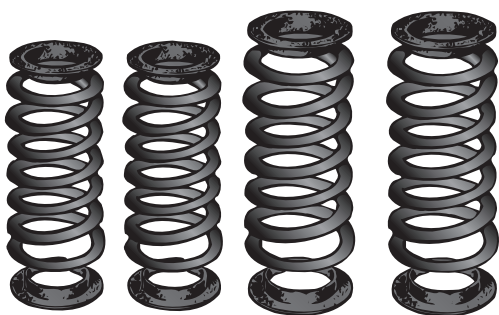

HP132



**HP173
Showing Two
Spacers Stacked**

Part No.	Description	No. Off	Current Prices on Website
HP132	Competition Spring Kit; includes a matched set of front and rear springs, plus a set of high-performance urethane spring packings, TR4A IRS only	1	
	STACKABLE SPRING SPACERS; install these on front springs only to adjust ride height; priced per pair...		
HP173	Spacer Set, 1/2- inch thick; raises ride height approximately 3/4-inch	A/R	
HP174	Spacer Set, 3/4- inch thick; raises ride height approximately 1-inch	A/R	
HP175	Spacer Set, 1-inch thick; raises ride height approximately 1-1/2 inch	A/R	
	STACKABLE SPRING SPACERS; install these on rear springs only to adjust ride height; priced per pair...		
HP133	Spacer Set, 1/2- inch thick; raises ride height approximately 3/4-inch	A/R	
HP134	Spacer Set, 3/4- inch thick; raises ride height approximately 1-inch	A/R	
HP135	Spacer Set, 1-inch thick; raises ride height approximately 1-1/2 inch	A/R	