

IGNITION TUNE-UP COMPONENTS

“Regular maintenance will maintain your Spitfire’s reliability”

COMPLETE IGNITION TUNE-UP KITS

TRF complete tune-up kits include Champion spark plugs, rotor, oil filter, and points and condenser as needed. We recommend that you also consider the purchase of ignition wires, distributor caps, and other tune-up components as listed in following sections.

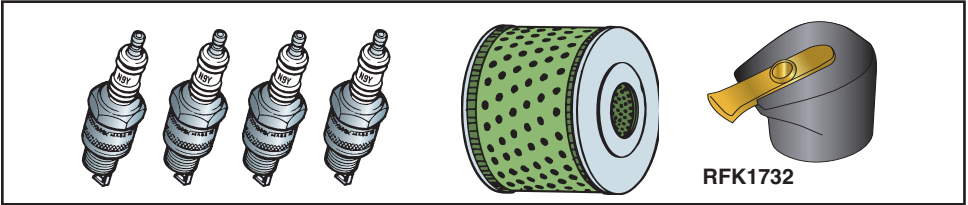

Part No.	Description	No. Off
RFK681	Tune-up Kit , Spitfire mks.1, 2, 1147cc	1
RFK687	Tune-up Kit , Spitfire mks.3, 4, 1296 cc	1
RFK1732	Tune-up Kit , Spitfire 1500, 1973-74	1
RFK1733	Tune-up Kit , Spitfire 1500, 1975-80	1

INDIVIDUAL IGNITION COMPONENTS, All Spitfire mks.1, 2, 3, 4 with Delco points-type distributors

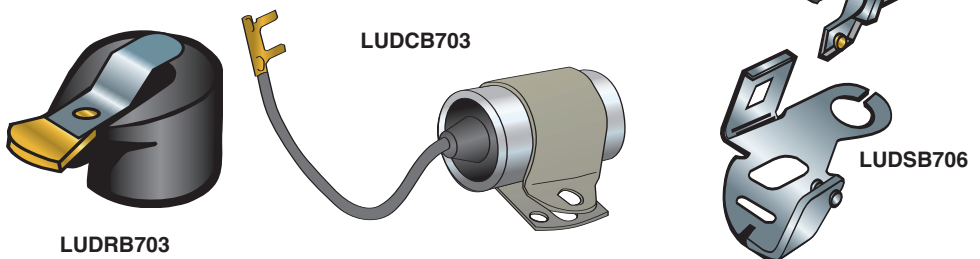

Part No.	Description	No. Off
RFK1335	TUNE KIT , Spitfire 1962-74; includes points, condenser, and rotor	1
LUDSB706	Points Set	1
LUDCB703	Condenser	1
LUDRB703	Rotor Arm	1

INDIVIDUAL IGNITION COMPONENTS, SPITFIRE 1500 with electronic ignition

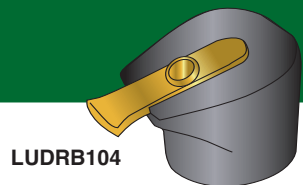

Part No.	Description	No. Off
LUDRB104	Rotor Arm , Spitfire 1500	1

IGNITION TUNE-UP COMPONENTS

SPARK PLUGS

*“Champion or NGK Brand
Plugs Available at TRF”*

CHN9YC



NGKBP6HS



Part No.	Description	No. Off
CHAMPION BRAND SPARK PLUGS		
CHL87YC	Spark Plug , Spitfire mks.1, 2	4
CHN9YC	Spark Plug , Spitfire mks.3, 4	4
CHN12YC	Spark Plug , Spitfire mks.3, 4; hotter plug for cars that are fouling plugs	4
CHN12YC	Spark Plug , Spitfire 1500	4
NGK BRAND SPARK PLUGS		
NGKBP6HS	Spark Plug , Spitfire mks.1, 2	4
NGKBP5ES	Spark Plug , Spitfire mks.3, 4, 1500	4

DISTRIBUTOR CAPS

*“Cracked Caps Rob
Your Car of Power”*

LUDDB108

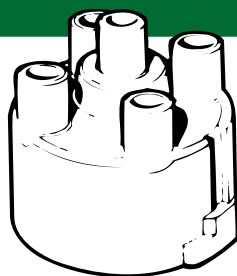

LUDDB703

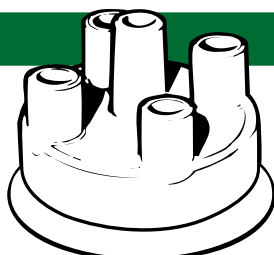

Part No.	Description	No. Off
LUDDB703	Distributor Cap , Lucas brand, Spitfire mks.1, 2, 3, 4	1
IMDDB703	Distributor Cap , after-market brand, Spitfire mks.1, 2, 3, 4	1
LUDDB108	Distributor Cap , Lucas, Spitfire 1500	1
IMDDB108	Distributor Cap , after-market brand, Spitfire 1500	1

IGNITION WIRE SETS

*“Keep Your Spitfire Original with a
Set of Green Ignition Wires”*

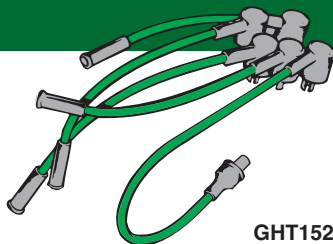

GHT152

Part No.	Description	No. Off
GHT152	Ignition Wire Set , green	1

IGNITION TUNE-UP COMPONENTS

IGNITION COILS—LUCAS BRAND

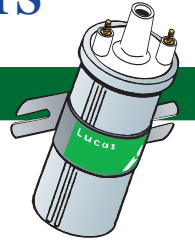

LUDLB102

Part No.	Description	No. Off
LUDLB101	Ignition Coil , Lucas, 1962-70	1
LUDLB102	Ignition Coil , Lucas, 1971-80	1

IGNITION COILS —AFTER MARKET BRAND

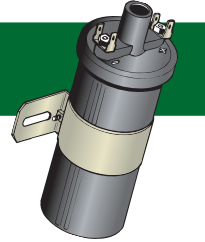

IMDLB101

Part No.	Description	No. Off
IMDLB101	Ignition Coil , after-market, 1962-70	1
IMDLB102	Ignition Coil , after-market, 1971-80	1

IGNITION COILS —FAMOUS LUCAS SPORT COILS

“The Classic Lucas Sport Coil”

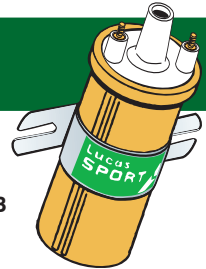

LUDLB105B

Part No.	Description	No. Off
LUDLB105B	Ignition Coil , Lucas Sport Coil, 1962-70	1
LUDLB110	Ignition Coil , Lucas Sport Coil, 1971-80	1

IGNITION COILS—PERTRONIX HIGH-PERFORMANCE COILS

“Hotter Spark for Better Performance”



PTR201

PTR203

Part No.	Description	No. Off
PTR201	Ignition Coil , Pertronix, black case, 1962-70	1
PTR203	Ignition Coil , Pertronix, chromed case, 1962-70	1
PTR202	Ignition Coil , Pertronix, black case, 1971-80	1
PTR204	Ignition Coil , Pertronix, chromed case, 1971-80	1

IGNITION TUNE-UP COMPONENTS

PERTRONIX IGNITOR IGNITION KITS

*“Update performance of your Spitfire with an Ignitor ignition kit.
Easy to install.”*

Fitting a Pertronix Ignitor kit is quick and easy. All components fit under the distributor cap, and you can have the advantage of an electronic ignition in any Spitfire. For later Spitfires that had factory electronic ignition systems, the Pertronix kits are much more reliable.

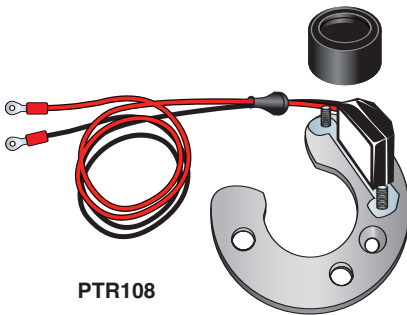

PTR108

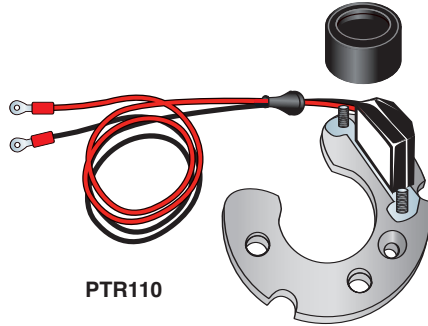

PTR110

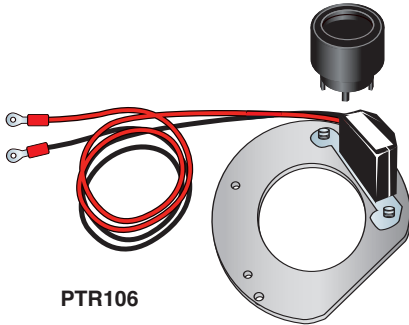

PTR106

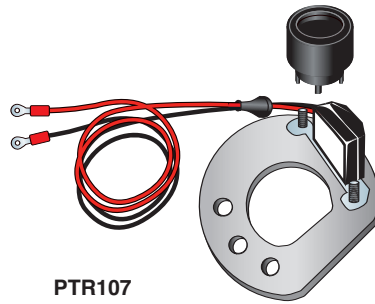

PTR107

Part No.	Description	No. Off
PTR108	Ignition Kit , converts Delco points type distributors to reliable electronic ignition, 1962-67 Spitfire models with positive ground	1
PTR110	Ignition Kit , converts Delco points type distributors to reliable electronic ignition, 1968-74 Spitfire models with negative ground	1
PTR106	Ignition Kit , converts Lucas electronic ignition with amplifier mounted to the distributor, Spitfire 1500 with model 45DE4 distributors, 1975-80	1
PTR107	Ignition Kit , converts Lucas Constant Energy distributors with remote amplifier, Spitfire 1500 with model 45DM4 distributors, 1975-80	1

FILTERS

“Keep Spares on Hand for Weekend Maintenance.”

OIL FILTERS

Always keep a spare or two on hand for weekend oil changes...

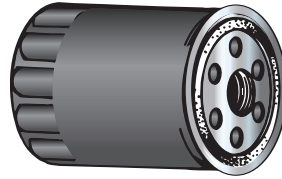

GFE119



GFE121

Part No.	Description	No. Off
GFE121	Oil Filter , Spitfire mks.1, 2, 3, 4, Spitfire 1500, 1962-74	A/R
GFE119	Oil Filter , Spitfire 1500, 1975-80	A/R

AIR FILTERS—STOCK REPLACEMENT FILTERS

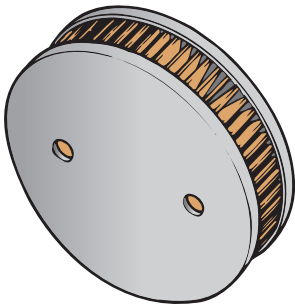

GFE1037

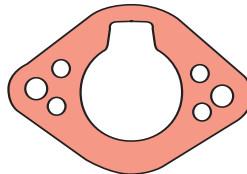

148006

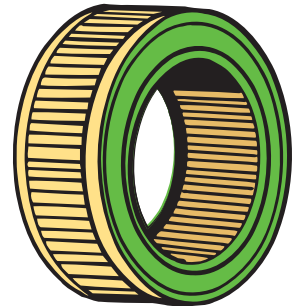

GFE1020



130415



LUF9106

Part No.	Description	No. Off
LUF9106	Air Filter , with breather tube, Spitfire mk.1 up to eng. no. FC50000E	2
GFE1037	Air Filter , with twin carbs, without breather tube mks.1, 2, 3 after eng. no. FC50000E	2
130415	Gasket , air filter to carburettor, dual SU applications, 1962-69	2
GFE1020	Air Filter , with single Zenith Stromberg carb, Spitfire mk.3, 4, 1970-80	1
148006	Gasket , air filter to carburettor, single Zenith Stromberg applications, 1970-80	1

FILTERS

AIR FILTERS—K&N HIGH-PERFORMANCE FILTERS

“The Only Air Filters You Will Need for the Next Million Miles or so.”



TRFCD259

TRFCD10



TRFCD20

Part No.	Description	No. Off
TRFCD259	Air Filter Assembly , replaces original filter housing; chromed housing with washable filter element, Spitfire mks.1-3 with HS2 carbs, 1962-69	2
TRFCD249	Air Filter Assembly , replaces original filter housing; chromed housing with washable filter element, 1970-80 Spitfires with Stromberg carb	1
TRFCD214	Filter Element , K&N brand; fits stock air cleaner housing, Spitfire 1970-80 with single Stromberg carb	1
TRFCD20	Cleaner , for washing K&N filter elements; 32 oz. plastic bottle	A/R
TRFCD10	Filter Oil , for re-oiling K&N filter elements after washing; 6.5 oz. aerosol can	A/R

FUEL FILTER

GFF56

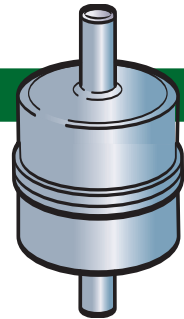

Part No.	Description	No. Off
GFF56	Fuel Filter , AC brand, silver metal filter	1